



Jay Flight SLX



Serial #: 1UJBC0BSXT75R0069
Model: 287BHSW JAY FLIGHT SLX TT

Model Year: 2026 Dealer Name: BIG BOY'S TOYS LTD
1421 EAST ISLAND HIGHWAY
Nanoose Bay, BC V9P 9A3
CAN

Standard Equipment

THE FOLLOWING ITEMS ARE STANDARD ON THIS MODEL

STANDARD EXTERIOR EQUIPMENT
3-amp service
1000 BTU wall mount A/C (single axle models)
13,500 BTU Roof A/C (double axle models)
Wheels with electric, self-adjusting brakes and
7-lube hubs
Exterior cable TV hookup
Fully-integrated A-frame
Anodized-steel, impact resistant wheel wells
Large exterior downspouts
2 quick connect (outside grill prep) [N/A on Sport
ion]
Magnum Truss™ Roof System
Nitrogen filled radial tires
A/C roofing membrane (limited lifetime warranty)

CUSTOMER VALUE PACKAGE
12 cu. ft. 12V refrigerator
Backup camera prep
Rear window skylight
Rear window vent
Detachable power cord
Entry door with window and shade prep
Fitted bed sheet
20 dark tinted privacy windows
Hardy-Alike™ entry and baggage doors
Large folding entry door grab handle
LED interior and exterior light
Marine grade exterior stereo speakers
Microwave oven
On-demand tankless water heater
Power awning with LED lights
Engine hood
Ryde Step Above® entry steps
Tire cover
Stabilizer jacks
Bath/shower surround
Window shades

STANDARD INTERIOR EQUIPMENT
- 300 lb. rated single bunk beds
- 600 lb. rated double bunk beds
- Digital TV antenna
- Heavy-duty, 75 lb., full-extension, steel ball-bearing drawer
guides
- High rise kitchen faucet
- Marine-grade toilet with foot flush
- Plywood bed platforms
- Queen mattress
- Residential-style hidden cabinet door hinges
- Residential-style kitchen countertops
- Shower curtain with curved shower track (select models)
- Solid hardwood cabinet doors with screwed stile
construction and hidden hinges
- Vinyl flooring throughout

Optional Equipment

OPTIONAL EQUIPMENT INSTALLED ON THIS VEHICLE
BY MANUFACTURER

Base price
CSA STANDARDS
CUSTOMER VALUE PACKAGE
OVERLANDER SOLAR PACKAGE
ELITE PACKAGE
13,500 BTU ROOF MOUNTED
A/C
NO 2ND A/C
30 AMP SERVICE
OUTSIDE GRIDDLE
JACK KNIFE SOFA

UNIT TOTAL
DEALER INSTALLED OPTIONS

Manufacturer's Suggested Retail Price

TOTAL AMOUNT DOES NOT INCLUDE STATE AND LOCAL TAXES OR LICENSE FEES. THE PRICE SHOWN ABOVE MAY OR MAY NOT
BE REPRESENTATIVE OF THE ACTUAL SELLING PRICE OF SIMILAR RECREATIONAL VEHICLES IN YOUR AREA.

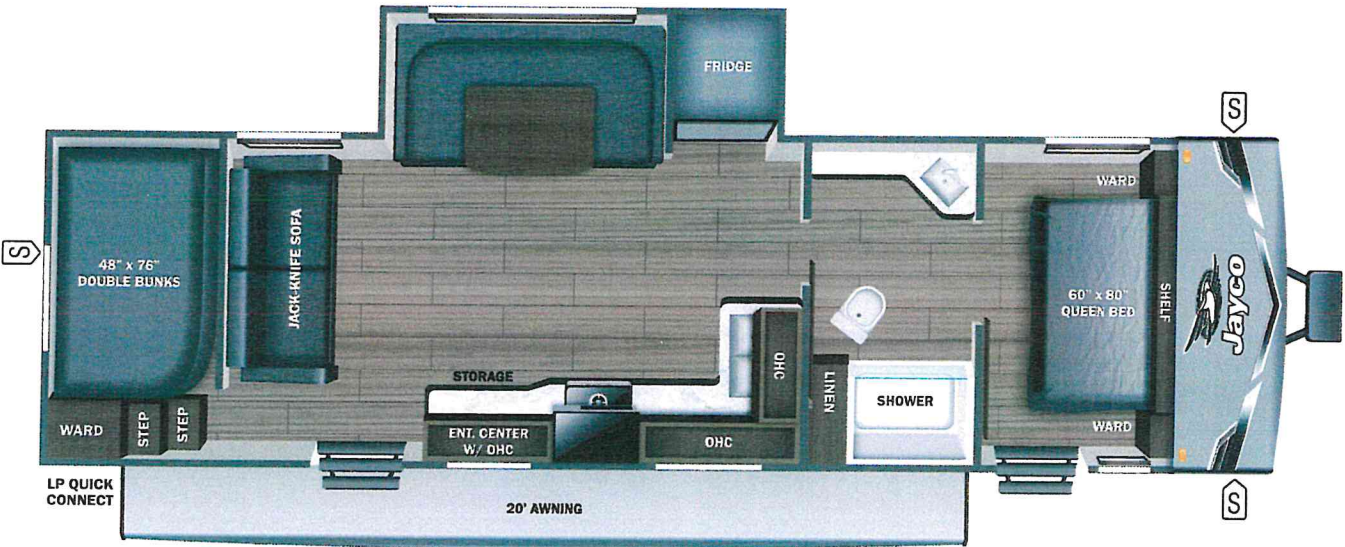

UVW
3214 kgs



Sleeps



Length
34' 3.75"

DIMENSIONS

Exterior height:.....132.00"
Exterior width:.....96.00"

WEIGHTS

GVWR:.....3606
GAWR (front):.....1587
GAWR (rear):.....1587
Approx. Gross Cargo Carrying
Capacity (GCCC):.....391

CAPACITIES

Fresh water tank (gals.):...76.00
Gray water tank (gals.):...39.00
Black water/toilet tank
(gals.):...39.00
Propane (kgs.):.....18
Propane (gals.):.....9
Water heater (gals.):.....0.25

SEATING & SLEEPING

TIRES

Tire size (front):.....ST205/75R14D
Tire size (mid):.....
Tire size (rear):.....ST205/75R14D
Tire size (spare):.....ST205/75R14D

Some dimensions may be rounded and may vary from the actual dimensions
***Weights may be estimated calculations and may vary from the actual weight
- refer to the vehicle weight labels for actual weights***
Floorplans, features and specifications are subject to change without notice.

