



Jay Flight SLX



Serial #: 1UJBC0AK6S7ZF0160
 Model: 197MBW JAY FLIGHT SLX TT

Model Year: 2025 Dealer Name: BIG BOY'S TOYS LTD
 1421 EAST ISLAND HIGHWAY
 Nanoose Bay, BC V9P 9A3
 CAN

Manufacturer's Suggested Retail Price

#5415

TOTAL AMOUNT DOES NOT INCLUDE STATE AND LOCAL TAXES OR LICENSE FEES. THE PRICE SHOWN ABOVE MAY OR MAY NOT BE REPRESENTATIVE OF THE ACTUAL SELLING PRICE OF SIMILAR RECREATIONAL VEHICLES IN YOUR AREA.

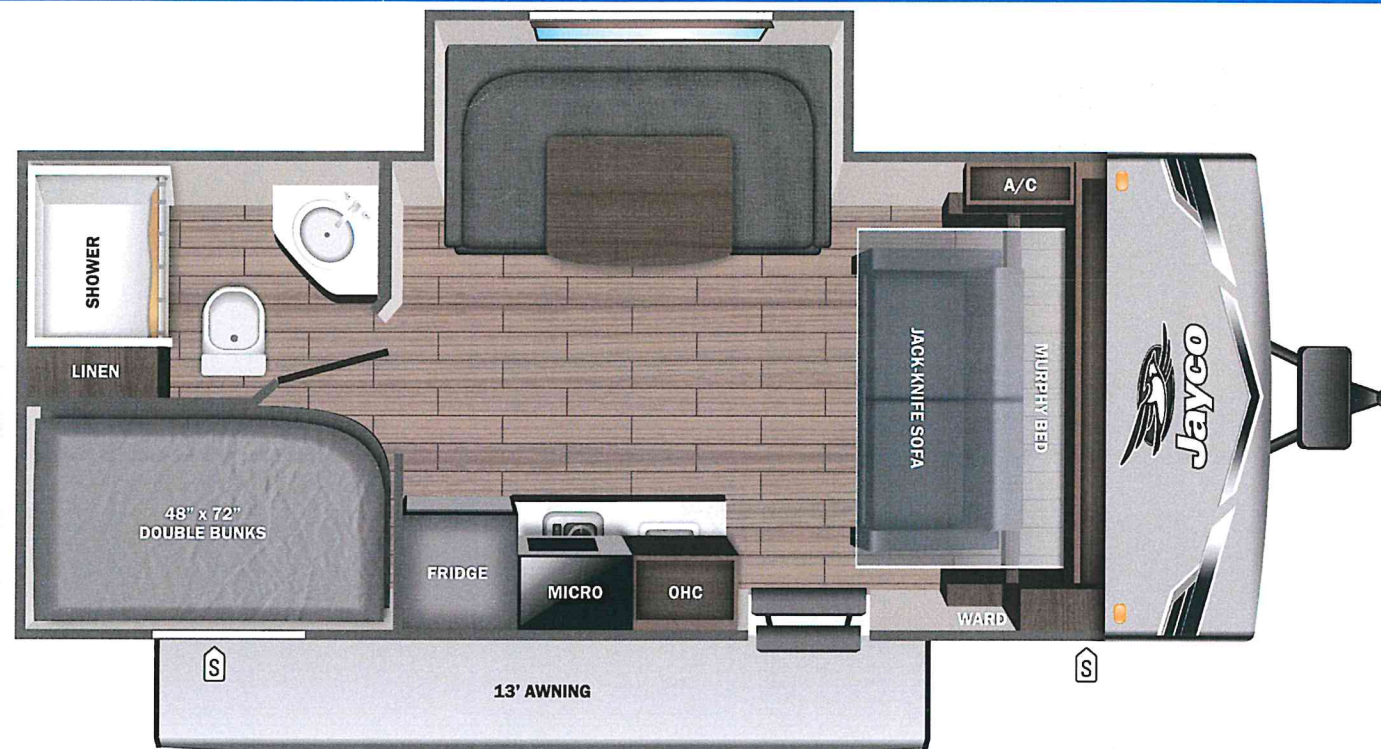

UVW
1996 kgs



Sleeps



Length
23' 5"

DIMENSIONS

Exterior height:.....122.50"

Exterior width:.....96.00"

WEIGHTS

GVWR:.....2336

GAWR (front):.....1995

GAWR (rear):.....0

Approx. Gross Cargo Carrying Capacity(GCCC):.....339

Tire size (front):.....ST225/75R15E

Tire size (mid):.....

Tire size (rear):.....

Tire size (spare):.....ST225/75R15E

CAPACITIES

Fresh water tank (gals.):...30.00

Gray water tank (gals.):...39.00

Black water/toilet tank (gals.):...39.00

Propane (kgs.):.....9

Propane (gals.):.....4

Water heater (gals.):.....0.25

SEATING & SLEEPING

Standard Equipment

THE FOLLOWING ITEMS ARE STANDARD ON THIS MODEL AT NO EXTRA CHARGE

STANDARD EXTERIOR EQUIPMENT

- 30-amp service
- 8,000 BTU wall mount A/C (single axle models)
- Axles with electric, self-adjusting brakes and easy-lube hubs
- Exterior cable TV hookup
- Fully-integrated A-frame
- Galvanized-steel, impact resistant wheel wells
- Large exterior downspouts
- LP quick connect (outside grill prep)
- Magnum Truss™ Roof System
- Nitrogen filled radial tires
- PVC roofing membrane (limited lifetime warranty)

STANDARD INTERIOR EQUIPMENT

- 300 lb. rated single bunk beds
- 600 lb. rated double bunk beds
- Digital TV antenna
- Heavy-duty, 75 lb., full-extension, steel ball-bearing drawer guides
- High rise kitchen faucet
- Marine-grade toilet with foot flush
- Plywood bed platforms
- Queen mattress
- Residential-style hidden cabinet door hinges
- Residential-style kitchen countertops
- Shower curtain with curved shower track (select models)
- Solid hardwood cabinet doors with screwed stile construction and hidden hinges
- Vinyl flooring throughout
- Wood-trimmed mirror in bathroom

CUSTOMER VALUE PACKAGE (MANDATORY)

- 8 cu. ft. 12V refrigerator
- AM/FM/Bluetooth® stereo
- Backup camera prep
- Bathroom skylight
- Bathroom vent
- Detachable power cord
- Entry door with window and shade prep
- Fitted bed sheet
- G20 dark tinted privacy windows
- Keyed-Alike™ entry and baggage doors
- Large folding entry door grab handle
- LED interior and exterior lights
- Marine grade exterior stereo speakers
- Microwave oven
- On-demand tankless water heater
- Power awning with LED lights
- Range hood
- Solid Step® entry steps
- Spare tire with cover
- Stabilizer jacks
- Tub/shower surround
- Window shades

Optional Equipment

OPTIONAL EQUIPMENT INSTALLED ON THIS VEHICLE BY MANUFACTURER

- Base price
- CSA STANDARDS
- CUSTOMER VALUE PACKAGE
- NO BAJA EDITION
- OVERLANDER SOLAR PACKAGE
- 8,000 BTU WALL MOUNT AC
- FIBERGLASS SIDEWALL
- ENCLOSED UNDERBELLY
- STANDARD RADIAL TIRES
- OUTSIDE GRIDDLE

UNIT TOTAL

DEALER INSTALLED OPTIONS

Some dimensions may be rounded and may vary from the actual dimensions
 Weights may be estimated calculations and may vary from the actual weight - refer to the vehicle weight labels for actual weights
 Floorplans, features and specifications are subject to change without notice.

