



Jay Flight



Serial #: 1UJBC0BM6S75G0076
 Model: 225MLSW JAY FLIGHT TT

Model Year: 2025 Dealer Name: BIG BOY'S TOYS LTD
 1421 EAST ISLAND HIGHWAY
 Nanoose Bay, BC V9P 9A3
 CAN

Manufacturer's Suggested Retail Price

TOTAL AMOUNT DOES NOT INCLUDE STATE AND LOCAL TAXES OR LICENSE FEES. THE PRICE SHOWN ABOVE MAY OR MAY NOT BE REPRESENTATIVE OF THE ACTUAL SELLING PRICE OF SIMILAR RECREATIONAL VEHICLES IN YOUR AREA.

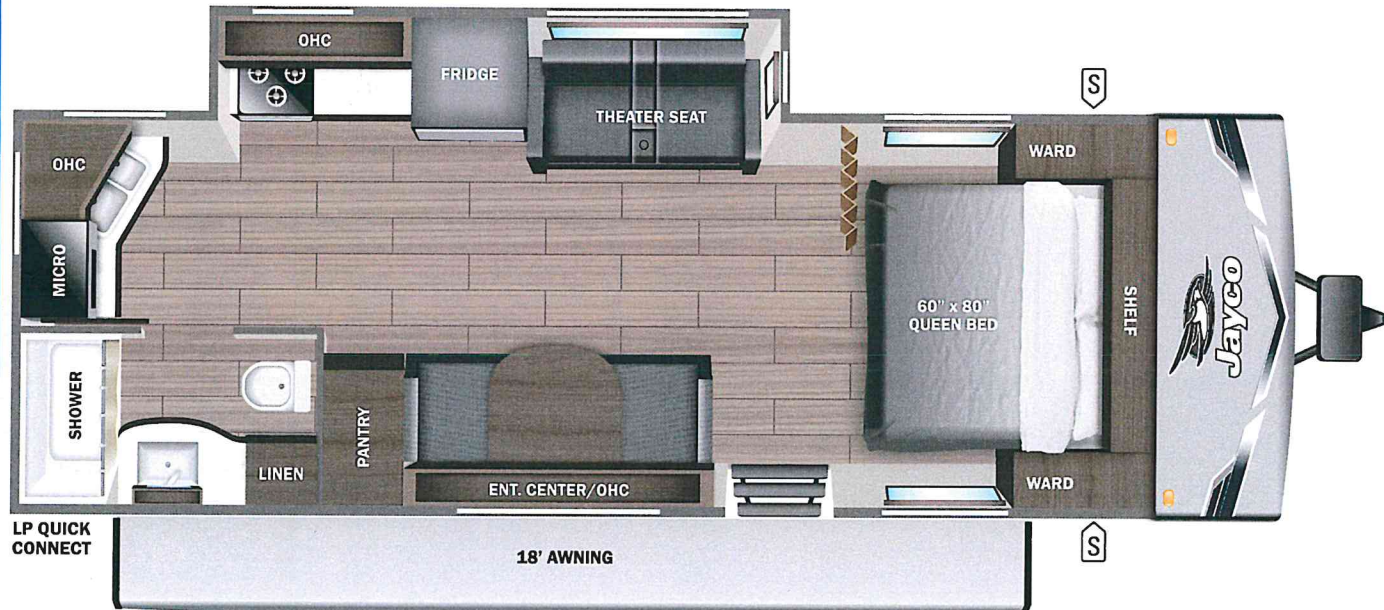

Standard Equipment

Optional Equipment

THE FOLLOWING ITEMS ARE STANDARD ON THIS MODEL AT NO EXTRA CHARGE

OPTIONAL EQUIPMENT INSTALLED ON THIS VEHICLE BY MANUFACTURER

STANDARD EXTERIOR EQUIPMENT

- 20 lb. LP bottles with cover (2)
- 30-amp service
- 5/8 in. tongue-and-groove plywood floor decking
- Axles with electric, self-adjusting brakes and easy-lube hubs
- Enclosed and heated underbelly
- Exterior TV mount and bracket
- Front diamond plate
- Fully integrated A-frame
- Galvanized steel, impact-resistant wheel wells
- I-Class™ cambered structural steel I-beams
- Large exterior downspouts
- LP quick connect (outside gas grill prep)
- Magnum Truss™ Roof system with plywood decking
- PVC roofing membrane (limited lifetime warranty)

STANDARD INTERIOR EQUIPMENT

- 11 cu. ft. 12V refrigerator
- 300 lb. rated bunk beds (select models)
- 4 in. thick bunk mats (select models)
- 600 lb. rated bunk beds (double bunks)
- 81 in. ceiling height
- Heavy-duty, 75 lb., full-extension, steel ball-bearing drawer guides
- J-Steel™ jack-knife sofa with armrest and cup holders (most models)
- Main bed struts
- Plywood bed platforms
- Privacy curtains in bunk areas (select models)
- Queen mattress
- Residential-style hidden cabinet door hinges
- Residential-style kitchen countertops
- Shower curtain with curved shower track (select models)
- Shower/tub surround
- Solid hardwood cabinet doors
- USB charging stations
- Vented bunk windows (select models)
- Vinyl flooring throughout (including slide floors)
- Window shades
- Wooden bedroom doors (select models)

CUSTOMER VALUE PACKAGE (MANDATORY)

- 13,500 BTU A/C
- AM/FM/Bluetooth® stereo
- Backup and side view camera prep
- Bathroom medicine cabinet
- Bathroom power vent
- Bathroom skylight
- Black tank flush
- Detachable power cord
- Fitted bed sheet
- Friction hinge entry door with window and shade prep
- G20 dark tinted privacy windows
- Goodyear® Endurance® tires (made in the USA)
- Inverter pre-wire
- Keyed-Alike™ entry and baggage doors
- Large main entry door grab handle
- LED exterior and interior lights
- Marine grade exterior speakers
- Microwave oven
- On-demand tankless water heater
- One-piece front fiberglass exterior wall
- Outside shower
- Oven with 3-burner recessed cooktop with glass cover
- Overlander 1 Solar Package: (1) 200W solar panel and 30-amp digital controller
- Power awning with LED lights
- Power tongue jack
- Range hood
- Rock-Solid Stabilizer System
- Seamless kitchen countertops
- Sink cover
- Solid Step® entry steps
- Spare tire with cover

Base price
 CSA STANDARDS
 CUSTOMER VALUE PACKAGE
 NO BAJA EDITION
 13,500 BTU AC
 32" LED SMART TV
 FIBERGLASS SIDEWALL
 BLACK SPOKE RIMS
 30# LP GAS BOTTLES
 OUTSIDE GRIDDLE

UNIT TOTAL

DEALER INSTALLED OPTIONS



UVW
2910 kgs



Sleeps



Length
27' 0.75"

DIMENSIONS

Exterior height:.....132.50"

Exterior width:.....96.00"

WEIGHTS

GVWR:.....3172

GAWR (front):.....1587

GAWR (rear):.....1587

Approx. Gross Cargo Carrying

Capacity (GCCC):.....262

TIRES

Tire size (front):.....ST205/75R14D

Tire size (mid):.....

Tire size (rear):.....ST205/75R14D

Tire size (spare):.....ST205/75R14D

CAPACITIES

Fresh water tank (gals.):...76.00

Gray water tank (gals.):...40.00

Black water/toilet tank (gals.):...40.00

Propane (kgs.):.....27

Propane (gals.):.....14

Water heater (gals.):.....0.25

SEATING & SLEEPING

Some dimensions may be rounded and may vary from the actual dimensions

***Weights may be estimated calculations and may vary from the actual weight

- refer to the vehicle weight labels for actual weights***

Floorplans, features and specifications are subject to change without notice.

