

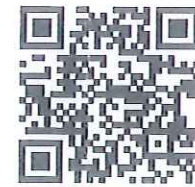

Jay Flight SLX



Serial #: 1UJBC0AJ3P77E0064
 Model: 183RB JAY FLIGHT SLX TT

Model Year: 2023 Dealer Name: BIG BOY'S TOYS LTD
 1421 EAST ISLAND HIGHWAY
 Nanoose Bay, BC V9P 9A3
 CAN

Standard Equipment

Optional Equipment

THE FOLLOWING ITEMS ARE STANDARD ON THIS MODEL AT NO EXTRA CHARGE

OPTIONAL EQUIPMENT INSTALLED ON THIS VEHICLE BY MANUFACTURER

- EXTERIOR**
- Axles with electric, self-adjusting brakes and E-Z Lube® hubs
 - Fully-integrated A-frame
 - Galvanized-steel, impact resistant wheel wells
 - Magnum Truss™ Roof System
 - Seamless one piece roof material
 - Large exterior downspouts
 - 30-amp service
 - 20 lb. propane bottle
 - Exterior cable TV hookup
 - LED exterior lighting
 - Friction hinge entry door with window
 - G20 dark tinted safety-glass privacy windows
 - Rooftop solar prep
 - Backup & side marker camera prep
 - Detachable power cord
 - LP quick connect (outside grill prep)

- INTERIOR**
- Solid hardwood cabinet doors
 - LED interior lighting
 - Vinyl flooring throughout
 - Premium multimedia sound system with MP3/iPod input jacks and Bluetooth® connectivity
 - Digital TV antenna
 - Residential-style kitchen countertops
 - High rise kitchen faucet
 - Heavy-duty, 75 lb., full-extension, steel ball-bearing drawer guides
 - Plywood bed platforms
 - Queen mattress (select models)
 - 300 lb. rated bunk beds (select models)
 - 4 in. thick bunk mats (select models)
 - Marine-grade toilet with foot flush
 - Shower curtain with curved shower track (select models)
 - Wood-trimmed mirror in bathroom

- STX EDITION (Indiana built units only)**
- 30 lb. LP bottle
 - Large fresh water tank (30 gal.)
 - Wide-stance axle
 - Goodyear® off-road tires
 - Enclosed underbelly
 - Double entry step
 - Stabilizer jacks (4)
 - Aluminum rims
 - Power tongue jack
 - Deluxe graphics package
 - Powder coated wheel fenders

- CUSTOMER VALUE PACKAGE (MANDATORY)**
- Goodyear® Endurance® tires (made in the USA)
 - Solid Step® entry steps
 - 13,500 BTU roof mounted A/C
 - 6 gal. gas/ electric DSI water heater
 - Water heater bypass
 - Front diamond plate
 - Power awning with LED lights
 - Marine grade exterior stereo speakers
 - Stabilizer jacks with sand pads (2)
 - Spare tire with cover
 - Keyed-Alike™ entry and baggage doors
 - Large folding entry door grab handle
 - Window shades
 - Range hood
 - 2-burner range with cover
 - 7 cu. ft. gas/electric refrigerator with temperature controls (N/A Indiana built 154BH)
 - 3 cu. ft. refrigerator (154BH) (Indiana built units only)
 - Microwave oven
 - Fitted bed sheet (N/A 154BH)
 - Bathroom skylight
 - Tub/shower surround

- BAJA PACKAGE (Optional - Idaho Only)**
- 30 lb. LP bottle
 - Large fresh water tank (30 gal.)
 - Flipped axle
 - Goodyear® off-road tires
 - Enclosed underbelly
 - Double entry step
 - Stabilizer jacks (4)
 - Deluxe graphics package

Base price
 CSA Standards
 Customer Value Package
 Baja Edition
 Metal Sidewall
 Dinette

UNIT TOTAL

DEALER INSTALLED OPTIONS

Manufacturer's Suggested Retail Price

TOTAL AMOUNT DOES NOT INCLUDE STATE AND LOCAL TAXES OR LICENSE FEES. THE PRICE SHOWN ABOVE MAY OR MAY NOT BE REPRESENTATIVE OF THE ACTUAL SELLING PRICE OF SIMILAR RECREATIONAL VEHICLES IN YOUR AREA.

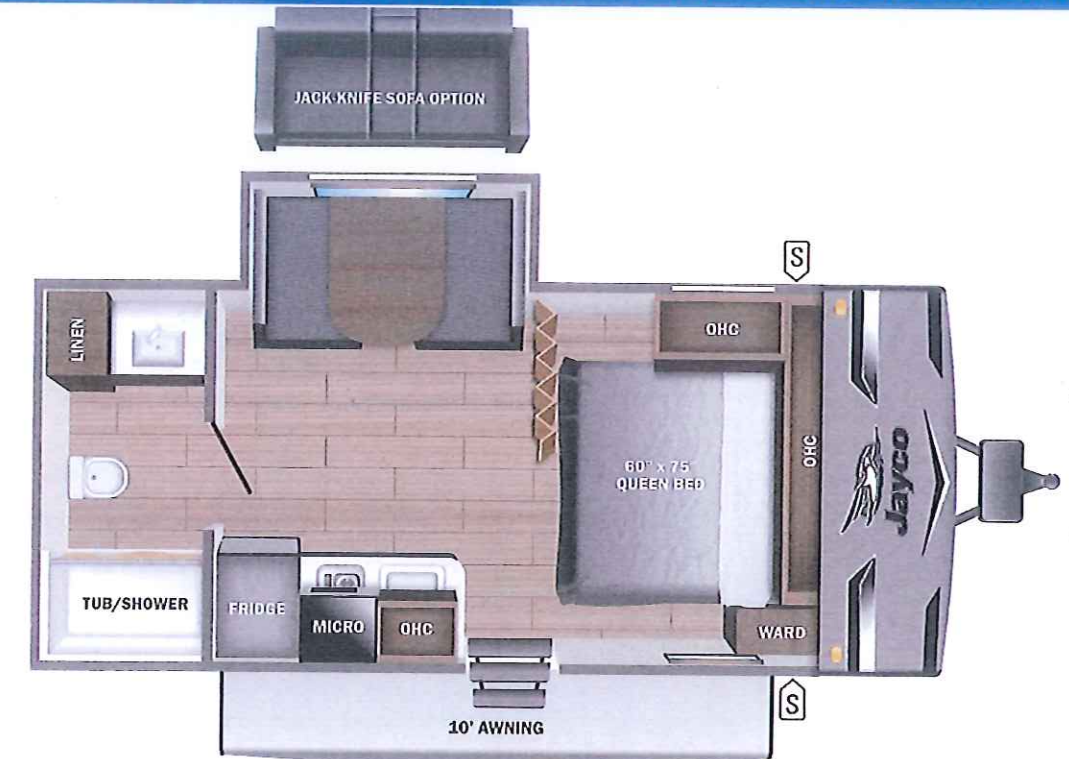

lb UVW
 1719 kgs

Sleeps

Length
 21' 1.38"

DIMENSIONS

Exterior height:.....126.25"

Exterior width:.....85.25"

WEIGHTS

GVWR:.....1973

GAWR (front):.....1995

GAWR (rear):.....0

Approx. Gross Cargo Carrying Capacity (GCCC):.....254

TIRES

Tire size (front):.....LT225/75R16E

Tire size (mid):.....

Tire size (rear):.....

Tire size (spare):.....LT225/75R16E

CAPACITIES

Fresh water tank (gals.):...30.00

Gray water tank (gals.):...19.90

Black water/toilet tank (gals.):...19.90

Propane (kgs.):.....4

Propane (gals.):.....2

Water heater (gals.):.....6.00

SEATING & SLEEPING

Some dimensions may be rounded and may vary from the actual dimensions

***Weights may be estimated calculations and may vary from the actual weight

- refer to the vehicle weight labels for actual weights***

Floorplans, features and specifications are subject to change without notice.

