



Range Lite



Serial #: 58TBM0BN9P3ED3079
 Model: 241BH RANGE LITE TT

Model Year: 2023 Dealer Name: BIG BOY'S TOYS LTD
 1421 EAST ISLAND HIGHWAY
 Nanoose Bay, BC V9P 9A3
 CAN

Manufacturer's Suggested Retail Price

TOTAL AMOUNT DOES NOT INCLUDE STATE AND LOCAL TAXES OR LICENSE FEES. THE PRICE SHOWN ABOVE MAY OR MAY NOT BE REPRESENTATIVE OF THE ACTUAL SELLING PRICE OF SIMILAR RECREATIONAL VEHICLES IN YOUR AREA.

Standard Equipment

Optional Equipment

THE FOLLOWING ITEMS ARE STANDARD ON THIS MODEL AT NO EXTRA CHARGE

OPTIONAL EQUIPMENT INSTALLED ON THIS VEHICLE BY MANUFACTURER

- EXTERIOR**
- 5/8" main floor decking
 - Door side spray port
 - Exterior grill/griddle quick connect port
 - Flexible LP lines
 - Foldable grab handle
 - Fully-walkable roof
 - In-frame battery rack
 - Magnetic baggage door catches
 - Oversized pass-through storage with motion lighting
 - PVC roofing membrane (limited lifetime warranty)
 - Rain gutters with molded drip spouts
 - Rear observation camera prep
 - Safety bumper with drain hose carrier and end caps
 - Self-adjusting electric brakes
 - Side camera prep marker lights
 - Solid swing-down entry steps
 - Thermal Seal- enclosed, insulated and heated underbelly with fully insulated roof with a PVC roofing membrane
 - Tinted safety-glass windows throughout
 - TuffShell™ - vacuum bonded laminated construction, reinforced with heavy-duty fiberglass and welded aluminum frames

- INTERIOR**
- 60" x 80" residential queen bed with storage drawers below
 - 75 lb. ball bearing drawer guides
 - 81" interior height
 - Cable and satellite prep
 - Electrical outlets and USB ports in master bedroom
 - Flush floor slides with residential vinyl flooring
 - Hardwood cabinet doors
 - Kitchen sink covers
 - Laundry chute in bedroom
 - LED interior lighting
 - Medicine cabinet
 - Powered 12V bathroom vent
 - Range hood
 - Residential high-rise faucet with pull-down sprayer
 - Roller blackout night shades
 - Soft closing foot flush toilet
 - Stainless steel single basin under-mount kitchen sink
 - Tri-fold sofa (select models)

- CUSTOMER CONVENIENCE PACKAGE (Mandatory)**
- 15,000 BTU roof mounted A/C
 - 2-30 lb. LP bottles
 - 3-burner range with 17" oven and flush mount glass cover
 - 8 cu. ft. gas/electric refrigerator
 - Dome style digital TV antenna with Wi-Fi prep
 - Enclosed exterior docking station with black tank flush
 - Entrance door with screen door, window and magnet door catch
 - EZ-store detachable cord
 - Gas/electric water heater
 - JBL® Aura Cube stereo with Bluetooth® and mIZONE™ technology
 - JBL® Premium indoor and outdoor multizone speakers
 - Microwave
 - Molded front cap with LED lighting and stoneguard protection
 - Nitrogen filled radial tires with aluminum rims
 - Pop up wireless and USB charger in bedroom
 - Power awning with LED lighting
 - Power tongue jack
 - Pressed membrane countertops
 - Rear roof access ladder
 - Smart HDTV

- Base price
- CSA Standards
- Customer Convenience Package
- Xtend Solar I Package
- 8 Cu. Ft. Refrigerator
- Manual Stab Jacks
- Dinette

UNIT TOTAL
 DEALER INSTALLED OPTIONS

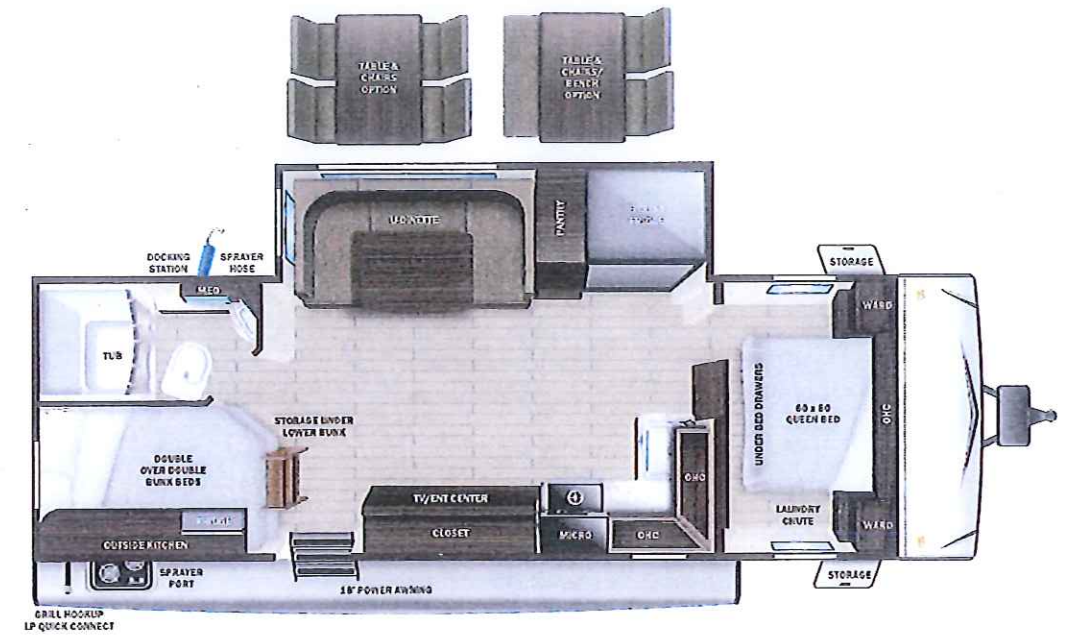

UVW 2786 kgs **Sleeps** **Length** 29' 7.63"

DIMENSIONS	CAPACITIES
Exterior height:.....132.88"	Fresh water tank (gals.):...45.00
Exterior width:.....96.88"	Gray water tank (gals.):...58.00
WEIGHTS	Black water/toilet tank (gals):.....29.00
GVWR:.....3356	Propane (kgs.):.....27
GAWR (front):.....1587	Propane (gals.):.....14
GAWR (rear):.....1587	Water heater (gals.):.....6.00
Approx. Gross Cargo Carrying Capacity (GCCC):.....570	SEATING & SLEEPING
TIRES	
Tire size (front):.....ST205/75R14D	
Tire size (mid):.....	
Tire size (rear):.....ST205/75R14D	

Some dimensions may be rounded and may vary from the actual dimensions
 Weights may be estimated calculations and may vary from the actual weight - refer to the vehicle weight labels for actual weights
 Floorplans, features and specifications are subject to change without notice.

