



# Open Range Roamer



Serial #: 58TCM0BU0P3JC3055  
 Model: 354MBH OPEN RANGE ROAMER FW

Model Year: 2023 Dealer Name: BIG BOY'S TOYS LTD  
 1421 EAST ISLAND HIGHWAY  
 Nanoose Bay, BC V9P 9A3  
 CAN

## Manufacturer's Suggested Retail Price

TOTAL AMOUNT DOES NOT INCLUDE STATE AND LOCAL TAXES OR LICENSE FEES. THE PRICE SHOWN ABOVE MAY OR MAY NOT BE REPRESENTATIVE OF THE ACTUAL SELLING PRICE OF SIMILAR RECREATIONAL VEHICLES IN YOUR AREA.

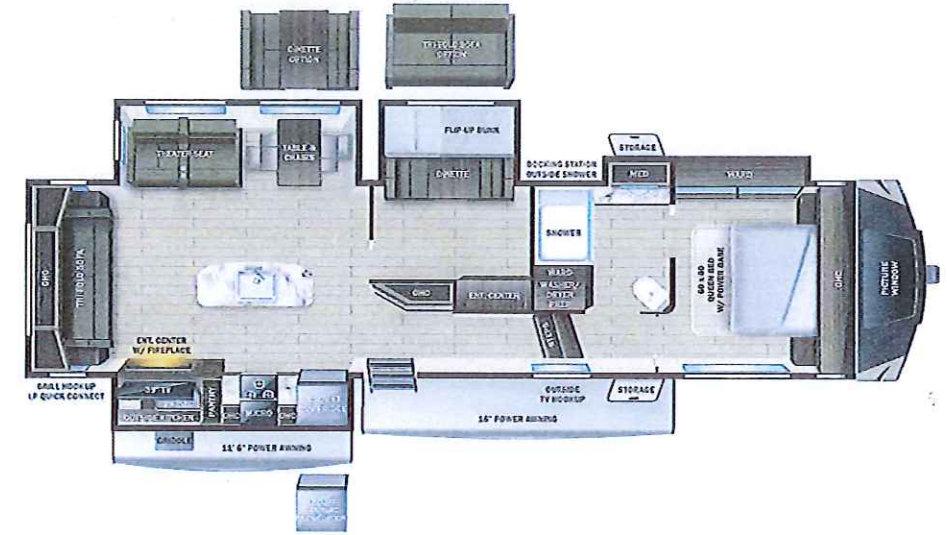

### Standard Equipment

THE FOLLOWING ITEMS ARE STANDARD ON THIS MODEL AT NO EXTRA CHARGE

- EXTERIOR**
- 100" wide body frame
  - 2" receiver hitch
  - 3-20 lb. LP bottles
  - 50 amp service
  - ACCU-SLIDE™ slide system (42" deep 4-corner compression)
  - Battery disconnect switch
  - Brass hanger bushings with wet bolts
  - Equa-Flex® axle suspension
  - Exterior grill/griddle quick connect port
  - Laminated block foam floor
  - PVC roofing membrane (limited lifetime warranty)
  - Rear roof access ladder
  - Self-adjusting electric brakes
  - Spare tire
  - TuffShell™ -vacuum bonded laminated construction, reinforced with heavy-duty fiberglass and welded aluminum frames

- FOUR SEASON PACKAGE**
- Double insulated baggage doors
  - Ducted heat to underbelly with cold air return
  - Enclosed cable operated gate valves
  - Enclosed exterior docking station with black tank flush
  - Heated and enclosed underbelly
  - High performance furnace
  - R-38 reflective foil insulation in ceiling and underbelly
  - R-9 block foam insulation in sidewalls

- INTERIOR**
- 15 cu. ft. 12V refrigerator
  - 60" x 80" residential queen bed with adjustable power base
  - 75 lb. ball bearing drawer guides
  - Cable and satellite prep
  - Flush floor slides with residential vinyl flooring
  - Large oven and 3-burner range with flush mount glass cover
  - LED interior lighting
  - Observation camera prep
  - Residential microwave
  - Roller blackout night shades
  - Theater seating with heat and massage
  - Wall controlled power vent (kitchen/living room area)
  - Washer/dryer prep

- EXECUTIVE PACKAGE**
- 15,000 BTU A/C roof mounted A/C
  - AM/FM/HDMI/USB/AUX Bluetooth® sound bar stereo with outdoor zoned speakers
  - Cutting board and sink strainer
  - Dome style digital TV antenna with Wi-Fi prep
  - Interior convenience center light
  - JBL® Aura Cube stereo with Bluetooth® and miZONE™ technology
  - JBL® Premium indoor and outdoor multizone speakers
  - Keyed-Alike® entry and baggage doors
  - LED HDTV
  - Marine grade exterior speakers (2)
  - Painted fiberglass front cap with LED lighting and automotive tinted window
  - Power awning with LED lighting
  - Quick recovery gas/electric water heater
  - Quick release fresh water drain
  - Residential high-rise faucet with pull-down sprayer
  - Single basin stainless steel under-mount kitchen sink
  - Solar prep
  - Solid swing-down entry steps
  - Solid-surface kitchen countertops
  - Stainless steel appliances
  - TravelLINK® - Smart RV system that allows for Bluetooth® control of awnings, lighting, slides, heating, cooling and more
  - USB/12V charging port

### Optional Equipment

OPTIONAL EQUIPMENT INSTALLED ON THIS VEHICLE BY MANUFACTURER

- Base price
- CSA Standards
- Executive Package
- Four Seasons Protection Package
- RVIA
- 13,500 BTU AC Ducted
- 12 Cu. Ft. Gas/Electric Refrigerator
- Generator Prep - LP
- 32" Bedroom TV
- Frameless Dual Pane Windows
- Slideout Awning Covers
- Power Fan Vent Wall Control (Bathroom)
- BBQ Grill
- 4 Point Auto Level with JT Strong Arms
- Theater Seats with Table&Chairs
- Dinette Bunk Room
- 2 Additional Dinette Folding Chairs

UNIT TOTAL

DEALER INSTALLED OPTIONS

**Uvw**  
5730 kgs



**Sleeps**



**Length**  
39' 2.25"

#### DIMENSIONS

Exterior height:.....158.38"

Exterior width:.....100.00"

#### WEIGHTS

GVWR:.....6123

GAWR (front):.....2721

GAWR (rear):.....2721

Approx. Gross Cargo Carrying Capacity (GCCC):.....392

#### TIRES

Tire size (front):.....ST235/80R16E

Tire size (mid):.....

Tire size (rear):.....ST235/80R16E

#### CAPACITIES

Fresh water tank (gals.):...75.00

Gray water tank (gals.):...97.00

Black water/toilet tank (gals.):.....40.00

Propane (kgs.):.....27

Propane (gals.):.....14

Water heater (gals.):.....6.00

#### SEATING & SLEEPING

\*\*\*Some dimensions may be rounded and may vary from the actual dimensions\*\*\*

\*\*\*Weights may be estimated calculations and may vary from the actual weight

- refer to the vehicle weight labels for actual weights\*\*\*

Floorplans, features and specifications are subject to change without notice.

