



# Jay Feather



Serial #: 1UJBB0BP0P1JS0091  
 Model: 24BH JAY FEATHER TT

Model Year: 2023 Dealer Name: BIG BOY'S TOYS LTD  
 1421 EAST ISLAND HIGHWAY  
 Nanoose Bay, BC V9P 9A3  
 CAN

## Manufacturer's Suggested Retail Price

TOTAL AMOUNT DOES NOT INCLUDE STATE AND LOCAL TAXES OR LICENSE FEES. THE PRICE SHOWN ABOVE MAY OR MAY NOT BE REPRESENTATIVE OF THE ACTUAL SELLING PRICE OF SIMILAR RECREATIONAL VEHICLES IN YOUR AREA.

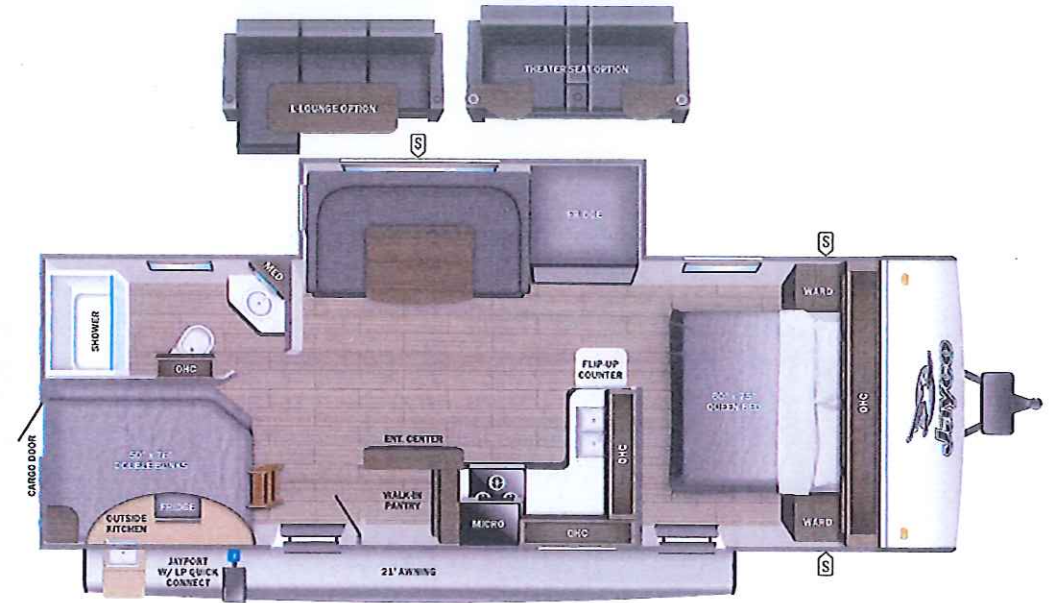

### Standard Equipment

### Optional Equipment

THE FOLLOWING ITEMS ARE STANDARD ON THIS MODEL AT NO EXTRA CHARGE

OPTIONAL EQUIPMENT INSTALLED ON THIS VEHICLE BY MANUFACTURER

- EXTERIOR**
- Aerodynamic, rounded front profile with diamond plate
  - Modern retro graphics package with two-colored sidewall
  - Stronghold VBL™ vacuum-bonded, laminated side and rear walls (including slideout room walls)
  - Azdel laminated interior and exterior walls
  - 2 in. vacuum-bonded floor with 2 lb. foam insulation
  - Keyed-Alike™ lock system
  - Magnum Truss™ Roof System with one-piece seamless roof material
  - American-made I-beam frame with integrated A-frame
  - Dual axles
  - G20 tinted safety-glass windows
  - Marine-grade exterior speakers with blue LED accent lighting (2)
  - Galvanized steel and impact-resistant wheel wells
  - 30-amp service
  - Outside grill propane quick-connect port
  - LCI Solid Step® fold-down aluminum tread entry steps
  - Outside camp kitchen (standard on select models)
  - Battery quick disconnect
  - Slide topper prep (select models with slide rooms)
  - Exterior TV bracket with 120V electric and cable outlets

- SPORT PACKAGE (MANDATORY)**
- Aluminum tread fold-down entry step
  - Enhanced graphics package
  - Front molded fiberglass cap
  - Roof-mount solar prep
  - Glacier Package includes enclosed underbelly
  - 32 in. or 39 in. LED Smart TV
  - Drying rack/sink cover
  - Power roof vent (main living area)

- INTERIOR**
- Choice of two interior design packages- Modern Farmhouse or Vintage Washed Grey
  - LED lighting throughout
  - Smoked glass decorative inserts (select overhead cabinets)
  - Screwed and glued cabinetry
  - Residential vinyl flooring with cold crack resistance
  - Plywood dinette, bunk and bed bases (applicable models)
  - Ball-bearing drawer guides with 75 lb. capacity
  - 6 cu. ft. gas/electric refrigerator
  - Residential oven with 3-burner recessed cooktop and glass cover
  - Residential-style kitchen countertops
  - Microwave
  - Decorative backsplash
  - 4 in. high-density dinette cushions with vinyl backing
  - Jayco exclusive Teddy Bear "soft-touch" residential-style bed mats (select models)
  - 120V outlet and cargo net in fixed bunks
  - Plastic foot flush toilet
  - Bath skylight and roof vent
  - Wood panel fridge inserts
  - Decorative roller shades with reflective backer

- CUSTOMER VALUE PACKAGE (MANDATORY)**
- American-made nitro-filled Goodyear® radial tires with self-adjusting electric brakes
  - Aluminum rims
  - 20 lb. propane bottles with auto regulator (2)
  - 15,000 BTU A/C
  - Spare tire
  - Detachable power cord
  - Power awning with LED lights
  - Black tank flush
  - Outside shower
  - Power tongue jack
  - Manual stabilizer jacks (4)
  - 6 gal. gas/electric DSI water heater
  - 55 gal. fresh water tank
  - AM/FM/Bluetooth® stereo
  - Side-marker camera prep
  - Rear camera backup prep
  - Inverter pre-wire

- Base price  
 Modern Farmhouse  
 CSA Standards  
 Customer Value Package  
 Sport Package  
 No Baja Edition  
 Solar Power Package Prep  
 JayCommand Control System w/TPMS  
 30 AMP Service  
 6 Cu. Ft. Gas/Electric Refrigerator  
 30# LP Gas Bottles  
 Roof Ladder (Std)  
 Front Cap  
 U-Dinette

UNIT TOTAL

DEALER INSTALLED OPTIONS

**UVW**  
 3064 kgs

**Sleeps**

**Length**  
 30' 1.88"

**DIMENSIONS**

Exterior height:.....128.63"  
 Exterior width:.....96.00"

**WEIGHTS**

GVWR:.....3401  
 GAWR (front):.....1587  
 GAWR (rear):.....1587  
 Approx. Gross Cargo Carrying Capacity (GCCC):.....337

**TIRES**

Tire size (front):.....ST205/75R14D  
 Tire size (mid):.....  
 Tire size (rear):.....ST205/75R14D  
 Tire size (spare):.....ST205/75R14D

**CAPACITIES**

Fresh water tank (gals.):...55.00  
 Gray water tank (gals.):...61.00  
 Black water/toilet tank (gals.):.....30.50  
 Propane (kgs.):.....27  
 Propane (gals.):.....14  
 Water heater (gals.):.....6.00

**SEATING & SLEEPING**

\*\*\*Some dimensions may be rounded and may vary from the actual dimensions\*\*\*  
 \*\*\*Weights may be estimated calculations and may vary from the actual weight - refer to the vehicle weight labels for actual weights\*\*\*  
 Floorplans, features and specifications are subject to change without notice.

