

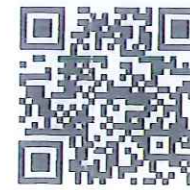

# Jay Flight SLX



Serial #: 1UJBJ0BM1N7520065  
 Model: 240RBSW JAY FLIGHT SLX TT

Model Year: 2022 Dealer Name: BIG BOY'S TOYS LTD  
 1421 EAST ISLAND HIGHWAY  
 Nanoose Bay, BC V9P 9A3  
 CAN

## Manufacturer's Suggested Retail Price

#5052

TOTAL AMOUNT DOES NOT INCLUDE STATE AND LOCAL TAXES OR LICENSE FEES. THE PRICE SHOWN ABOVE MAY OR MAY NOT BE REPRESENTATIVE OF THE ACTUAL SELLING PRICE OF SIMILAR RECREATIONAL VEHICLES IN YOUR AREA.

### Standard Equipment

THE FOLLOWING ITEMS ARE STANDARD ON THIS MODEL AT NO EXTRA CHARGE

### Optional Equipment

OPTIONAL EQUIPMENT INSTALLED ON THIS VEHICLE BY MANUFACTURER

- EXTERIOR**
- Axles with electric, self-adjusting brakes and easy-lube hubs
  - Galvanized steel, impact-resistant wheel wells
  - I-Class™ cambered structural steel I-beams
  - Fully-integrated A-frame
  - 5/8 in. tongue-and-groove plywood floor decking
  - Magnum Truss™ Roof System with plywood decking and seamless DiFlex III material
  - 13,500 BTU roof-mounted A/C
  - 30-amp service
  - 20 lb. propane bottles (2)
  - Camp kitchen (select models)
  - Exterior TV bracket
  - LED exterior lighting
  - Friction-hinge entry door with shade-prep window
  - G20 dark tinted safety-glass privacy windows
  - Detachable power cord

- CUSTOMER VALUE PACKAGE (MANDATORY)**
- Goodyear® Endurance® tires (made in the USA)
  - 6 gal. gas/electric DSI water heater
  - Water heater bypass
  - Front diamond plate
  - Thermal Package Insulation (insulated & enclosed underbelly, foil insulation in roof)
  - Keyed-Alike™ entry and baggage doors
  - Outside shower
  - Power awning with LED lights
  - Marine-grade exterior speakers
  - Black tank flush
  - Spare tire with cover
  - Stabilizer jacks (4)
  - Hitch light
  - Rooftop solar prep
  - JaySMART™ (Safety Markers And Reverse Travel) LED lighting (patent-pending)
  - Large folding entry door grab handle
  - Power tongue jack
  - Pleated window shades
  - Range hood
  - 3-burner range with glass cover
  - 6 cu. ft. gas/electric refrigerator with temperature controls
  - Oven with glass door and interior light
  - Stainless steel microwave oven
  - Fitted bed sheet
  - Bathroom skylight

- INTERIOR**
- 81 in. ceiling height
  - Solid hardwood cabinet doors
  - LED interior lighting
  - Wardrobe/pantry storage
  - J-Steel™ jack-knife sofa with armrest & cupholders
  - Vinyl flooring throughout (including slide room floors)
  - Premium multimedia sound system with MP3/iPod input jacks and Bluetooth® connectivity
  - Digital TV antenna
  - Cable/satellite TV hookup
  - Smoked-glass cabinet door inserts (select models)
  - Large 50/50 acrylic kitchen sink
  - Brushed nickel faucets
  - Heavy-duty, 75 lb., full-extension, steel ball-bearing drawer guides
  - Residential-height plywood bed platforms
  - Bedroom doors in place of curtains (select models)
  - Queen bed struts
  - Queen mattress
  - Bedroom LED accent lighting
  - 300 lb. rated bunk beds (select models)
  - 600 lb. rated bunk beds (double bunks only)
  - Privacy curtains in bunk areas (select models)
  - 4 in. thick bunk mats (select models)
  - Marine-grade toilet with foot flush
  - Tub surround
  - Bathroom exhaust vent
  - Shower curtain with curved shower track (select models)
  - Wood-trimmed mirror in bathroom

- ROCKY MOUNTAIN EDITION (optional)**
- 2nd fresh water tank— 80 gal. total capacity
  - Deluxe colored metal & graphics package
  - Decorative slide room lighting
  - 8 cu. ft. gas/electric refrigerator
  - Pull-out kitchen faucet with sprayer
  - Sink cover and one rolling drying rack
  - Kitchen backsplash
  - Bedspread and pillows
  - Bathroom medicine cabinet
  - Porcelain foot flush toilet

- BAJA EDITION PACKAGE (optional)**
- 30 lb. propane bottles (2)
  - Flipped axle
  - 16 in. Goodyear® off-road tires
  - Triple tread step

- Base price  
 Modern Farmhouse  
 CSA Standards  
 Customer Value Package  
 No Baja Edition  
 Rocky Mountain Edition  
 13,500 BTU AC  
 Aluminum Rims (14")  
 Morryde Step Above Steps  
 30# LP Gas Bottles  
 Roof Ladder (Std)  
 Outside Griddle  
 Winter Shipping Shield  
 Theater Seating Sofa  
 Full Glue (Linoleum  
 Requires Full Glue)

UNIT TOTAL

DEALER INSTALLED OPTIONS

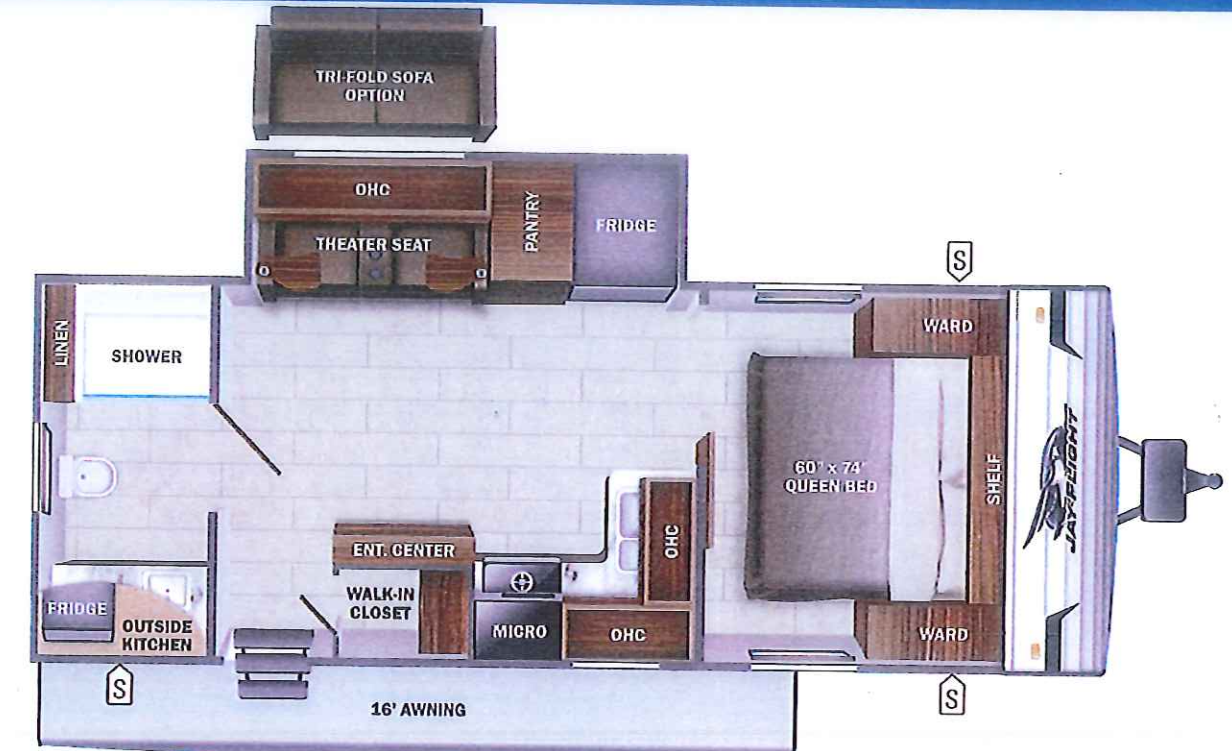

**UVW**  
 2617 kgs

**Sleeps**

**Length**  
 27' 3.75"

#### DIMENSIONS

Exterior height:.....133.88"  
 Exterior width:.....96.00"

#### WEIGHTS

GVWR:.....3288  
 GAWR (front):.....1587  
 GAWR (rear):.....1587  
 Approx. Gross Cargo Carrying Capacity (GCCC):.....670

#### TIRES

Tire size (front):.....ST205/75R14D  
 Tire size (mid):.....  
 Tire size (rear):.....ST205/75R14D  
 Tire size (spare):.....ST205/75R14D

#### CAPACITIES

Fresh water tank (gals.):...76.00  
 Gray water tank (gals.):....78.00  
 Black water/toilet tank (gals):.....39.00  
 Propane (kgs.):.....27  
 Propane (gals.):.....14  
 Water heater (gals.):.....6.00

#### SEATING & SLEEPING

\*\*\*Some dimensions may be rounded and may vary from the actual dimensions\*\*\*

\*\*\*Weights may be estimated calculations and may vary from the actual weight - refer to the vehicle weight labels for actual weights\*\*\*

Floorplans, features and specifications are subject to change without notice.

