

# PALOMINI

TRAVEL TRAILERS

BUILT BY PALOMINO RV



PALOMINI  
BY PALOMINO



186 RBS

**STANDARD FEATURES**

- Dexter Tor Flex torsion axle
- Diamond plate rock guard
- 4 stabilizer jacks
- Power Awning w/LED light
- 1-20 lb. LP tank
- 13,500 BTU roof air conditioner
- 20,000 BTU furnace
- HI Gloss Fiberglass
- Front Cap with windshield and Line X Protectant
- Azdel (R) composite panels
- Rear Accessory Hitch
- Porcelain Toilet
- Bluetooth stereo
- 8 cubic ft. refrigerator
- Residential style back splash
- Ball bearing drawer guides
- 2 burner cook top
- Microwave
- Power vent in bathroom
- CO2 detector
- LED interior lighting
- Laminated walkable roof
- Hot Water, 6 gal.

**OPTIONAL FEATURES**

- 11,000 BTU low profile roof air conditioner
- Aluminum wheels
- Frameless windows
- RVQ grill w/bumper mount
- Solid surface counter tops
- Roof Ladder
- Roof Bike Rack
- Solar Panel
- 24" TV
- Fireplace

**OFF ROAD PKG**

Includes 15" wheels, 28" mudder tires, lift kit, flared fenders, aluminum wheels, assist rail (Pkg std. on 177 ORV BH)

**BADLANDS PKG**

Includes solar panel, roof bike rack and roof ladder



186 RBS  
MESA MAPLE CABINETS



186 RBS  
TOP BUNK DOWN

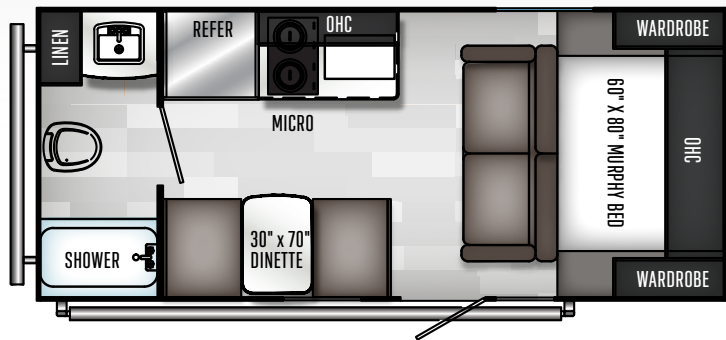

184 RB

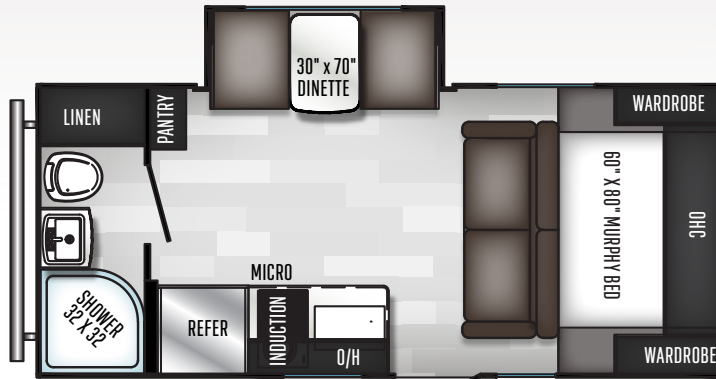

186 RBS

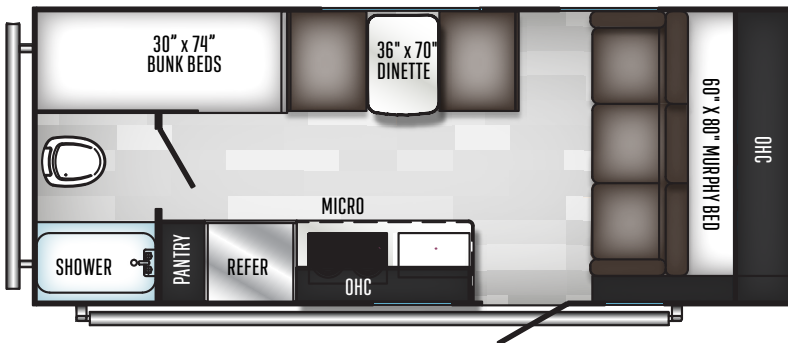

188 BH

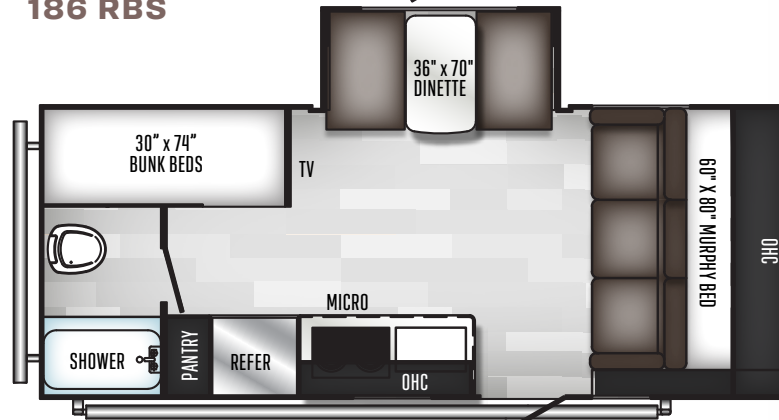

189 BHS

## TOP TEN REASONS YOU CAN'T LIVE WITHOUT A PALOMINI

1. Fiberglass front cap w/integrated automotive grade windshield
2. Full length power awning w/LED lights
3. All dry bath floorplans w/porcelain toilets
4. LED lighting throughout
5. Standard - 13,500 BTU roof top Air conditioner
6. Fully walkable laminated roof
7. 5 sided vacuum bonded construction
8. Tinted safety glass windows
9. Exterior gel coat fiberglass for easy cleaning and maintenance
10. Light weight construction for better fuel efficiency

WEIGHTS & MEASURES	184 RB	186 RBS	188 BH	189 BHS
Hitch Dry Weight	505	505	505	545
Dry Axle Weight	3230	3450	3060	3285
Total Dry Weight	3735	3955	3565	3830
GVWR	4905	4905	4905	4945
Unloaded Vehicle Weight	3754	3974	3584	3849
Interior Height	6'-6"	6'-6"	6'-6"	6'-6"
*Exterior Height (W/ A/C)	10'3"	10'3"	10'3"	10'3"
Exterior Width	7'-6"	7'-6"	7'-6"	7'-6"
Travel Length	21'-9"	21'-9"	22'-11"	22'-11"
Fresh Water Capacity	44 Gal.	44 Gal.	44 Gal.	44 Gal.
Gray Water Capacity	30 Gal.	30 Gal.	30 Gal.	30 Gal.
Black Water Capacity	38 Gal.	38 Gal.	38 Gal.	38 Gal.
Cargo Capacity	1151	931	1321	1096
Awning size	14'	14'	15'	15'

\*OFF ROAD PACKAGE ADD 4"

## Specification Definitions

**GVWR (Gross Vehicle Weight Rating)** - is the maximum permissible weight of the unit when fully loaded. It includes all weights, inclusive of all fluids, cargo, optional equipment and accessories. For safety and product performance do NOT exceed the GVWR.

**GAWR (Gross Axle Weight Rating)** - is the maximum permissible weight, including cargo, fluids, optional equipment and accessories that can be safely supported by a combination of all axles.

**UVW (Unloaded Vehicle Weight)\*\*** - is the typical weight of the unit as manufactured at the factory. It includes all weight at the unit's axle(s) and tongue or pin and LP Gas. The UVW does not include cargo, fresh potable water, additional optional equipment or dealer installed accessories.

\*Estimated average based on standard build optional equipment.

**CCC (Cargo Carrying Capacity)\*\*** - is the amount of weight available for fresh potable water, cargo, additional optional equipment and accessories. CCC is equal to GVWR minus UVW. Available CCC should accommodate fresh potable water (8.3 lbs per gallon). Before filling the fresh water tank, empty the black and gray

tanks to provide for more cargo capacity.

\*\* Estimated average based on standard build optional equipment

Each Forest River RV is weighed at the manufacturing facility prior to shipping. A label identifying the unloaded vehicle weight of the actual unit and the cargo carrying capacity is applied to every Forest River RV prior to leaving our facilities.

The load capacity of your unit is designated by weight, not by volume, so you cannot necessarily use all available space when loading your unit.



## PALOMINI WARRANTY

Palomino will stand behind our products 100%. For complete details on our warranty program, please see your Palomino dealer.

- 1 2-year fiberglass warranty
- 2 12-year Alpha Super Flex roof warranty
- 3 2-3 year warranty on appliances (see manual for details)
- 4 1-year bumper to bumper warranty

All information contained in this brochure is believed to be accurate at the time of publication. However, during the model year, it may be necessary to make revisions and Forest River, Inc., reserves the right to make all such changes without notice, including prices, colors, materials, equipment and specifications as well as the addition of new models and the discontinuance of models shown in this brochure. Therefore, please consult with your Forest River dealer and confirm the existence of any materials, design or specifications that are material to your purchase decision. Litho. U.S.A. FOR 1655 P/W: 2021.01.29

YOUR PALOMINI DEALER

**FREE MEMBERSHIP**  
to Forest River Owners' Group

[www.forestriverfrog.com](http://www.forestriverfrog.com)



**Learn More**  
Scan this barcode using a QR Reader on your smart phone to learn more about Forest River.



A Berkshire Hathaway company.

**PALOMINO**

1047 EAST M-86 | COLON, MI 49040  
P: 269.432.3271 | F: 269.432.2516  
[www.palominorv.com](http://www.palominorv.com)



### PRE-DELIVERY INSPECTION FACILITY

20,000 square feet of quality assurance. The bare essentials for a premium product. This state-of-the-art facility gives immediate daily feedback to production for quality assurance in every unit built.

### 24/7 EMERGENCY ROADSIDE ASSISTANCE WITH VEHICLE PURCHASE\*

TOWING	WINCH-OUT
JUMP-STARTS	MOBILE MECHANIC
TIRE CHANGES	TECHNICAL
FLUID DELIVERY	SUPPORT
LOCKOUT SERVICE	DEALER LOCATOR SERVICES



\*VALID FOR 1 YEAR FROM DATE OF PURCHASE

### CUSTOMER SATISFACTION



[www.ForestRiverBuyLocal.com](http://www.ForestRiverBuyLocal.com)