

COUGAR

FIFTH WHEELS / TRAVEL TRAILERS



KEYSTONE
RV COMPANY

CAMPBETTER
KINDNESS · COMMUNITY · PLANET

A N A M E R I C A N I C O N

Step into the legacy of RVing with the iconic Keystone Cougar. Our 2024 collection invites you to join generations of campers who have trusted Cougar as their choice for extraordinary journeys. With a range that includes fifth wheels, half-ton fifth wheels, and travel trailers, Cougar stands as a leader in the industry, embodying not just a brand, but a tradition of innovation, style, and unforgettable experiences.

From winding trails to wide highways, Cougar has been there, evolving with the spirit of RVing leading the way with unparalleled comfort and unmatched quality. Join the ranks of those who have discovered the thrill of travel with Cougar RVs – where the past meets the future, and where every adventure becomes an extraordinary chapter in your own unique American story.

COUGAR EXCEPTIONAL FEATURES

- One-Piece Alpha Super Flex TPO Roof Membrane w/ Limited Lifetime Warranty
- Electric, 4-Point Auto Leveling System (OPTIONAL ON SELECT TRAVEL TRAILER MODELS)
- Lippert Road Armor™ Suspension & Pin Box (FIFTH WHEEL MODELS ONLY)
- Goodyear™ Endurance 10-Ply E-Rated Tires w/ Roadside Assistance (N/A SPORTS)
- Lippert Tire Linc TPMS Prep
- Climate Guard Four-Season Protection Package
- 30K BTU Gas Furnace
- Coleman-Mach Quiet Series 15K BTU Air Conditioner (N/A SPORTS)
- Coleman-Mach Quiet Series 13.5K Bedroom Air Conditioner (OPTIONAL ON SOME MODELS) (N/A SPORTS)
- Blade Pure™ High-Performance, Airflow System w/MERV 9 Filtration (N/A SPORTS)
- Giggy Box 12-Volt Distribution Center w/ Battery Disconnect
- Hyperdeck™ High-Performance, Water-Resistant RV Floors (HALF-TON FW & TT MODELS ONLY)
- NEW MORryde® Safe-T-Rail Entry Handle (FIFTH WHEEL MODELS ONLY) (N/A SPORTS)
- Lippert SolidStep® Entry Steps
- Lippert Entry Door Thin Shade
- Durable Rubber Flooring in Pass-Through Storage (FIFTH WHEELS MODELS ONLY)
- iN-Command® w/ Global Connect® Smart RV Control System (N/A SPORTS)
- Winegard Air 360+ Omni-Directional Rooftop Antenna w/ Exclusive Satellite Pass-Through
- Key TV Multi-Source Signal Controller
- Color-Coded & Numbered Wiring
- Girard Tankless On-Demand Water Heater
- Amy Gray Signature™ Interior Design
- **NEW** Luxe Driftwood Decor (SEE KEYSTONERV.COM FOR DETAILS)
- Heated & Massage Theater Seats (MOST MODELS)
- **NEW** Soft-Close Cabinet Doors
- Ceiling Fans (MOST FIFTH WHEEL MODELS)
- Black Out Roller Shades (MOST FIFTH WHEEL MODELS)
- Furrion 12V Refrigerator
- Furrion 21" Oven w/ 3-Burner Cooktop
- Outdoor Kitchen w/ Griddle (select models)
- Deeper Bed Slide w/ More Walkaround Space (FIFTH WHEEL MODELS ONLY)
- CPAP-Ready Nightstands (MOST MODELS)
- **NEW** Recessed Medicine Cabinet (SELECT MODELS)
- Stackable Washer and Dryer Prep (FULL SIZE MODELS ONLY)
- SolarFlex™ Protect 220, Discover 440i, and Outlast 660i-L Solar Power Systems w/ Optional Dragonfly Energy Lithium-ion Batteries
- 1-Year Limited Base Warranty & 3-Year Limited Structural Warranty (SEE KEYSTONERV.COM FOR DETAILS)



Available on Premium Fifth Wheel Models
SEE KEYSTONERV.COM FOR FULL DETAILS.

NEW
**MIDNIGHT
EDITION**
FULL BODY PAINT

PREMIUM FIFTH WHEELS

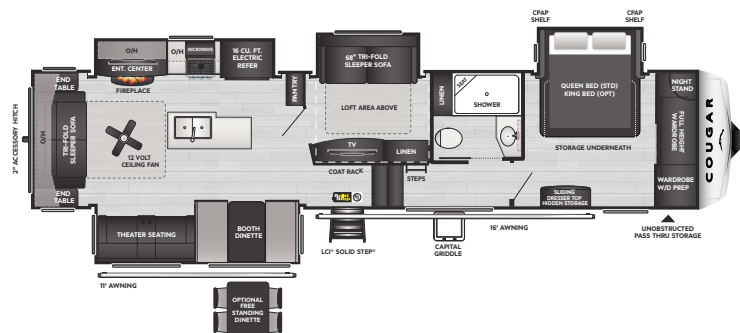
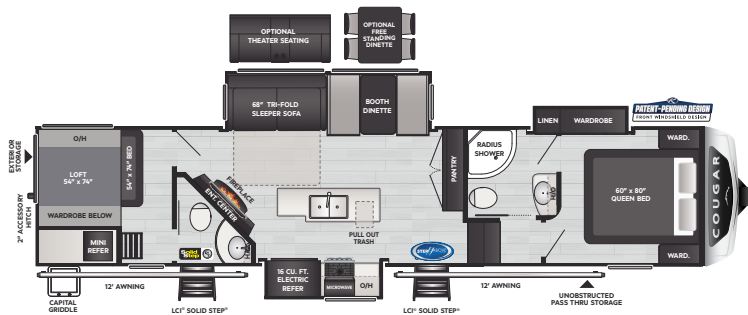
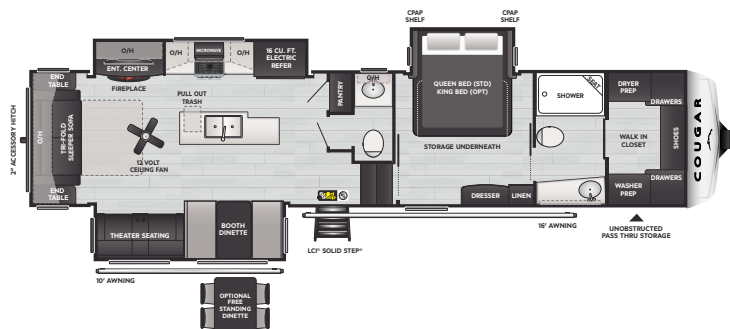
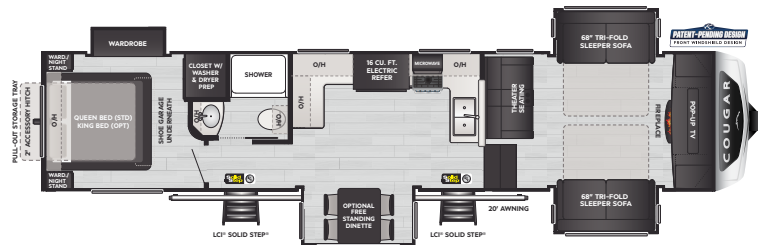
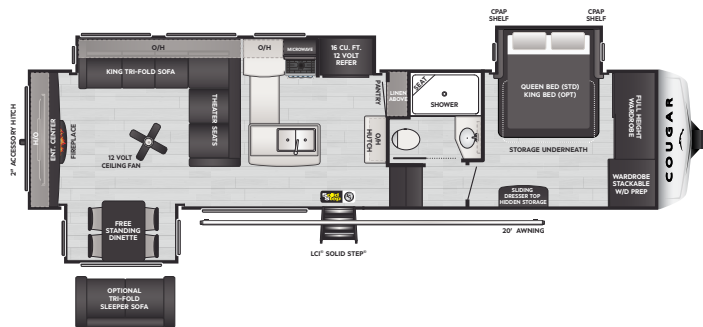
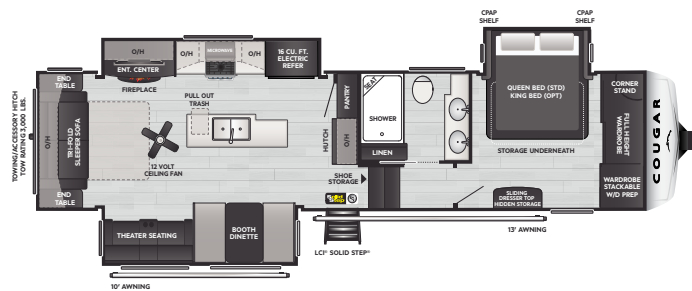
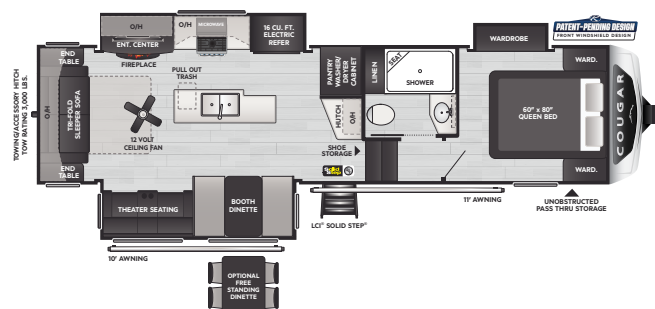
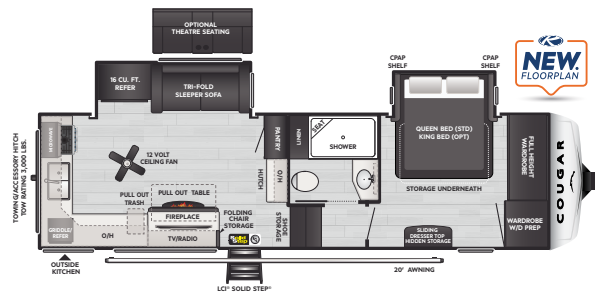

HALF-TON FIFTH WHEELS

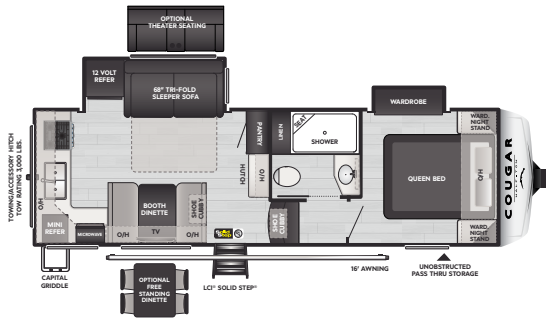

23MLE | WEIGHT 7678 | LENGTH 27' 11"

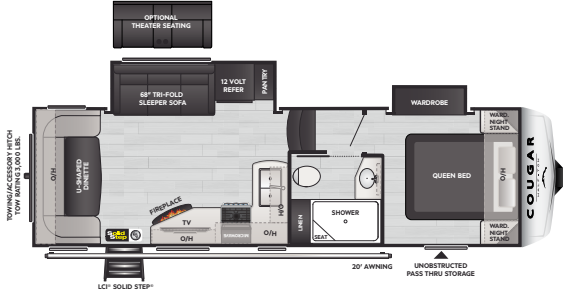

24RDS | WEIGHT 7612 | LENGTH 28' 10"

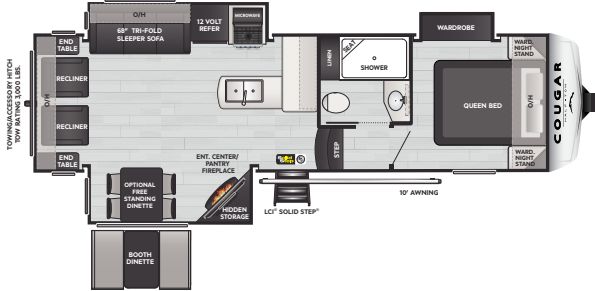

27SGS | WEIGHT 8211 | LENGTH 30' 6"

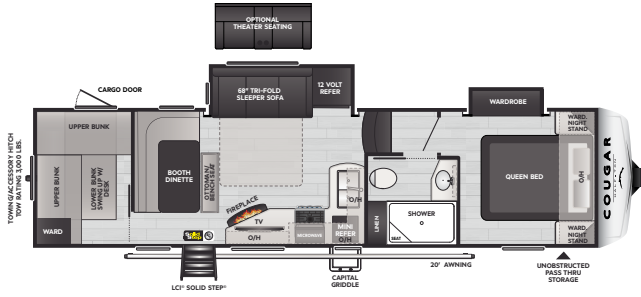

29BHL | WEIGHT 8345 | LENGTH 33' 4"

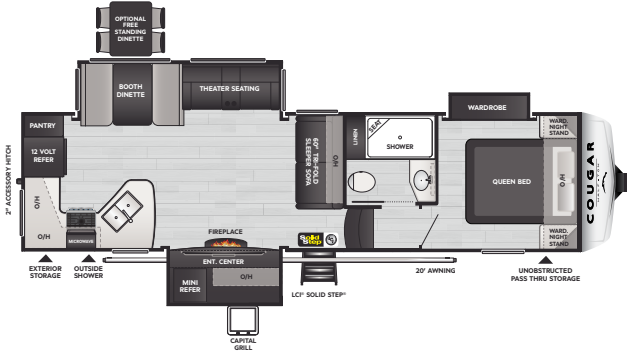

29RKS | WEIGHT 8958 | LENGTH 32' 9"

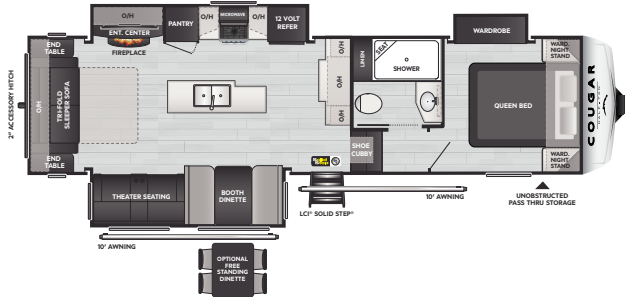

29RLI | WEIGHT 8893 | LENGTH 32' 9"

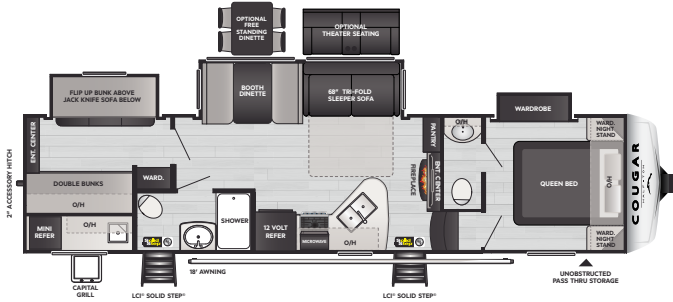

32BHS | WEIGHT 9428 | LENGTH 35' 8"

VISIT OUR WEBSITE FOR PHOTOS,
360° TOURS, AND FULL PRODUCT DETAILS



HALF-TON TRAVEL TRAILERS

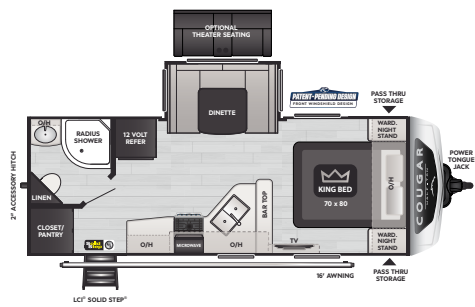

22RBS | WEIGHT 5676 | LENGTH 25' 11"

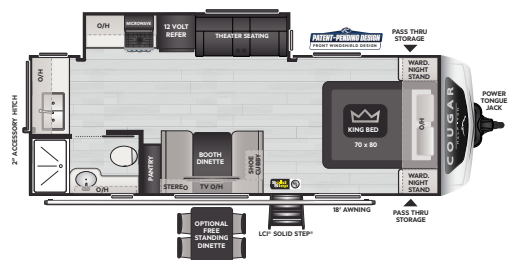

22MLS | WEIGHT 5887 | LENGTH 26' 10"

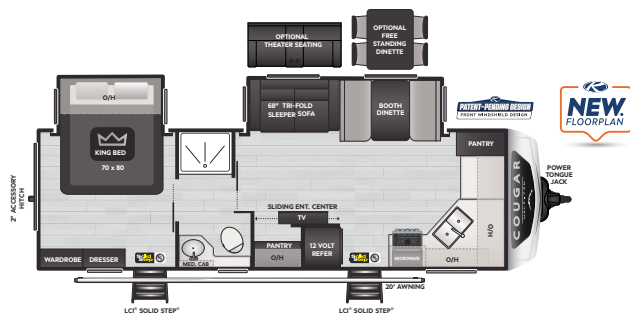

25FKD | WEIGHT TBD | LENGTH 29' 11"

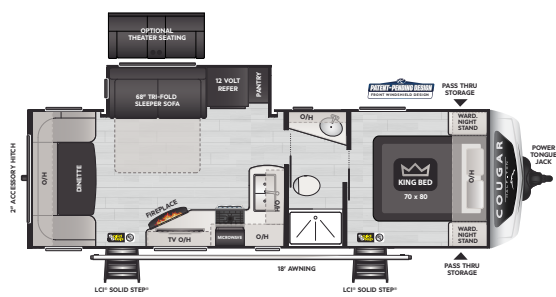

25RDS | WEIGHT 6419 | LENGTH 29' 10"

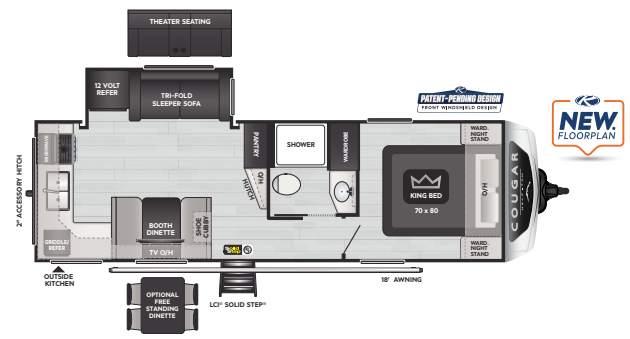

25MLE | WEIGHT 6525 | LENGTH 29' 11"

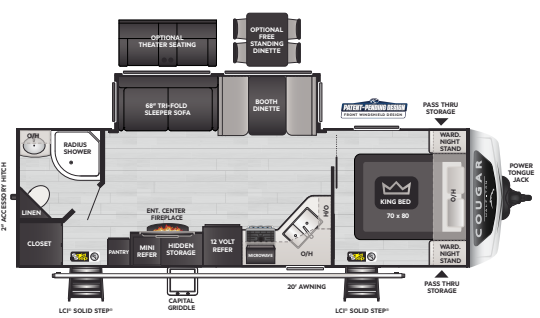

26RBS | WEIGHT 6796 | LENGTH 29' 11"

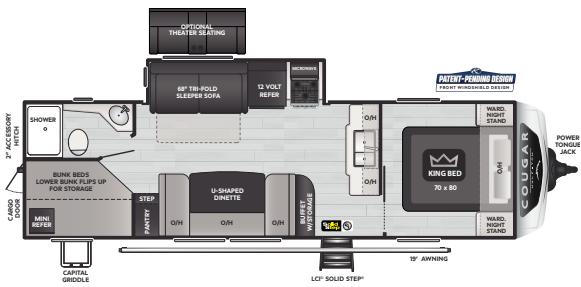

27BHS | WEIGHT 7008 | LENGTH 31' 11"

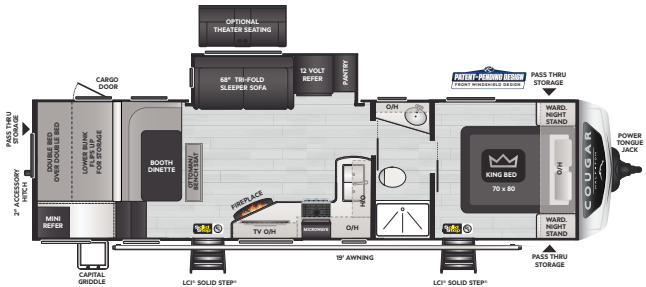

30BHS | WEIGHT 7285 | LENGTH 34' 5"

HALF-TON TRAVEL TRAILERS

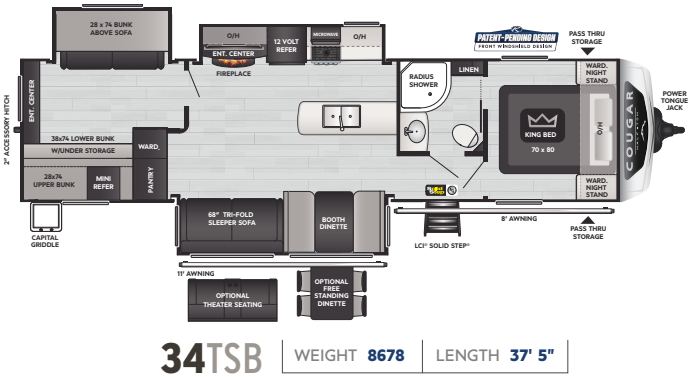
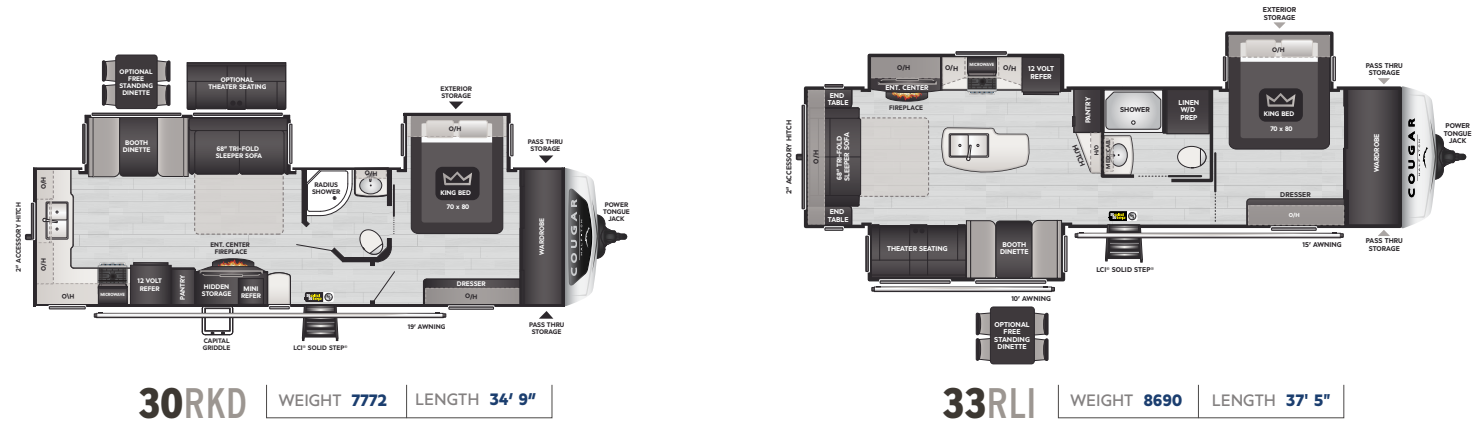

INTRODUCING
COUGAR
SPORT

New high-spirited, ultra-affordable
floorplans built for adventure and beyond.
SEE KEYSTONERV.COM FOR FULL PRODUCT DETAILS.

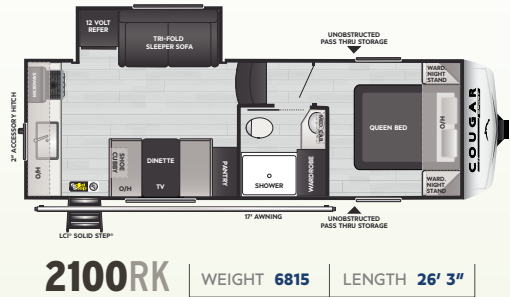

SCAN HERE
TO VIEW COUGAR
SPORT FEATURES

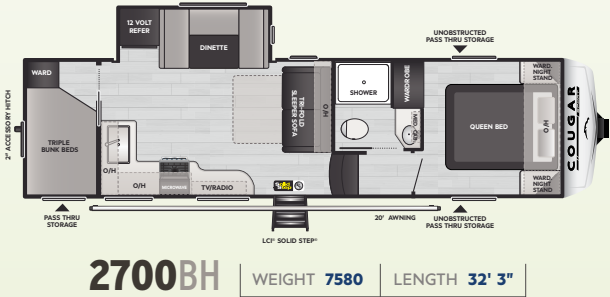
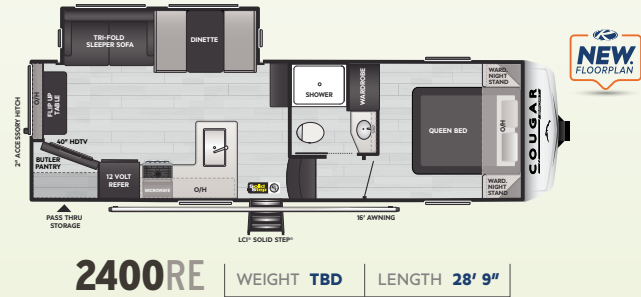

COUGAR SPECIFICATIONS

| MODEL | WEIGHT | CARRYING CAPACITY | HITCH WEIGHT | FRESH WATER** | WASTE WATER | GRAY WATER | LPG | LENGTH* | WIDTH | HEIGHT | AWNING |
|-------------|--------|-------------------|--------------|---------------|-------------|------------|-----|---------|-------|--------|---------|
| PREMIUM FW | | | | | | | | | | | |
| 260MLE | 9725 | 2275 | 1895 | 75 | 38 | 76 | 60 | 30' 11" | 8' | 13' 4" | 20' |
| 290RLS | 10124 | 2776 | 1805 | 75 | 38 | 76 | 60 | 33' 8" | 8' | 13' 4" | 11'/10' |
| 316RLS | 10679 | 1621 | 1900 | 75 | 38 | 76 | 60 | 35' 8" | 8' | 13' 4" | 13'/10' |
| 320RDS | 11133 | 2617 | 1775 | 75 | 38 | 76 | 60 | 36' 10" | 8' | 13' 4" | 20' |
| 354FLS | 11041 | 2959 | 2365 | 75 | 38 | 76 | 60 | 39' 2" | 8' | 13' 4' | 20' |
| 355FBS | 11357 | 2543 | 1900 | 75 | 76 | 76 | 60 | 39' 3" | 8' | 13' 4' | 16'/10' |
| 364BHL | 11404 | 2596 | 2200 | 75 | 76 | 76 | 60 | 39' 0" | 8' | 13' 5" | 12'/12' |
| 368MBI | 11847 | 2133 | 1980 | 75 | 38 | 76 | 60 | 39' 3" | 8' | 13' 4" | 16'/11' |
| HALF-TON FW | | | | | | | | | | | |
| 23MLE | 7678 | 2222 | 1200 | 54 | 30 | 60 | 60 | 27' 11" | 8' | 12' 0" | 16' |
| 24RDS | 7612 | 2388 | 1430 | 54 | 30 | 60 | 60 | 28' 10" | 8' | 12' 7" | 20' |
| 27SGS | 8211 | 2079 | 1495 | 54 | 30 | 60 | 60 | 30' 6" | 8' | 12' 7" | 10' |
| 29BHL | 8345 | 2655 | 1610 | 54 | 30 | 60 | 60 | 33' 4" | 8' | 12' 8" | 20' |
| 29RKS | 8958 | 1442 | 1605 | 54 | 30 | 60 | 60 | 32' 9" | 8' | 12' 7" | 20' |
| 29RLI | 8893 | 2107 | 1630 | 54 | 30 | 60 | 60 | 32' 9" | 8' | 12' 8" | 10'/10' |
| 32BHS | 9428 | 2072 | 1570 | 54 | 60 | 60 | 60 | 35' 8" | 8' | 12' 7" | 18' |
| HALF-TON TT | | | | | | | | | | | |
| 22RBS | 5676 | 1524 | 755 | 54 | 30 | 30 | 60 | 25' 11" | 8' | 11' 5" | 16' |
| 22MLS | 5887 | 1313 | 645 | 54 | 30 | 30 | 60 | 26' 10" | 8' | 11' 5" | 18' |
| 25FKD | TBD | TBD | TBD | 54 | 30 | 60 | 60 | 29' 11" | 8' | 11' 5" | 20' |
| 25RDS | 6419 | 2381 | 835 | 54 | 30 | 60 | 60 | 29' 10" | 8' | 11' 5" | 19' |
| 25MLE | 6525 | 2275 | 695 | 54 | 30 | 60 | 60 | 29' 11" | 8' | 11' 5" | 18' |
| 26RBS | 6796 | 2004 | 880 | 54 | 30 | 60 | 60 | 29' 11" | 8' | 11' 5" | 20' |
| 27BHS | 7008 | 1992 | 730 | 54 | 30 | 60 | 60 | 31' 11" | 8' | 11' 3" | 19' |
| 30BHS | 7285 | 2215 | 790 | 54 | 30 | 60 | 60 | 34' 5" | 8' | 11' 5" | 19' |
| 30RKD | 7772 | 1728 | 955 | 54 | 30 | 60 | 60 | 34' 9" | 8' | 11' 5" | 19' |
| 33RLI | 8690 | 1810 | 1215 | 54 | 30 | 60 | 60 | 37' 5" | 8' | 11' 4" | 14'/10' |
| 34TSB | 8678 | 1822 | 1150 | 54 | 30 | 60 | 60 | 37' 5" | 8' | 11' 4" | 8'/11' |
| SPORT FW | | | | | | | | | | | |
| 2100RK | 6815 | 1685 | 1120 | 54 | 30 | 60 | 60 | 26' 3" | 8' | 12' 0" | 17' |
| 2400RE | TBD | TBD | TBD | 54 | 30 | 60 | 60 | 28' 9" | 8' | 12' 7" | 16' |
| 2700BH | 7580 | 1920 | 1390 | 54 | 30 | 60 | 60 | 32' 3" | 8' | 12' 7" | 20' |



"We recently upgraded to a Keystone Cougar travel trailer and have been very pleased with it. It is roomy and very functional and it is clear that a lot of attention to detail went into designing and building the trailer. It has many thoughtful features throughout that make it a pleasure to stay in and use. Everything is well laid out and very convenient to access. It has all the latest available technology and it all works together very well to provide a great experience."

— RODRIGO COUGAR 33RLI OWNER



NEW 2024 PACKAGE UPDATES

For more information scan the QR code
or visit keystonerv.com.

TAKE *CHARGE* OF HOW YOU CAMP

**EXCEPTIONAL QUALITY, IMPOSSIBLY VERSATILE, SolarFlex™
IS SHATTERING CUSTOMER'S EXPECTATIONS OF FACTORY-INSTALLED SOLAR POWER.
EXCLUSIVELY AVAILABLE ON ALL KEYSTONE RV MODELS.**



Keystone RV is proud to partner with Dragonfly Energy to offer their legendary heated Lithium-ion batteries exclusively on all Keystone models.



FOLLOW US FOR THE LATEST!



DISCLAIMER: Product information is as accurate as possible as of the date of publication of this brochure. All features, floor plans, and specifications in this brochure are subject to change without notice. Please also consult Keystone's web site at www.keystonerv.com for more current product information and specifications. Tow Vehicle Disclaimer. CAUTION: Owners of Keystone recreational vehicles are solely responsible for the selection and proper use of tow vehicles. All customers should consult with a motor vehicle manufacturer or their dealer concerning the purchase and use of suitable tow vehicles for Keystone products. Keystone disclaims any liability or damages suffered as a result of the selection, operation, use or misuse of a tow vehicle. KEYSTONE'S LIMITED WARRANTY DOES NOT COVER DAMAGE TO THE RECREATIONAL VEHICLE OR THE TOW VEHICLE AS A RESULT OF THE SELECTION, OPERATION, USE OR MISUSE OF THE TOW VEHICLE. *Length is defined as the distance from the centerline of hitch pin/coupler to rear bumper of trailer. ** Fresh water capacity includes water heater. Please review owner's manual prior to purchase for more information on service warranties, extended use, towing and maintenance. Owner's manuals can be found at keystonerv.com.

PRINT 10.2023