

# Flagstaff

T  
R  
A  
V  
E  
L  
  
T  
R  
A  
I  
L  
E  
R  
S



# E-Pro

E-Pro was developed to fill a need in the light-weight RV market for those who love adventure and the great outdoors. Several models in the E-Pro line-up have the capability of going off-grid with the optional Power Package.

With several configurations and sleep accommodations, there's a E-Pro for everyone's needs.

**50**  
CELEBRATING  
**YEARS**  
**FLAGSTAFF**  
SINCE 1974

For half a century, we have proudly and passionately crafted recreational vehicles that have become synonymous with quality, innovation, and adventure.

Since our establishment in 1974, we've committed ourselves to putting quality first and doing things right, every step of the way.

## Power Pro™ App Control

Your RV is equipped with Power Pro™ by WFCO Technologies. Power Pro™ is a voice activated digital control system designed to enhance your RVing experience by controlling lights, awnings, battery and tank levels, and more!



# PWR PRO

Download Today!



Apple and App Store are registered trademarks of Apple Inc. Google Play and the Google Play logo are trademarks of Google LLC.



**FOREST RIVER**

FORESTRIVERINC.COM

# POWER

PACKAGE

## Option Includes:\*

- Charge at Home from a 15A Receptacle with Combimaster Power Sharing Feature
- 3000W Inverter/Charger w/160A Charging Capacity
- 11,000 BTU Soft Start Power Saver A/C
- Two Mastervolt Smart Remotes
- 50A DC/DC Charger —New!
- 460Ah Mastervolt Lithium Battery
- 30A Charge Controller
- (3) 200W GoPower® Solar Panels
- Centralized System Disconnect Switch



Whether boondocking or going off-grid, the E-Pro Power Package option was designed for outdoor enthusiasts who love adventure.

\*Select Models Only. Look for the  Icon Next to the Floorplan.

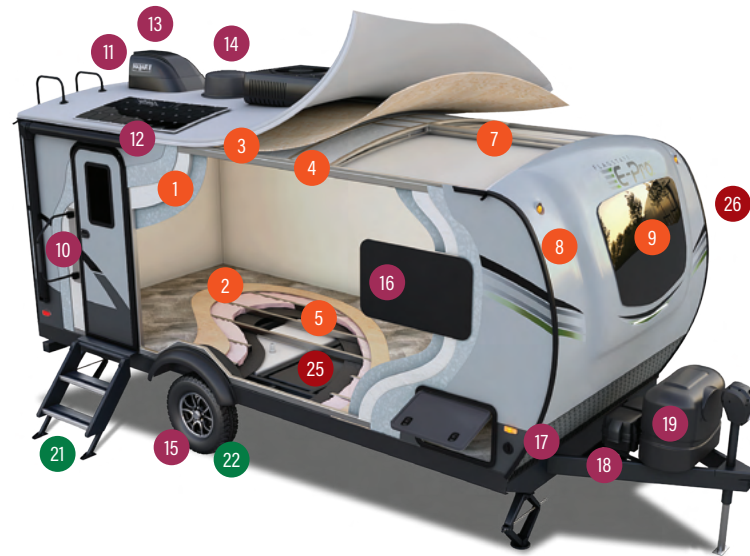

## SUPERIOR CONSTRUCTION

1. Complete **Composite** Wall Construction
2. 5/8" Tongue & Groove Plywood Floor
3. Fully **Laminated** Walkable Roof
4. 6-Sided Full-Aluminum Frame
5. Aluminum Floor Joists
6. Aluminum Dinette, Bed, and Bunk
7. Aluminum Truss Roof Bracing
8. Fiberglass Front Cap
9. Automotive Glass Windshield

## STANDARD FEATURES

10. Key-Alike Lock System
11. Back-Up Camera Prep
12. 200W Solar Panel w/1800W<sup>1</sup> Inverter & 30A Charge Controller
13. Maxxair Fan with Cover
14. Winegard Air 360+ Prepped for Wi-Fi
15. Sport Tire and Wheel Package
16. Frameless Windows
17. Additional Solar Prep
18. Double Battery Boxes
19. Double 20 Lb. LP Tanks
20. Power Pro™ Voice Activated Control Panel

## SAFETY STANDARDS

21. MORryde Solid, Supported Steps
22. Dexter® Torflex® Axles
23. Nitrogen-Filled Tires w/Balancing Beads
24. TST TPMS

## CLIMATE PROTECTION PACKAGE

25. 12V Thermostat-Controlled Heated Tanks
26. Radiant Foil in Front Cap

## OPTIONAL FEATURES (NOT PICTURED)

27. Power Package (Select Models)
28. Additional 200W Solar Panel

<sup>1</sup> N/A 12SA and 14DA; 12SA and 14DA have a 1000W inverter

# E-Pro

E-Pro was developed to fill a need in the light-weight RV market for those who love adventure and the great outdoors. Several models in the E-Pro line-up have the capability of going off-grid with the optional Power Package.

With several configurations and sleep accommodations, there's a E-Pro for everyone's needs.



For half a century, we have proudly and passionately crafted recreational vehicles that have become synonymous with quality, innovation, and adventure.

Since our establishment in 1974, we've committed ourselves to putting quality first and doing things right, every step of the way.

## Power Pro™ App Control

Your RV is equipped with Power Pro™ by WFCO Technologies. Power Pro™ is a voice activated digital control system designed to enhance your RVing experience by controlling lights, awnings, battery and tank levels, and more!



**PWR PRO**  
Download Today!



Apple and App Store are registered trademarks of Apple Inc. Google Play and the Google Play logo are trademarks of Google LLC.

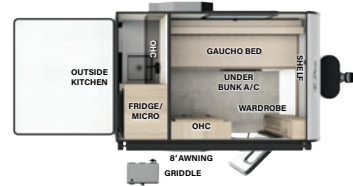

**E12SA**

LENGTH: 12' 3" WIDTH: 7' 4" HEIGHT: 7' 3" HITCH: 200 AXLE: 1665  
UWV: 1903 CCC: 937 **F** 20 GAL **G** 6 GAL **B** N/A

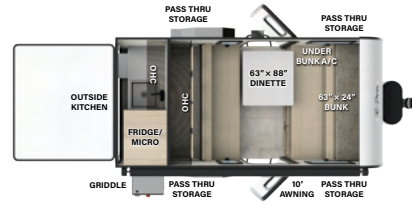

**E14DA**

LENGTH: 14' 11" WIDTH: 7' 4" HEIGHT: 7' 3" HITCH: 290 AXLE: 1915  
UWV: 2243 CCC: 687 **F** 20 GAL **G** 6 GAL **B** N/A

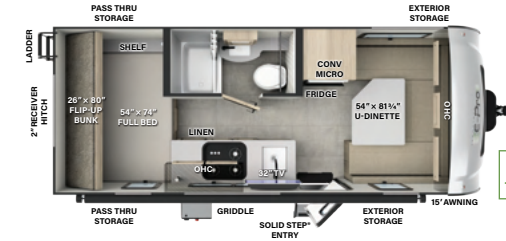

**NEW!**  
**E19DBH**

LENGTH: 20' 8" WIDTH: 7' 8" HEIGHT: 10' 2" HITCH: 425 AXLE: 2925  
UWV: 3388 CCC: 1037 **F** 31 GAL **G** 27 GAL **B** 27 GAL

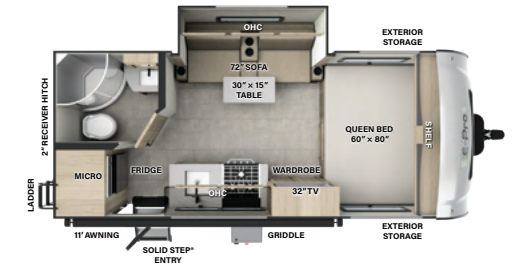

**E19FBS**

LENGTH: 20' 2" WIDTH: 7' 8" HEIGHT: 10' 1" HITCH: 437 AXLE: 3068  
UWV: 3543 CCC: 894 **F** 31 GAL **G** 27 GAL **B** 27 GAL

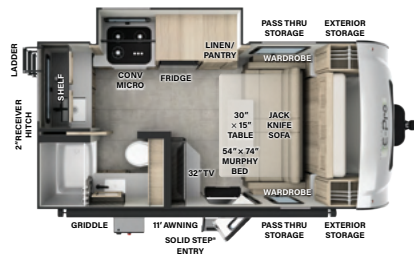

**E15FBS**

LENGTH: 17' 5" WIDTH: 7' 8" HEIGHT: 10' 1" HITCH: 498 AXLE: 2899  
UWV: 3435 CCC: 1063 **F** 31 GAL **G** 27 GAL **B** 27 GAL



**E15FDG**

LENGTH: 15' 8" WIDTH: 7' 8" HEIGHT: 10' 1" HITCH: 342 AXLE: 2605  
UWV: 2985 CCC: 1357 **F** 31 GAL **G** 27 GAL **B** 27 GAL

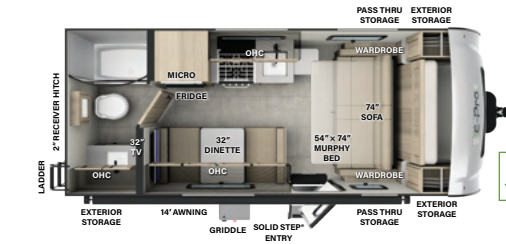

**E19FD**

LENGTH: 20' 2" WIDTH: 7' 8" HEIGHT: 10' 1" HITCH: 432 AXLE: 2947  
UWV: 3417 CCC: 1015 **F** 31 GAL **G** 27 GAL **B** 27 GAL

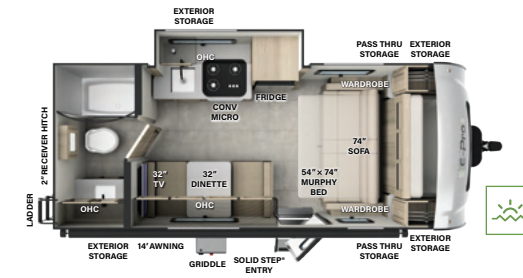

**E19FDS**

LENGTH: 20' 2" WIDTH: 7' 8" HEIGHT: 10' 1" HITCH: 485 AXLE: 2983  
UWV: 3506 CCC: 979 **F** 31 GAL **G** 27 GAL **B** 27 GAL

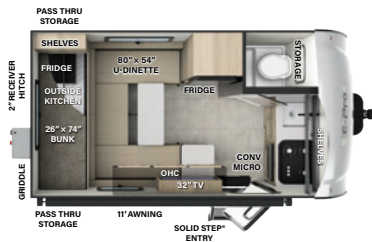

**E15RDG**

LENGTH: 16' 2" WIDTH: 7' 8" HEIGHT: 10' 1" HITCH: 325 AXLE: 2520  
UWV: 2883 CCC: 1442 **F** 31 GAL **G** 27 GAL **B** 12 GAL

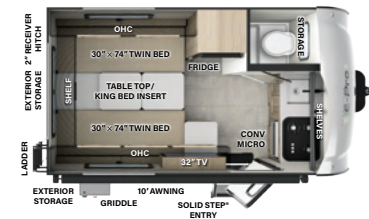

**E15TB**

LENGTH: 15' 8" WIDTH: 7' 8" HEIGHT: 10' 1" HITCH: 407 AXLE: 2401  
UWV: 2846 CCC: 1061 **F** 31 GAL **G** 12 GAL **B** 12 GAL

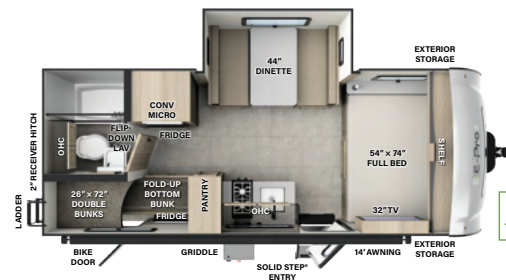

**NEW!**  
**E20BH**

LENGTH: 21' 2" WIDTH: 7' 8" HEIGHT: 10' 4" HITCH: 480 AXLE: 3288  
UWV: 3906 CCC: 1092 **F** 31 GAL **G** 27 GAL **B** 27 GAL

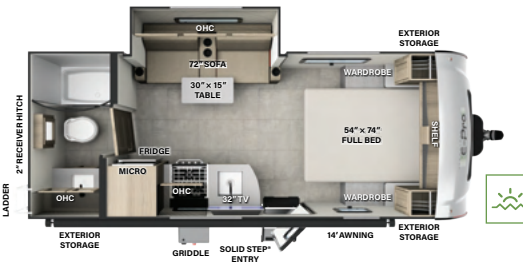

**E20FBS**

LENGTH: 21' 2" WIDTH: 7' 8" HEIGHT: 10' 1" HITCH: 398 AXLE: 3109  
UWV: 3545 CCC: 853 **F** 31 GAL **G** 27 GAL **B** 27 GAL



Millersburg, Indiana is a special place with special people. This is a town built upon care, craftsmanship, and teamwork. Millersburg is our home and we're grateful for the opportunity to employ many of our neighbors, friends, and families. Flagstaff is a proud employer of multiple generations of Millersburg residents and our quality-first reputation is second to none, thanks to our Millersburg home.

We're happy to have zero stoplights, two banks, two parks, one gas station, one car mechanic, an elementary school, and a few churches in our humble corner of Elkhart County. We work hard, care, build, craft, and take care of each other and our families. Millersburg keeps North America camping, one Flagstaff at a time, made with pride and value.

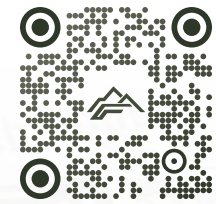

**SCAN THE QR CODE WITH YOUR MOBILE DEVICE**

VIRTUAL TOURS, PHOTOS, VIDEOS, FOLLOW FLAGSTAFF ON SOCIAL MEDIA, AND MORE!

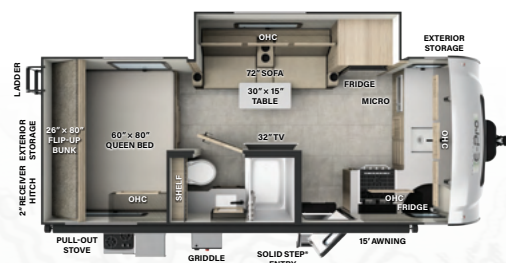

**NEW!**  
**E20FK**

LENGTH: 21' 2" WIDTH: 7' 8" HEIGHT: 10' 1" HITCH: 610 AXLE: 3585  
UWV: 4233 CCC: 1262 **F** 31 GAL **G** 39 GAL **B** 27 GAL

# Flagstaff

201 WEST ELM MILLERSBURG, IN 46543  
WWW.FORESTRIVERINC.COM/FLAGSTAFF  
574.642.2640



RV WITH US



@FlagstaffRVs

# 50

CELEBRATING  
YEARS

FLAGSTAFF  
SINCE 1974

## Flagstaff Warranty. Our Promise.

FOR DETAILS ON FLAGSTAFF'S COMPLETE WARRANTY PROGRAM, SEE YOUR FLAGSTAFF DEALER.

When it comes to backing products with the same quality and commitment it does when it begins the manufacturing process, the only name you have to remember when you're looking for a recreational vehicle is Flagstaff. Flagstaff offers the following additional limited warranties to the original purchasers. Consult written warranty for details.

**1** Limited Lifetime roofing warranty.\*

\*Lifetime warranty is limited to original owner

**2** Two-year fiberglass warranty.

**3** Ten-year Torflex® axle warranty.

**4** One-year bumper to bumper warranty.

## E-PRO PACKAGES

### STANDARD PACKAGE G: (N/A MODELS E12SA, E14DA)

- Clay/Alloy 2 Tone Fiberglass Exterior
- High Gloss Fiberglass Cap
- Composite Structural Exterior Walls
- Vacuum Laminated Roof
- Aluminum Cage Construction
- Frameless Windows
- Front Windshield (Where Available)
- Pre-wire for Backup Camera
- Heated Holding Tanks
- 200W Solar Panel w/Inverter & Additional Solar Side Port
- AIR 360+ Omnidirectional Antenna w/WI-FI Prep
- Power Pro™ App Monitor Panel
- 12V Entertainment Smart TV w/Stereo
- 12V Refrigerator
- Microwave Oven (Convection STD when in Slide Out)
- Gas Oven (N/A on E20BH or if installed in Slide Out)
- Auto Ignite Gas/Electric Water Heater
- 20,000 BTU Furnace
- 13,500 BTU A/C
- Dexter® Torflex® Torsion Axles
- Sport Tires & Wheels w/TPMS Tire Pressure Monitoring System
- Roller Shades
- Key Alike Doors
- Soft Close Roller Bearing Drawers
- Hidden Cabinet Hinges
- Exterior Ladder
- Black Tank Flush
- Shower Miser
- Exterior Hot/Cold Water Port
- Outside Speaker
- 2" Accessory Hitch
- Gas Griddle
- Spare Tire
- Power Tongue Jack

### STANDARD PACKAGE E: (MODELS E12SA, E14DA ONLY)

- Clay/Alloy 2 Tone Fiberglass Exterior
- Composite Structural Exterior Walls
- Vacuum Laminated Roof
- Aluminum Cage Construction
- Frameless Windows
- Thule Power Awning
- 200W Solar Panel w/Inverter & Additional Solar Side Port
- 12V Refrigerator
- Microwave Oven
- On Demand Water Heater
- 20,000 BTU Furnace
- Underbunk/Cabinet A/C
- Dexter® Torflex® Torsion Axles
- Sport Tires & Wheels w/TPMS Tire Pressure Monitoring System
- Treadlock RV Wheel Lock
- Roller Shades
- Key Alike Doors
- Hidden Cabinet Hinges
- Gas Griddle
- Spare Tire
- Power Tongue Jack

### OPTIONS

- Extra 200W Roof Solar Panel (N/A with Pro Rac)
- Tongue Mount Bike Rack
- Slide Topper
- Power Package (E19FD, E19FDS, E20BH, E20FBS Only)
- Pro Rac Mounting Bars (N/A E15FDG, w/Power Package or Second Solar Panel)

## EACH NEW FOREST RIVER PURCHASE PROVIDES:

- ✓ Pre-delivery Inspection.
- ✓ Free Membership to Forest River Owners Group (FROG). Learn more at [www.forestriverfrog.com](http://www.forestriverfrog.com).
- ✓ A Contribution to Care Camps Foundation [www.carecamps.org](http://www.carecamps.org).
- ✓ 1 Year Free Roadside Assistance from Date of Purchase.
- ✓ Digital Owner's Manual.



### LEARN MORE:

Scan this QR code with your mobile device to learn more about Forest River.



## SPECIFICATION DEFINITIONS:

Scan this barcode using a QR reader on your smartphone to learn RV terminology and more!



YOUR **FLAGSTAFF** DEALER

All information contained in this brochure is believed to be accurate at the time of publication. However, during any model year, it may be necessary to make changes to the manufacturing process of the units and information in this brochure. Your unit may differ from the information in this brochure due to any changes in the manufacturing process and equipment. Forest River, Inc., reserves the right to make all such changes without notice, including prices, colors, combinations, materials, equipment and specifications of any model as well as the addition of new models and the discontinuance of models shown in this brochure. Therefore, please consult with your Forest River dealer and confirm the availability of any materials, combinations, designs, or specifications that are meaningful to your purchase decision. © 2024 Flagstaff, a Division of Forest River, Inc., a Berkshire Hathaway Company. All Rights Reserved. Forest River, Inc. 12/24