

CHER^{KEE}

BLACK LABEL FIFTH WHEELS



BLACK LABEL FIFTH WHEELS

CHER^{KEE}

FOREST RIVER

LEAD THE PACK.

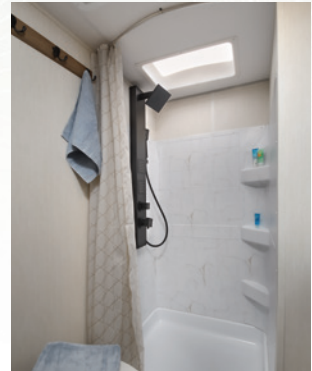

255SBBL

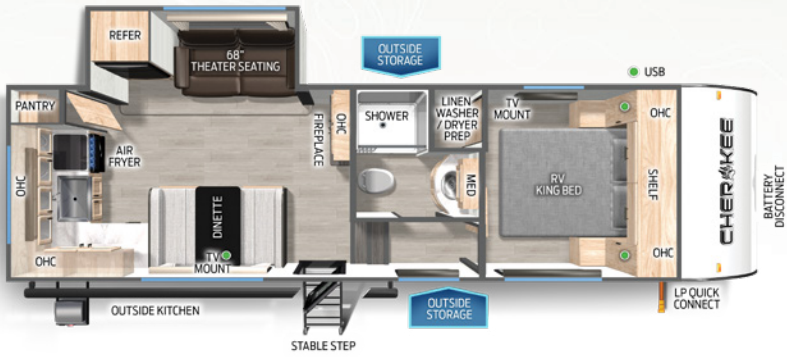

256RRBL

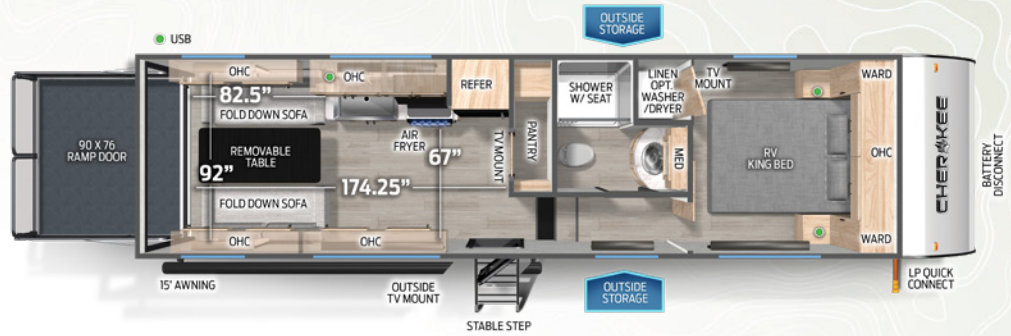

265GDKBL

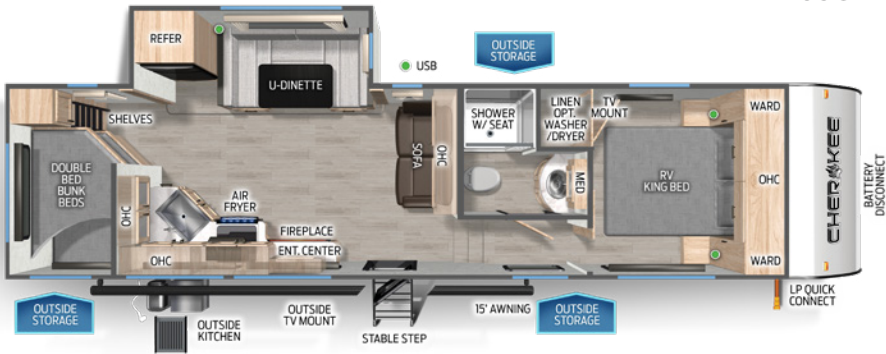

265SBBL



295SBBL



CHEROKEE

	255SBBL	256RRBL	265GDKBL	265SBBL	295SBBL
Dry Hitch Weight	TBA	1430-LBS.	1350-LBS.	1340-LBS.	TBA
Ship Weight	TBA	7070-LBS.	7890-LBS.	7735-LBS.	TBA
Unloaded Vehicle Weight	TBA	7108-LBS.	7928-LBS.	7773-LBS.	TBA
Cargo Carrying Capacity	TBA	4522-LBS.	2072-LBS.	3767-LBS.	TBA
Axle Weight	TBA	5640-LBS.	6540-LBS.	6395-LBS.	TBA
Exterior Length	TBA	30' 7"	33' 4"	30' 6"	TBA
Exterior Height w/A/C	TBA	12'-10"	12'10	12'-10"	TBA
Exterior Width	TBA	8'	96"	8'	TBA
Grey Capacity	TBA	38-GAL	38-GAL	38-GAL	TBA
Black Capacity	TBA	38-GAL	38-GAL	38-GAL	TBA
Fresh Capacity	TBA	40 GAL	40 GAL	52-GAL	TBA



BLACK LABEL FIFTH WHEEL FEATURES

LIMITED PACKAGE

50 Amp Service
 Washer & Dryer Prep
 Theatre Seat *Where Available
 12 V, High Efficiency, 10 Cubic Foot Residential Refrigerator w/ Travel Lock
 Chef Select Black Stainless Steel Kitchen Suite Package
 Super Kitchen
 Seamless Countertops
 Matte Black Heavy Duty Spring Assisted Kitchen Faucet Sprayer
 Residential Farm Style Black Stainless Steel Sink
 Fireplace * Where Available
 Premium Bedding and Comforter
 Upgraded Sofa with Bolster Arm Rests
 Supersized Central Air Conditioning Unit 15,000 BTU * Where Available
 USB-C Charging Stations
 Full Hybrid Tub with Shower Surround
 LED Interior Lights
 Light Filtering Sheet Shading Premium Blackout Zebra Blinds

RV King Bed * Where Available
 Bedside Inverter
 12 Volt Tank Heaters
 Exclusive Solar Thermo Controlled Reflective Tinted Safety Glass Windows
 Blackout Glass, Safety Slam, Friction Hinge Entry
 Door with Window and Shade Prep
 Cherokee Exclusive Stable Step with Oversized Landing
 Exterior LED Light Strip at Awning
 External Porch Scare Light
 Outside Kitchen * Where Available
 Premium Wheel Package
 Tire Pressure Indicators
 Spare Tire
 Four Stabilizer Jacks
 Ladder Prep
 Cherokee Backup Camera System
 Ramp Door Patio System
 * Toyhauler Models Only
 Removable Gaucho Brackets
 * Toyhauler Models Only
 Moonshade * Toyhauler Models Only

Adventure Package * Aggressive Off-road Tires, Diamond Plated Exterior & Lifted Frame-Toyhauler Models Only
 Juice Pack * 200W Roof Mounted Solar Panel, 30 Amp Solar Charger, Volt Meter & Battery Disconnect
 Power Gear Frame Technology and Space Saver Rail Design
 5/8" Tongue and Groove Plywood Flooring
 Seamless Roof Membrane with Heat Reflectivity-Walkable

CAMPFIRE PACKAGE

40" Dinette Drawers x 2 on Models with Slide Outs
 Tankless Water Heater
 Cabinets in Bedroom
 High Output Attic Fan in Bathroom
 Air Fryer
 Roof Mounted Ducted Air Conditioner
 * NA on models under 26'
 Skylight over Shower
 Solid Bedroom Doors * Where Available

BASE CAMP PACKAGE

Black Waste Tank Flush Out Kit
 Armored Underbelly Tank Enclosure
 Flip Down Travel Rack * NA on Toyhauler Models
 Large Exterior Folding Assist Grab Handle
 Outdoor Shower with Hot and Cold Water
 Outside TV Bracket and Hookups
 Power Awning
 RV Grill Quick Connect

BLACK LABEL PACKAGE

Automotive Style Frameless Windows Package
 High Gloss Gel Coated Fiberglass Exterior
 Upgraded Bedsread with Pillows
 Upgraded Bathroom Sink
 Upgraded Shower Head
 LG Solid Surface Countertops
 Reading Lights
 Designer Fabric
 Thermo-Foil Arctic Insulation

FREE MEMBERSHIP
 to Forest River Owners' Group



www.forestriverfrog.com



Learn More:
 Scan this barcode using a QR reader on your smart phone to learn more about Forest River.



A Berkshire Hathaway Company

WWW.FORESTRIVERINC.COM/CHEROKEE



PRE-DELIVERY INSPECTION FACILITY

20,000 square feet of quality assurance. The bare essentials for a premium product. This state-of-the-art facility gives immediate daily feedback to production for quality assurance in every unit built.



24/7 EMERGENCY ROADSIDE ASSISTANCE WITH VEHICLE PURCHASE*

TOWING
 JUMP-STARTS
 TIRE CHANGES
 FLUID DELIVERY
 LOCKOUT SERVICE

WINCH-OUT
 MOBILE MECHANIC
 TECHNICAL SUPPORT
 DEALER LOCATOR SERVICES



*VALID FOR 1 YEAR FROM DATE OF PURCHASE



VISIT US ONLINE

YOUR CHEROKEE DEALER



SPECIFICATION DEFINITIONS **GVWR (Gross Vehicle Weight Rating)** - is the maximum permissible weight of the unit when fully loaded. It includes all weights, inclusive of all fluids, cargo, optional equipment and accessories. For safety and product performance do NOT exceed the GVWR. // **GAWR (Gross Axle Weight Rating)** - is the maximum permissible weight, including cargo, fluids, optional equipment and accessories that can be safely supported by a combination of all axles. // **UVW (Unloaded Vehicle Weight)** - is the typical weight of the unit as manufactured at the factory. It includes all weight at the unit's axle(s) and tongue or pin and LP Gas. The UVW does not include cargo, fresh potable water, additional optional equipment or dealer installed accessories. *Estimated average based on standard build optional equipment. // **CCC (Cargo Carrying Capacity)** - is the amount of weight available for fresh potable water, cargo, additional optional equipment and accessories. CCC is equal to GVWR minus UVW. Available CCC should accommodate fresh potable water (8.3 lbs per gallon). Before filling the fresh water tank, empty the black and gray tanks to provide for more cargo capacity. ** Estimated average based on standard build optional equipment. Each Forest River RV is weighed at the manufacturing facility prior to shipping. A label identifying the unloaded vehicle weight of the actual unit and the cargo carrying capacity is applied to every Forest River RV prior to leaving our facilities. The load capacity of your unit is designated by weight, not by volume, so you cannot necessarily use all available space when loading your unit.