

YOUR GUIDE TO SUCCESS WITH THE NOVA CLASS B by COACHMEN RV – The Leader to the Great Outdoors!



The most comprehensive Class B Training Manual in the Class B segment!

Coachmen RV

LEADER TO THE GREAT OUTDOORS

DID YOU KNOW? COACHMEN RV PRODUCTS HAVE BEEN ON U.S. ROADS AND HIGHWAYS SINCE 1964!

- **COACHMEN RV...** Is built upon a simple principle “**Dedicated to the enrichment of your life.**” By providing you with long term value through all that we do, our focus is on delivering a product with superior value and backing it through superior service and support. Once you become a Coachmen owner, we are committed to enhancing your Coachmen RV ownership and lifestyle experience... creating friends for life and memories that will last a lifetime. At Coachmen RV you will find a rich history of commitment from our Team Members. This commitment extends to our owners and in the pride we have for our brand. The close relationship that we share with our owners and our dealers is a quality that others have been trying to mimic over our 50-year history. Our goals and principles remain well in focus. We create customers for life.
- **OUR HISTORY...**The first Coachmen RV products were manufactured in a 5,000 square foot plant in downtown Middlebury, Indiana, by Coachmen Industries, a company founded by three brothers: Tom, Keith and Claude Corson. Coachmen’s first year of production totaled 12 travel trailers, a single truck camper and 80 truck caps. Since then, over three quarters of a million Coachmen Recreational Vehicles have been produced and sold.
- **FOREST RIVER INC...**In December of 2008, Coachmen RV became a proud brand of Forest River, Inc., a Berkshire Hathaway company. Today, Coachmen RV, a division of Forest River, Inc., is headquartered in Middlebury, Indiana, with our primary manufacturing facilities occupying over 220 acres with more than 23 acres under roof serving as dedicated manufacturing facilities for Coachmen branded Class A Motorhomes, Class B Motorhomes, Class C Motorhomes, Fifth Wheels and Travel Trailers. Our Camping Trailers are manufactured in our Centerville, Michigan, manufacturing facilities occupying 90 acres.
- **A BRAND YOU CAN TRUST...**Coachmen RV products have been on North American roads and in North American campgrounds since 1964. With over five decades of building recreational vehicles. Over 600,000 RVs built and sold we know how to design and build a reliable RV with exceptional value, dependable design, practical innovation and the comforts and features you desire.

Ram ProMaster 3500 Gas Chassis



Warranties

Motorhome – 12 month/12,000-mile ltd.

Ram – 3 Year/36,000-mile Bumper to Bumper Warranty

Ram – 5 Year/60,000-mile Powertrain Warranty

Coachmen RV and Ram have combined their decades worth of experience to introduce NOVA, a Class B Motorhome that offers the utmost in quality, luxury and value. The NOVA is built on the award-winning Ram ProMaster 3500 Gas platform with a 3.6L Pentastar V6 Engine which delivers an impressive 280HP & 260LBS. of torque while still providing excellent fuel economy of 14-18 MPG on the highway.

NOVA uses high-end components like the Truma Combi Eco Plus furnace/water heater system, Marine Grade PVC wall covering, Front and Rear Sumo Spring Suspension and custom solid maple hardwood cabinetry!

NOVA: WHERE QUALITY AND VALUE ARE #1

Ram ProMaster Gas CHASSIS FEATURES

- 3.6L PENTASTAR V6 Gas Engine w/ 280 HP and 260 lb. ft. Torque
- 9-Speed Auto Transmission w/ OD
- MPG 14 City/18 HWY
- Front Wheel Drive
- Sumo Spring Front and Rear Suspension
- 24-Gal Fuel Tank
- 159" Wheelbase
- 195/75R 16 All Season Tires
- Brakes – 4 Wheel Disc w/ ABS
- 6 Airbags in the Cab
- HEAVY DUTY 220 AMP Alternator
- Single 100 amp 800 CCA battery
- 3 Year/36,000 Mile Bumper to Bumper Warranty
- 5 year/60,000 Mile Powertrain Warranty

NOVA FLOOR PLANS

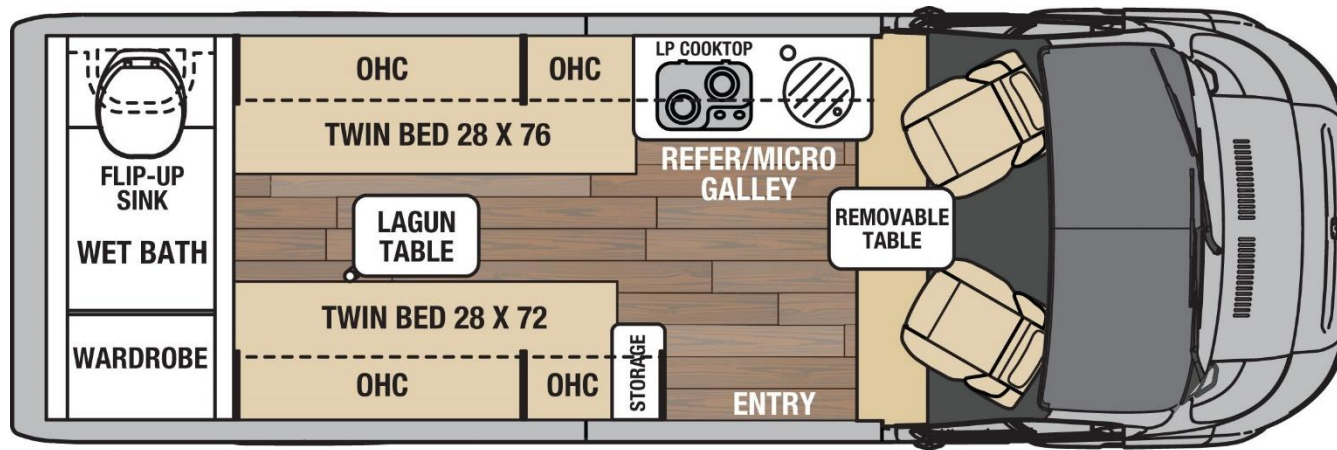

20RB NOVA



20RB
*Rear
Bath*

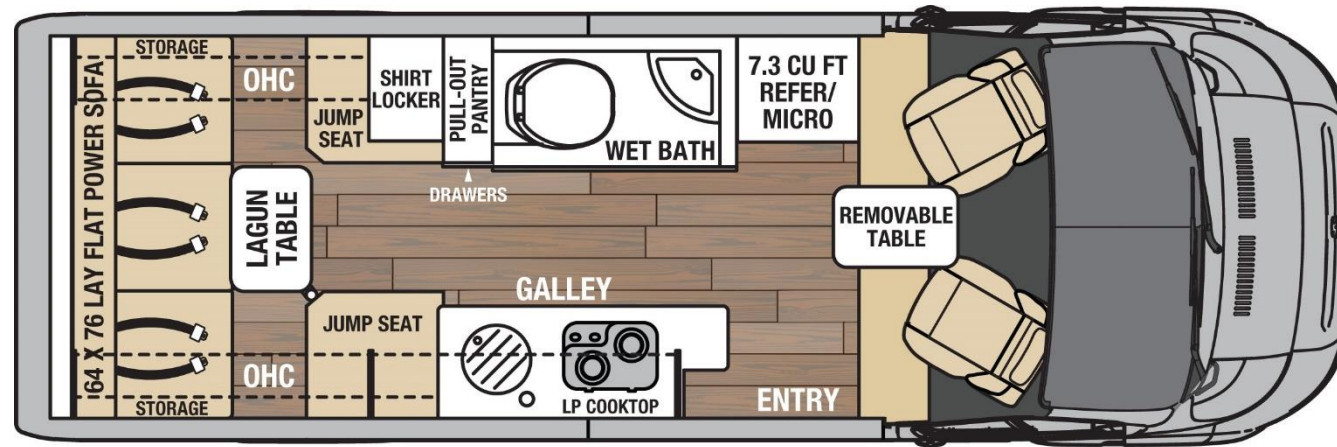

20C NOVA



20C
*Rear
Couch*

NOVA

By Coachmen

SPECIFICATIONS NOVA 20D

CHASSIS RAM PRO MASTER 3500 EXTENDED

WHEELBASE	159"
GVWR (LBS.)	9,350
GCWR (LBS.)	11,500
GAWR FRONT (LBS.)	4,629
GAWR REAR (LBS.)	5,291
FUEL CAPACITY (GAL.)	24
EXTERIOR LENGTH	20' 11"
EXTERIOR HEIGHT (WITH A/C)	9' 4"
EXTERIOR WIDTH	86"
FRESH WATER CAPACITY (GAL.)	27
GREY TANK CAPACITY (GAL.)	20
BLACK TANK CAPACITY (GAL.)	19
AWNING SIZE	13' 1"

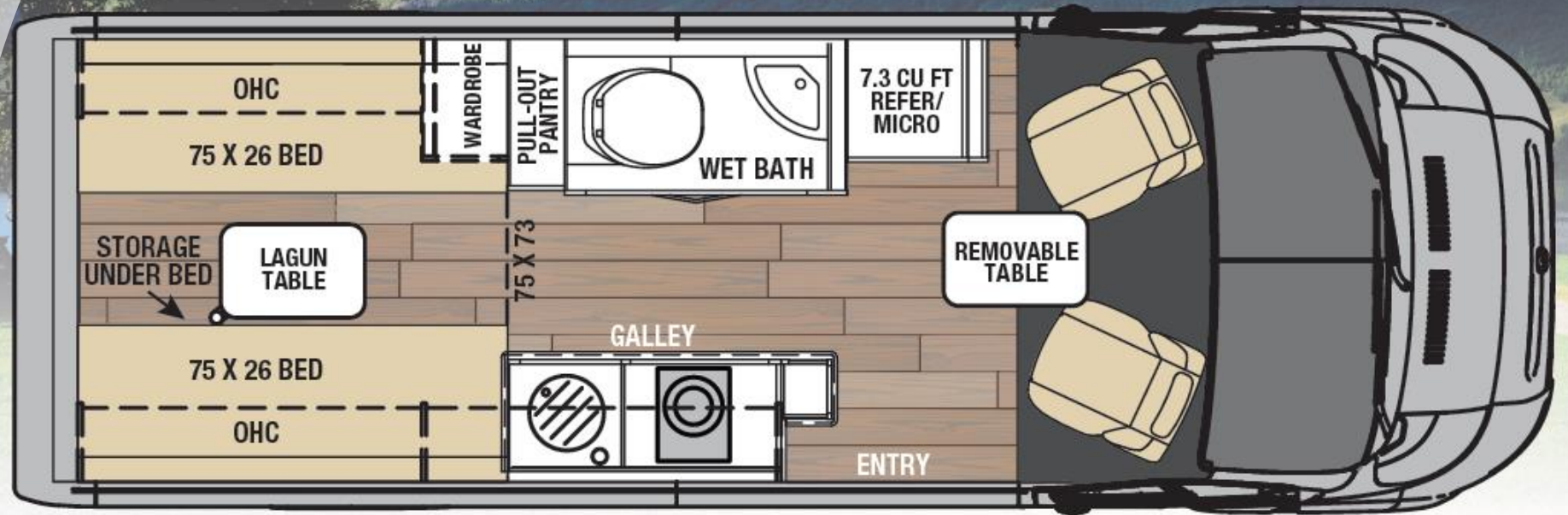

20D

KEY FEATURES

- Truma Aventa 13.5k A/C (Dehumidifier + Night Mode)
- Biggest Refer in a Class B w/ a Pull-out Freezer Drawer
- 3 Sleeping Configurations for Beds
- Massive Storage under Passenger-side Bed
- Industry-leading Insulation Package w/ Dual-pane Windows

NOVA COCKPIT FEATURES



Swivel Driver and Passenger Seats extend the living area all the way into the cab.



USB and USB-C, 12V, and 115V Outlets



Overhead Storage



Wireless Charging

Standard 10" Uconnect5 Touchscreen In-Dash Infotainment with Navigation, Apple CarPlay and Android Auto.



NOVA COCKPIT FEATURES CONT.



Fantastic amount of storage for all of your magazines, books, snacks, drinks, iPad's, etc. that you could ever need on your journey!



Battery Boost button allows you to "Jump" off the House batteries in the event your chassis battery dies.

Clipboard style clip to hold maps and papers.



CUSTOM HARDWOOD CABINETS-NO COMPARISON!

Unmatched Craftsmanship, High End Hardwood Materials, High End Residential Drawer Guides

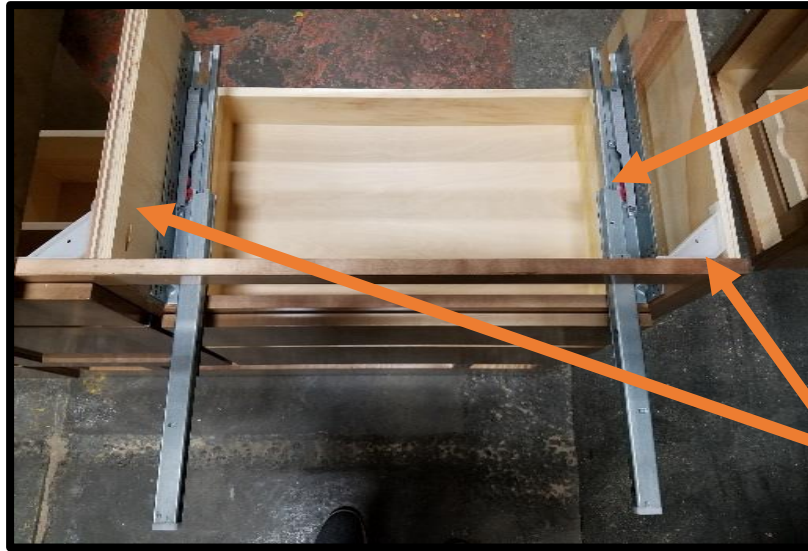

High End Residential Cabinet Components

- True Residential drawer guides. Not the cheap Travel Trailer 80lb. ball bearing drawer guides
- This drawer hardware will ensure your drawers will operate smoothly and hold up to the rigors of the road for the life of your coach.
- 7 Ply 5/8" DOMESTIC FURNITURE GRADE PLYWOOD-NOT FOUND IN THE RV SEGMENT!

True English Dove Tail drawer Construction

- 5/8" Western Aspen ENGLISH DOVE TAIL DRAWERS
- Superior construction and materials ensure your NOVA cabinetry will last vs. competitions cabinetry

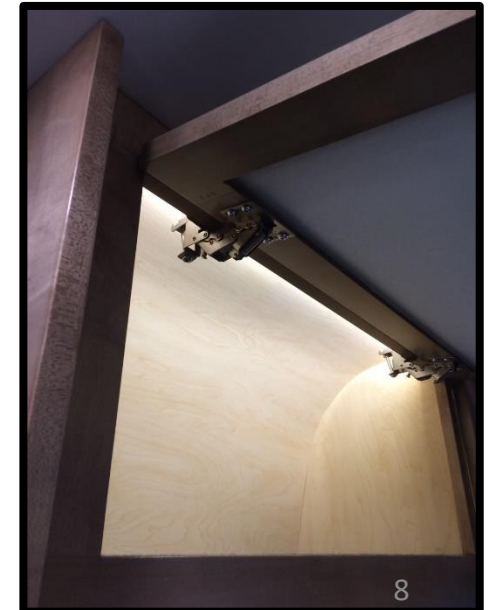

KITCHEN/CABINETRY/STORAGE-INDUSTRY LEADING CABINETRY QUALITY!



Unmatched Cabinetry Quality!

- ¾" Solid North American Maple Drawer Fronts
- Solid High Gloss Maple hardwood



Overhead Storage & Shirt Locker

- Solid Hardwood Cabinet Doors vs. Vinyl Wrap Stiles or Vinyl Wrapped MDF Doors
- Translucent Inserts Provide Accent Lighting from inside overhead cabinet.
- Felt Lined over head cabinet bases
- Shirt Locker has Pre-Hung Closet Bar and Removable Shelves
- Soft Close Overhead Doors
- All High Gloss Maple Finish
- Unmatched Quality



Trash Can Storage

- Every NOVA has dedicated trash can storage in the kitchen base cabinet
- Also has additional storage for paper towels and trash bag boxes.
- Very residential

NOVA KOOL COMPRESSOR DRIVEN REFRIGERATORS

20RB



Nova Kool R3800 Compressor Driven Refer-3.5 CF

- Compressor Driven
- Operates @ 30 DEGREE INCLINE-Great for Class B end users!
- Runs on 12V
- The only refrigerator to be endorsed by Canadian Coast Guard
- Designed for Mobile and Off The Grid Applications
- Over 25 Years in business!
- Whisper Quiet
- Low Power Consumption
- Reversible Door Swing
- Backed with Nova Kool's 2-Year Warranty
- Environmentally sound 134a refrigerant.

NOVA KOOL COMPRESSOR DRIVEN REFRIGERATORS

20C and 20D



Nova Kool RFU7300D Compressor Driven Refer-7.3 CF

- Compressor Driven
- Operates @ 30 DEGREE INCLINE-Great for Class B end users!
- Runs on 12V
- The only refrigerator to be endorsed by Canadian Coast Guard
- Designed for Mobile and Off The Grid Applications
- Over 25 Years in business!
- Whisper Quiet
- Low Power Consumption
- Reversible Door Swing
- Backed with Nova Kool's 2-Year Warranty
- Environmentally sound 134a refrigerant.

NOVA BATHROOM-MORE FUNCTION vs. COMPETITION



- 27x44" All FIBERGLASS shower enclosure. NOT plastic or ABS
- Mirror that opens to Medicine Cabinet
- Porcelain Toilet NOT Plastic
- Toothbrush Holders
- Largest Drop-Down Sink in its class maximizes space
- Wrap Around Shower Curtain and Antimicrobial Pocket Door
 - Towel Hook
- Pull-Down Fantastic Fan



NOVA 20C POWER SOFA/POWER BED-TRUE COMFORT IN STYLE!

INDUSTRY FIRST TRUE “LAY FLAT POWER SOFA”

- **Lay Flat Sofa Dimensions 68”W x 76”L**
- **Largest Sleeping Available in the Gas Class B segment!**
- **True 180 degree LAY FLAT SOFA**
- **NO HUMPS / NO GAPS**
- **3 Inches of Increased Memory Foam**
- **3 Seat Belts and 2 Arm Rests**
- **2 Cup Holders Next to Sofa**
- **Built in Headrest for Additional Passenger Comfort**
- **All Furniture Material Rated @ 7 YR. Hydrolysis**
- **Easy to Maintain and Easy to Clean**

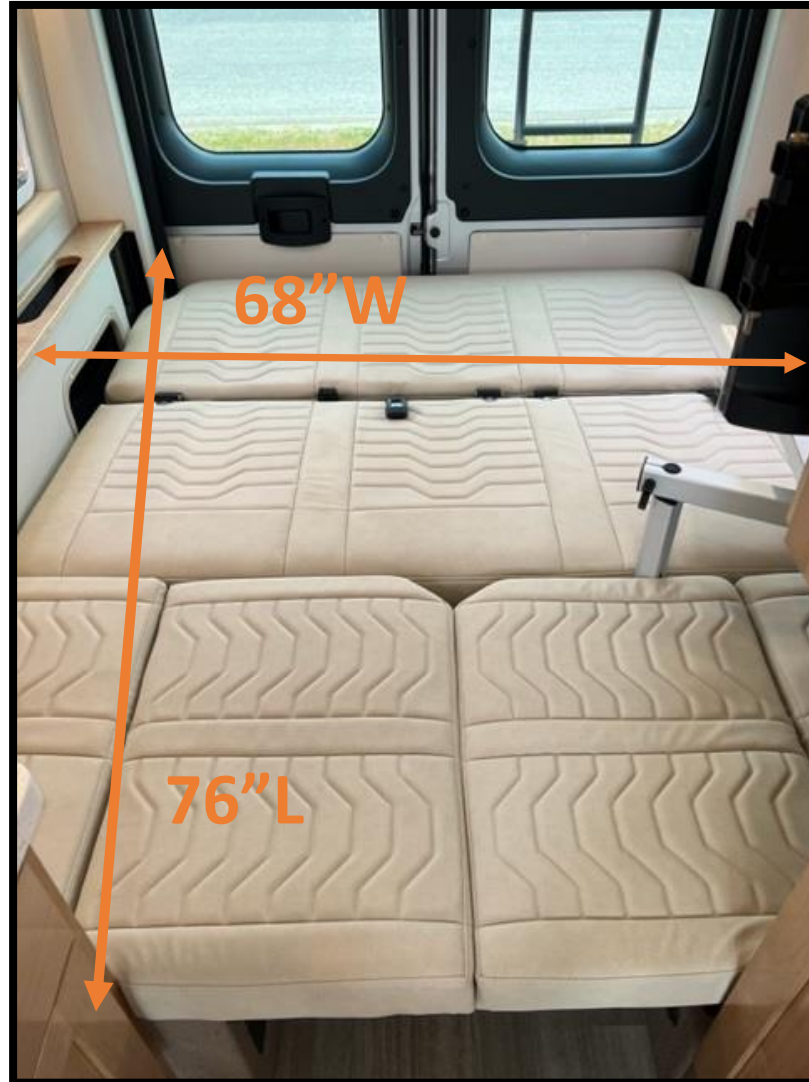

NOVA 20RB FEATURES



Both Captain's chairs rotate to expand living space.



20RB Individual Twin Beds. Memory Foam 28x72 twin cushion on driver side and Memory Foam 28x76 twin cushion on passenger side. Complete with (2) Backrest/Pillow rest cushions.



Standard Microwave and In-floor storage and table mount.



Ample Storage from rear of coach

Nova 20D Features



Ample storage under passenger side bench



Modular slot design allows you to place bed and benches in multiple configurations

Full pass-through rear entry allows for storage of larger items.



TABLE SET UP ON NOVA

20RB TABLE SET UP



20C TABLE SET UP



Lagun Table

- Use as a workstation or dinner table
- Lightweight
- Highly adjustable and easy to move.

CONTROL PANEL LAYOUT AND FEATURES

Xantrex Freedom X Remote Panel-Allows you to control and monitor your 2000W Xantrex Pure Sine Wave Inverter

Solar Disconnect

Battery Disconnect



Wi-Fi Ranger On/Off

Go Power Solar Charger

MULTI PLEX TOUCH SCREEN CONTROL...
TANK LEVELS, AUTO GEN START,
INTERIOR/EXTERIOR LIGHTING

Truma CP Plus Control for
Truma Combi Eco Plus and
Truma Aventa 13.5 A/C

FIREFLY MULTI PLEX WIRING-CONVENIENCE!



- Control all coach lighting from the push of a button
- No more searching for light switches
- Customer can set the lighting to their preferences inside the coach
- While Multi-Plex Wiring is beneficial for convenience this technology cuts down on the amount of wire used and connections vs. a coach without Multi-Plex wiring

- Select the POWER setting and you will find the AGS or Auto Gen. Start
- This function allows you to pre-program your generator run time and your generators quiet time
- **The Auto Gen Start function also allows the customer to pre-program the generator to Auto Start at the customers desired temperature. This feature is great for those that travel with pets and must leave them in the coach without the worry of their pets getting too hot**
- The Auto Gen Start function also allows the customer to pre-program the generator to start if the coach batteries voltage draws down to a certain level
- All the above are customizable to your customers needs and camping preferences



- Convenient 2nd Multi-Plex Control panel (Coach Lighting Only) in rear of coach
- No more searching for light switches in the middle of the night

NOVA SOLAR PANELS



SOLAR FLEX™



12V/30AMP DIGITAL SOLAR SINGLE STAGE CONTROLLER

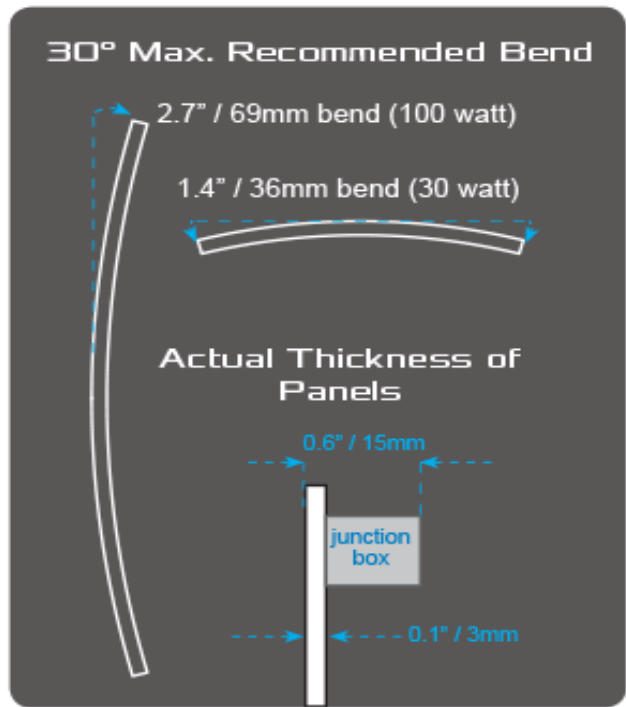

220 W Standard w/ port to add additional solar

SOLAR FLEX SOLAR PANELS FEATURE A 5 YEAR WARRANTY

SAFE SIMPLE SECURE

NO TWISTING! - SELF CLEANING PUSH-IN DESIGN



30 AMP INLET & PLUG FEATURES

LED POWER INDICATOR

Two blue LEDs illuminate indicate an active power source.

LOCKING FEATURE

Dual locking side levers snap into sides of inlet housing.

WEATHERPROOF

Face gasket seals.

LOCKING FEATURE

Inlet cover snaps onto back of connector.

EASY INSTALLATION

Industry standard hole pattern fits your existing inlet hole pattern.

ELECTRICAL PINS

Straight pins with 20X surface area. No twisting required!

CONNECTOR BODY SHAPE

Sleeve design fits snugly within inlet, removing all tension from pins & clips.

WEATHERPROOF

Face gasket seals against inlet sleeve to eliminate dirt & moisture exposure on electrical pins.

EASE OF USE

Unique plug body shape only goes in the right way! Easy to orient with no misalignment - even in the dark! Pushes straight in & locks automatically.



SmartPlug[®]
Inlet and Plug is
Standard on all
Coachmen
Class B's!

TRUMA COMBI ECO PLUS FURNACE / HOT WATER HEATER



Truma Combi Eco Plus – The first forced-air combination furnace with integrated water heating function and with more than 20 years of reliable service in Europe and Australia. Truma Combi furnaces are the most energy-efficient and lightest heating systems on the market. They effectively combine warm air and hot water in one appliance. Truma Combi furnaces offer much more operating convenience by way of the digital control panel Truma CP plus.



Unique Features

- Near-silent operation
- Lightweight, space-saving solution
- Maintains constant temperature throughout RV
- Optional electric heating for furnace and water
- Highest available energy efficiency of more than 90%
- Program your timer to have hot water ready.

Be sure to let your customers know there are many videos available on YouTube on the operation of the Truma CP PLUS

TRUMA COMBI ECO PLUS FURNACE / HOT WATER HEATER

Truma Combi

Quick Reference CP Plus Functions



ADJUST ROOM TEMPERATURE

Range: 40-86°F (5-30°C)



SELECT ENERGY MODE

- a) LP gas
- b) MIX 1* - Electricity 850W + Gas
- c) MIX 2* - Electricity 1700W + Gas
- d) EL* - Electricity 850W
- e) EL* - Electricity 1700W

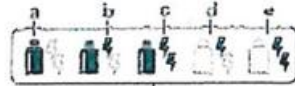

ADJUST WATER TEMPERATURE

A) BOILER

Hot water generator is on. Icon flashes until desired temperature is reached.

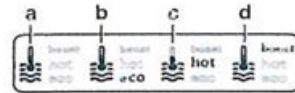

B) ECO

Water temperature is 104°F (40° C)

C) HOT

Water temperature is 140°F (60° C)

D) BOOST

Boiler content is heated quickly (boiler priority) for up to 40 minutes. The water temperature is then kept at the higher level (about 144° F (62° C) for two subsequent heating cycles. When the water temperature is reached, the room is heated again.



Truma Combi

Quick Reference CP Plus Functions - Cont.



SET CLOCK TO CURRENT TIME



SET TIME SWITCH

Set a start time and end time for room temperature, water temperature, energy mode and fan speed set points.



SETTINGS

- Index - Show version number of connected device
- Bright - Adjust backlighting
- Lang - Adjust language
- 12-24h - 12/24 hour mode
- Temp - °F or °C
- Offset - Calibrate temp offset
- Pr set - Factory reset



SELECT FAN SPEED

OFF

Fan is switched off (If furnace mode OFF)

A) VENT

Circulating air (If furnace mode OFF)

B) ECO

Low fan speed

C) HIGH

High fan speed

D) BOOST

Fast room heating. Available if the difference between the selected and current room temperature is >18° F (10° C)

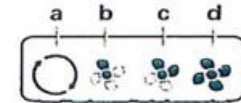

www.truma.net
1-855-558-7862 ext.1

truma
More comfort on the move

Onan QG 2800i Gasoline RV Generator



Cummins Onan RV QG 2800i (formerly Onan Microlite) Lightweight, Compact and Quiet RV Generator. Microprocessor control with diagnostics and lightweight, compact design. Quietest generator sets of their size. Easy maintenance with single-side service. Completely enclosed with muffler, quick and easy to install. 3-year limited warranty, Low fuel consumption, The RV QG 2800i is a 2800-watt gasoline generator.

- Microprocessor control with diagnostics and lightweight, compact design.
- Gasoline fueled.
- Quietest generator sets of their size.
- Easy maintenance with single-side service.
- Completely enclosed with muffler, quick and easy to install.
- 3-year limited warranty
- Low fuel consumption
- 2.8kW QG RV generator set will start and run one 13500 Btu high efficiency air conditioner (15.5 amps or less) plus 600-watt base load with an additional 300 watts of power available.

Warranty policy: This limited warranty covers virtually everything except routine maintenance for the first two years you own your RV generator set and covers parts and labor on major powertrain and generator set parts during the third year. In addition, it also includes a free 90-day adjustment policy, which provides that Cummins Inc. will make minor adjustments during the first three months you own it - free of charge! Please note: This 3-year limited warranty applies to RV generator sets used in RV applications only, and does not apply to RV generator sets used in commercial mobile applications

ONAN RV QG 2800i Gas Generator Info.

ONAN RV QG 2800i Gas Generator

Microprocessor control with diagnostics and lightweight, compact design

- Gas Fueled
- Quietest generator sets of their size
- Easy maintenance with single-side service
- Completely enclosed with muffler, easy to install
- 3-year limited warranty
- Low fuel consumption

OIL/DIPSTICK

MANUAL START SWITCH w/CIRCUIT BREAKER BELOW

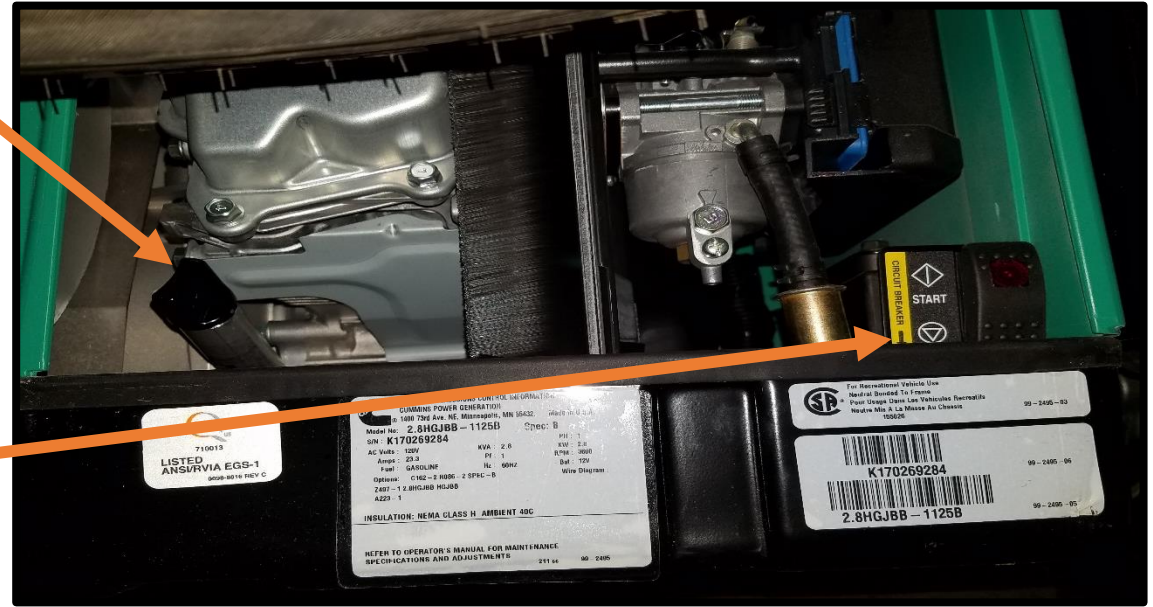

GENERATOR FEATURES • Cummins Onan sound-attenuating enclosure • Focalized mounting system with vibration isolators • Cross-flow cooling • Sheet steel drip controlling base • Enclosed muffler • Integral USDA Forest Service approved spark arrestor muffler • Adjustable mechanical governor • Automatic choke • Overhead cam • Single-side service • Low oil level shutdown • Electric fuel pump (gasoline) • Mounted control panel • Sealed remote start connector • Electric start • Fused DC circuits to protect set wiring and remote control wiring • Magnetic circuit breaker • Solid-state ignition • Standard onboard diagnostic capability

!!!CUSTOMER SERVICE TIP!!!
MAKE SURE TO TELL CUSTOMERS WITH GENERATORS THAT THEY NEED TO FIRE UP THE GENERATOR APPROX. 1 X PER MONTH TO ENSURE PROPER FUNCTIONING!!!

XPEDITION BATTERIES 330AMP HOUR AGM BATTERY



Xpedition Batteries XP8D-330 AGM Deep Cycle, maintenance-free batteries, are designed to provide premium performance!

READY WHEN YOU ARE: Xpedition AGM Deep Cycle Batteries are deep cycle batteries that deliver high capacity from the get-go. Unlike traditional lead-acid batteries that need to be “worked up” to increase capacity, these batteries give you the range or hours of operation you need right away.

HIGH PERFORMANCE IN LOW TEMPERATURES: Batteries don’t like cold temperatures, but Xpedition AGM Deep Cycle batteries deliver more capacity than traditional lead-acid batteries, even in extreme conditions.

FORGET ABOUT ACID: No need to worry about spills or acid-residue. You’ll never need to replace a corroded chassis or damaged floors due to acid spillage.

SAVE WATER AND WORRY: Using your batteries in a remote location? Is your access limited? Maintenance-free Xpedition AGM Deep Cycle batteries are perfect for applications where watering is easily neglected or very inconvenient. Traditional lead-acid batteries are subject to reduced performance or early failure if not watered regularly.

LOW SELF-DISCHARGE: Xpedition AGM Deep Cycle batteries are the ideal solution for infrequent or seasonal use since self-discharge is significantly less than traditional lead-acid batteries. Less frequent, if any, charging is needed during storage.

WE DON’T PASS GAS: Non-hazardous, clean Xpedition AGM Deep Cycle batteries emit no gasses during normal operation. They can be used safely near sensitive equipment or people.

INSTALLATION SENSATION: Thanks to their innovative design, Xpedition AGM Deep Cycle batteries can be installed upright or on their sides, making for flexible installation options in a variety of applications.

AGM 330AMP HOUR 8D BATTERY

- 8D 330AMP HOUR BATTERY DIMENSIONS: 20.8”x 11.1”x 9.8”
WEIGHT:182LBS
- 1 YEAR WARRANTY
- Power to ALL 110V outlets when coupled with our Standard Xantrex 2000W Pure Sine Wave Invertor without needing the generator
- Located under the rear of coach on the passenger side

NOVA MULTI-PLEX SYSTEM



Multi-Plex Panel Located Right as you Enter/Exit
Individually Controls All Lighting Zones (2)
Locations, Controls AGS / No Switches to Search
For!



2nd Multi-Plex Panel at Head of Bed
for Easy Access to All Lighting
Functions while Sleeping

COMPONENTS ON NOVA CONTINUED...



PULL DOWN BUG SCREEN



Standard Screen Door w/ Grab Handle and Motion Sensor/Security Light at Step.

User Tip: Always Use Teflon Spray Lubricant on the Screen Door Tracks. Never Use Silicone Spray!

CONSTRUCTION AND INSULATION MATERIALS CONTINUED.....

CHASSIS FLOOR/UNDERLAYMENT/FLOOR DECKING/INSULATION

RAW CHASSIS

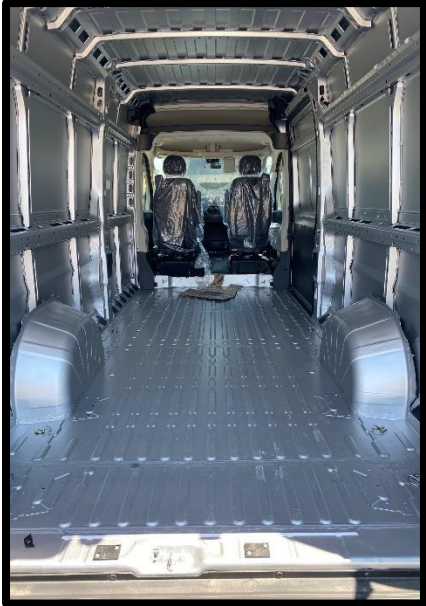

1st STEP SOUND REDUCTION

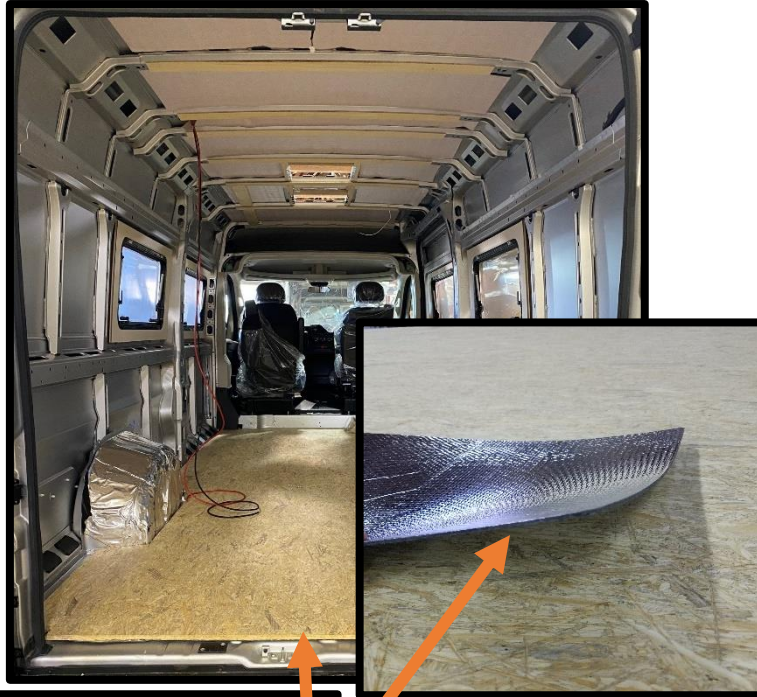

ADDITIONAL SOUNDS DEADENING MAT UNDER OSB

- R-38 REFLECTIVE INSULATION LAMINATED TO UNDERLAYMENT
- REFLECTS THE HEAT AWAY IN SUMMER AND KEEPS THE HEAT IN FOR WINTER
- KEEPS ROAD VIBRATION AND SOUND TO A MINIMUM!

ONE PIECE 5/8" MARINE GRADE OSB FLOOR

- OSB Covers front to back and left to right
- No seams that will give way during the life of the chassis

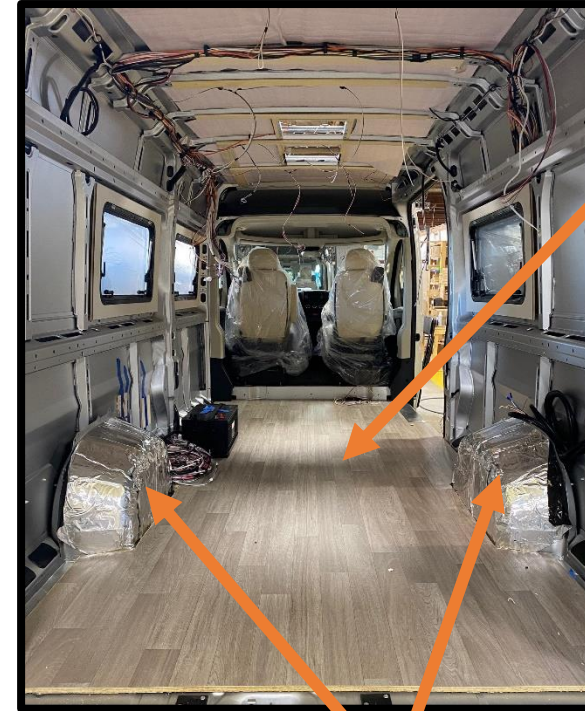

HUSHMAT WHEEL WELL INSULATION/SOUND DAMPENING

- DRASTICALLY REDUCES SOUND and VIBRATION FROM THE ROAD
- ONE OF THE OLNY CLASS B MANUFACTURER USING HUSH MAT

NOVA INSULATION! STANDARD IS ROCKWOOL



STANDARD INSULATION:
ROCKWOOL

INDUSTRY FIRST MARINE GRADE PVC SIDEWALLS

ADDED VALUE!!!

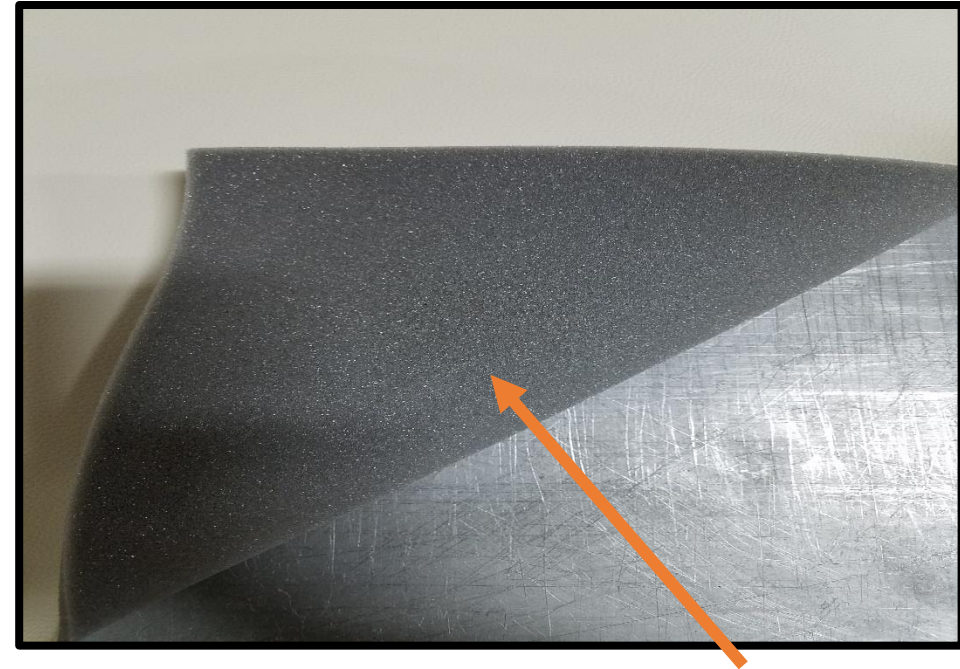

Marine Grade PVC Vinyl Interior Sidewall

- Will Never Absorb Moisture Like Cloth
- Will Never Absorb Odors Like Cloth
- Will Never Crack or Rattle like ABS
- Will Never Break Down
- Will Last Forever!
- Foam Backer for Added Insulation and Sound Deadening!

COMPONENTS ON NOVA CONTINUED

WATER MANAGEMENT AREA

**SATELLITE
CONNECTION**

**BLACK TANK
FLUSH
CONNECTION
VALVE**

**NOTE:DO NOT
LEAVE YOUR HOSE
CONNECTED TO
BLACK TANK FLUSH
FOR LONG PERIODS
OF TIME OR YOU
WILL OVER FILL
YOUR BLACK TANK**



**CITY WATER
CONNECTION FOR CITY
WATER HOOK UP**

**FRESH WATER FILL TO FILL
FRESH WATER TANK**

COMPONENTS ON NOVA CONTINUED...

OUTSIDE SHOWER and SOLAR PORT

Solar Quick-Connect Port to add additional Solar



30-Amp Shore Power

Outside Shower with Quick Disconnect

COMPONENTS ON NOVA CONTINUED...



BACK UP CAMERA

- Back Up camera- SAFETY FEATURE!



CAREFREE OF COLORADO AWNING

- STANDARD 13' (157") Electric Awning
- Seismic Sensor feature will retract awning automatically in windy conditions
- No Legs to attach to side of coach
- 1 YEAR WARRANTY

Passenger Side Walk-Around

1. Re-enforced entry step with undercarriage L.E.D lighting
2. Sumo Spring Assist Suspension Front and Sumo Spring Rear Leaf Spring Suspension
3. Optional Firestone Wheel & Tire Package (Shown)
4. External 110v outlet (GFI Reset Location)
5. Carefree armless power awning w/ LED lighting and wind sensor
6. Dual-Pane Acrylic Awning Windows w/ Integrated Screens and Solar Reflective Shades.



NOTES:



Drivers Side Walk-Around

1. **Termination Valve and Grey Tank Valves**
2. **30 AMP SmartPlug® Inlet**
3. **Standard Roof rack w/ 290 lb. capacity.**
4. **Dual-Pane Acrylic Awning Windows w/ Integrated Screens & Solar Reflective Shades**
5. **Truma Aventa 13.5 BTU A/C**
6. **Go Power! 220 Watts of Solar (2 110-Watt Panels)**
7. **Onan Gas Generator Exhaust**
8. **Standard Rugged Entry Step**
9. **Black Tank Valve**

NOTES: _____

NOVA STANDARD FEATURES



STANDARD: CAREFREE POWER AWNING



STANDARD: REAR SCREEN DOOR



STANDARD: SIDE SCREEN DOOR



STANDARD: DAY/NIGHT PULL DOWN PRIVACY SHADES



STANDARD: INDUCTION SINGLE BURNER STOVE TOP (2 YR. WARRANTY)



STANDARD: MICROWAVE



STANDARD ALLOY WHEELS WITH ALL-WEATHER TIRES

NOVA STANDARDS CONT.



STANDARD FRONT AND SIDE WINDOW COVERS

Firefly Integrations SureLevel Tank Monitoring System

The SureLevel tank monitoring system is a pressure sensor that provides precise fluid level readings.

- Displays Tank Level in 10% Increments
- Accurately Reads Odd-Geometry Tanks
- Automatically Adjusts to Tank Expansion or Warping
- Quick and Easy Installation
- Read Tank Levels with Your Mobile Device*

*Firefly mobile device integration is required for this feature

The advertisement features the Firefly Integrations logo at the top left. The main title is 'SureLevel Tank Monitoring System'. Below the title is a photograph of the SureLevel sensor, a black device with a yellow top. To the right of the sensor is a list of five bullet points describing its features. At the bottom, there is a hand holding a smartphone displaying the SureLevel mobile app interface, which shows various vehicle metrics like temperature and battery level. A QR code is located in the bottom right corner.

NOVA OPTIONS



OPTION: Driver & Passenger Upgraded Seat Covers



Optional 630ah or 1260ah Lithium Systems!



OPTION:UPGRADED Firestone Tire & Wheel Package

OPTION: 12-Volt Tank Heaters for Grey Tank

CABINETS	
<i>High Gloss Cherry</i>	
<i>High Gloss White</i>	
<i>High Gloss Maple</i>	
DECOR	
<i>Cashmere</i>	<i>Fog</i>



STANDARD:LP COOKTOP

Vegatouch Mira



Local app control on
iPhone/iOS and Android Devices.

Download Mira!



NOVA

By Coachmen

Ram Pro-Master Class B Brand Comparison

	Coachmen NOVA	Winnebago TRAVATO	Thor TELLARO	Thor SEQUENCE	Entegra ETHOS	Jayco SWIFT	Roadtrek ZION	Roadtrek PLAY
Rockwool R-15 Insulation	✓	X	X	X	X	X	X	X
Cozy Wrap Insulation	✓	X	X	X	X	X	X	X
Hush Matt over Wheel Wells	✓	X	X	X	X	X	X	X
Marine Grade Wall Vinyl w/ Foam Backing	✓	X	X	X	X	X	X	X
Dual Pane Acrylic Awning Style Windows Standard	✓	X	X	X	X	X	X	X
Laminated Heat Reflective Shield Beneath Floor	✓	X	X	X	X	X	X	X
Solar Reflective Pull Down Window Shades	✓	X	X	X	X	X	X	X
100% Real Hardwood Cabinets	✓	X	X	X	X	X	X	X
English Dovetail Drawer Construction	✓	X	X	X	X	X	X	X
100% Hardwood Styles	✓	X	X	X	X	X	X	X
2000W Pure Sine Inverter Standard	✓	X	X	X	X	X	✓	✓
7.3 Cubic ft Refer w/ Pull-out Freezer Drawer	✓	X	X	X	X	X	X	X
Truma Aventa 13.5k A/C	✓	X	X	X	X	X	✓	✓
220W Solar w/ Flex Panels	✓	X	X	X	X	X	✓	✓
Fresh Tanks Inside	✓	X	X	X	X	X	✓	✓
Black Tank Inside	✓	X	X	X	X	X	✓	✓
630 AH Lithium System Inside the Van and 2nd Alternator (280 amp) for Quick Charging the Lithium Battery (1260AH Optional 20C, 20D)	✓	X	X	X	X	X	X	X
Spice Rack/Paper Towel Holder/ Trash Can/ Plate Dryer in Sink cover	✓	X	X	X	X	X	X	X
Upgraded Tank Sensors	✓	X	X	X	X	X	X	X
0-Foam Upgraded Sofa/Bed Cushions	✓	X	X	X	X	X	X	X
Window Shades/Screens are in a Track System so they Do Not Rattle	✓	X	X	X	X	X	X	X
Much Larger Bathrooms	✓	X	X	X	X	X	X	X
Porcelain Toilet	✓	X	X	X	X	X	X	X
Convection/Airfryer Microwave Combo	✓	X	X	X	X	X	X	X
More Drawers in Every Layout	✓	X	X	X	X	X	X	X
30 Amp Smart Plug	✓	X	X	X	X	X	X	X



423 N. Main Street - P.O. Box 30 - Middlebury, WI 54654

To learn more about Coachmen RV and our products and see how Coachmen is making the easy life easier, call us toll free at (800) 363-7783, or visit www.coachmenrv.com



All information contained in this document is subject to the accuracy of the time of publication. Coachmen, its subsidiaries and its dealers do not warrant, represent or guarantee the accuracy, completeness or reliability of the information contained herein. Coachmen, its subsidiaries and its dealers are not responsible for any errors or omissions in this document. Coachmen, its subsidiaries and its dealers are not responsible for any damages, including consequential damages, arising from the use of this document. ©2022 Coachmen RV. All Rights Reserved.

NOVA Safety and Convenience



Every NOVA includes the following for your protection

- **LP Leak Alarm:** Alerts you if there is an LP gas leak in the coach.
- **Fire Extinguisher:** ABC rated in the event of fire.
- **Smoke Detector:** Alerts you about smoke from a fire.
- **Carbon Monoxide Detector:** Alerts you to the presence of odorless carbon monoxide gas.
- **Coachmen's Travel Easy Roadside Assistance:** Provides 24/7 Operational, technical and emergency road service coverage.
- **System Control Center:** Allows you to monitor all your LP, Generator and Water Tanks from one easy and convenient spot inside the coach.

FOREST RIVER CARE TECHNICAL AND ROADSIDE ASSISTANCE BENEFITS

Providing safety and convenience for RVers and their families while on the road.

Forest River Care Roadside Assistance is provided to you by Forest River Inc. and powered by Specialized Dispatch Services, LLC. Your provided, first year of coverage includes emergency roadside assistance services such as towing, winch-out, jump-starts, tire changes, technical support, and more. Benefits and services are available to you for your new Forest River RV or when you are towing your new Forest River RV (does not cover additional vehicles or RVs). Learn more about **Forest River Care Technical and Roadside Assistance's** services and features below.

Towing

Towing your RV or the Tow Vehicle when towing your RV, to the nearest qualified repair facility.

Jump Starts

Jump-starting vehicles' dead batteries or towing vehicles to qualified repair facilities.



Tire Assistance
Changing flat tires using a mounted and inflated spare tire, delivering comparable tires to disablement sites, or towing vehicles to a tire facility. The cost of a delivered replacement tire, alignment, mount and dismount, and balancing is

not covered. Customers are responsible for all charges related to on-site repairs, including but not limited to parts and labor costs.

Delivery of Fuel and Emergency Fluids Delivering fuel, oil, and water, as necessary, to remedy disablements. Customers are responsible for the cost of fluids.

Locksmith/Lockout Service

Providing locksmith services, opening locked vehicles, and/or obtaining replacement keys. Customers are responsible for all charges related to on-site repairs, including but not limited to parts and labor costs.

Winch Out

For RVs that can be accessed from an established, maintained road, highway, thoroughfare, or street.

Mobile Tire Service

In the event of a tire-related breakdown, a mobile tire service company may be dispatched to mount a like tire to the customer's vehicle. Mobile tire service is not available in all areas. Towing to the nearest qualified repair facility will be provided if mobile tire service is not available. Customer responsible for all parts and labor fees.

Technical Support

Features 24/7 technical assistance from our staff of RVIA/RVDA and ASE Certified Technicians, who speak directly with customers to troubleshoot operational issues. Should you need emergency roadside assistance, our vast network of providers offers a wide range of services to handle their unique RV.



RV Mobile Mechanic

Dispatching of a mechanic to the site of mechanically-disabled vehicles. Customer is responsible for all charges related to on-site repairs, including but not limited to parts and labor costs.

Dealer Locator Services

Assisting customers to the closest qualified service facility when they're in unfamiliar territory.

If you purchased your vehicle **prior to 1/1/2024**, please call the following number for emergency roadside assistance:

866-209-2895

If you purchased your vehicle **on or after 1/1/2024**, please call the following number for emergency roadside assistance:

800-608-2751



VALID FOR 1 YEAR FROM DATE OF PURCHASE

NOVA Warranty Breakdown

ProMaster Chassis Warranty Breakdown

- 3 YEARS/36,000 MILES
- POWERTRAIN 5 YEARS/60,000 MILE

NOVA MOTORHOME WARRANTY

- 12 MONTHS/12,000 MILES LTD.

NOVA APPLIANCES/PARTS WARRANTY

- NOVAL KOOL REFER 2 YEAR WARRANTY
- TRUMA COMBI ECO PLUS/ALL /PART#C01285034/1 YR. WARRANTY FROM PURCHASE
CAN EXTEND TO 2 YEARS ONCE REGISTERED
- COLEMAN MACH 13.5 BTU AC/2 YR. WARRANTY
 - FANTASTIC FAN/7 YEAR WARRANTY
 - BEAUFLOR LINO/7 YEAR WARRANTY
- ONAN GAS GENERATOR/3 YEARS-2000 HOURS
- PREMIERE SOFA/CHAIRS/3 YEAR-36,000 MILES
- CAREFREE OF COLORADO AWNING/1 YEAR
 - SOLAR PANELS/5 YEARS