

# *Sandpiper*

LUXURY  
FIFTH  
WHEELS







**BETWEEN EVERY TWO PINES  
IS A DOORWAY TO A NEW WORLD.**

*~ John Muir*

---





# *Sandpiper*



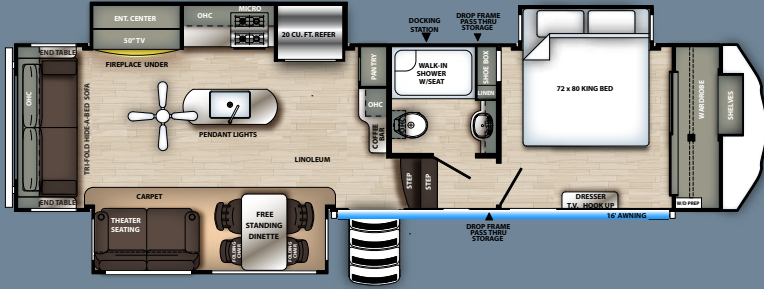

# 321RL

*Featuring Flint Decor*

## THOUGHTFUL DESIGN

Although small in stature, this 321RL floorplan packs a major punch. Boasting a king size bed, full walk in shower and spacious floor to ceiling pantry, this floorplan offers multiple luxurious amenities for any couple looking to hit the road.









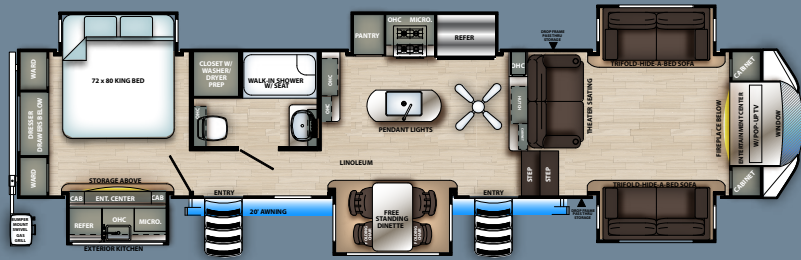

# 379FLOK

*Featuring Flint Decor*

## AT HOME ON THE ROAD

With six slides, this front living room layout boasts substantial real estate for entertaining. The innovative front windshield allows natural light to flow into the coach. With a push of a button, raise up a 50" flatscreen LED TV in the front living area, perfect for watching the game or relaxing. Enjoy ample headroom with the master bedroom suite and bathroom being on the main deck. Keep the party going outside using the 379FLOK's standard outside kitchen.









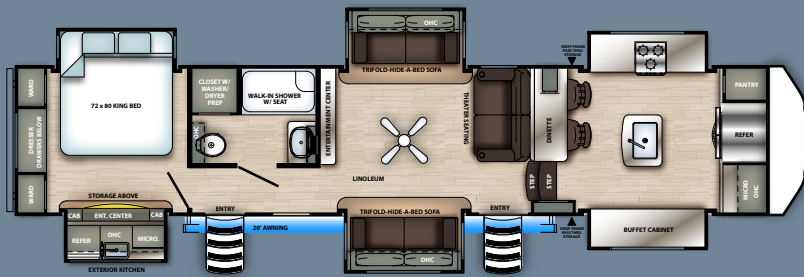

# 38FKOK

*Featuring Flint Decor*

## RESIDENTIAL STYLING

If cooking is a passion for you, look no further than our 38FKOK. This floorplan flaunts some of the largest countertops in the industry, making cooking preparations much easier. Along with a deluxe kitchen set up, this layout gives you a living room that comfortably seats up to 6 people. Lets not forget about the king sized bed and modern outside kitchen that are a standard offering.









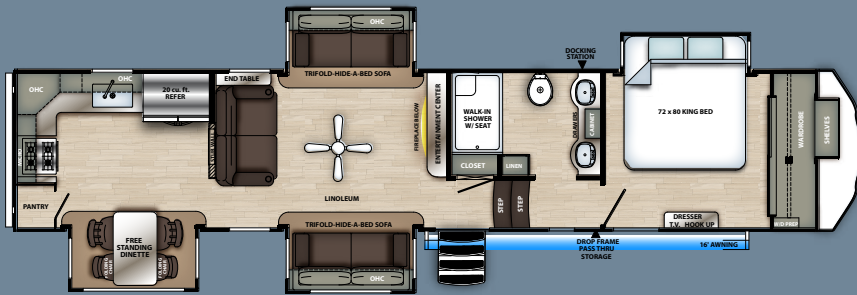

# 39BARK

*Featuring Fog Decor*

## ALL THE CREATURE COMFORTS

This rear kitchen floorplan does not leave anything to the imagination. Whether it's entertaining guests in the spacious open concept kitchen area, or lounging in the six person living room, the 39BARK has something for everyone. This feature packed floorplan is the pick of the litter, and it won't take a bite out of your wallet.









# Interior Features

- A** Handcrafted fascia gives the slide-out a distinguished look
- B** Porcelain foot flush toilet, easy to use, easy to clean
- C** Pot and pan rack style lighting in kitchen
- D** LED accent lighting at toe kick for increased visibility at night
- E** LED HDTV with premium soundbar and Sony DVD player
- F** Mocha accented crown molding gives the Sandpiper Kitchen a truly residential finish
- G** Real wood drawers on soft close, full extension, ball bearing drawer guides
- H** The Sandpiper Signature package includes stainless steel appliances
- I** Enjoy the warmth and comfort of the electric fireplace
- J** Contemporary ceiling fan
- K** Upgraded master bedroom headboard with integrated LED lighting
- L** Interior handrail to upper deck for added safety.

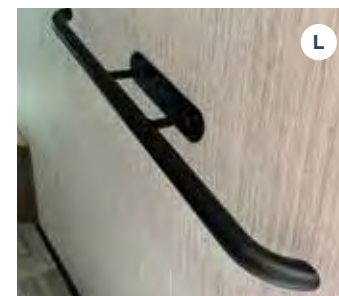
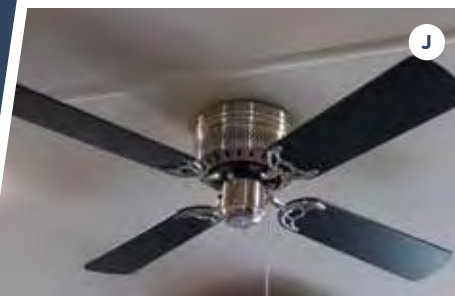
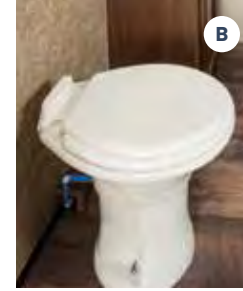



# Exterior Features

- A** Oversized grab handle at main entry door
- B** Newly designed front cap, select models feature a tinted window.
- C** Optional hydraulic wide stance power front jacks
- D** MOR/ryde low rise fold in entry steps (Optional)
- E** Locking LP Bottle storage on slide tray
- F** 16" Radial tires – F Rated
- G** Command center control panel for operating slides, monitoring tank levels and controlling lighting
- H** Sandpiper's lighted docking station
- I** 110v outlet and cable outlet conveniently located in the pass-thru storage area
- J** Underbelly Armour full coach underbelly protection with removable 4 foot sections for maintenance access.
- K** Drip rail with extra long drip spouts help prevent black streaking
- L** Gel coat fiberglass protects from UV rays and prevents yellowing and cracking prevent black streaking

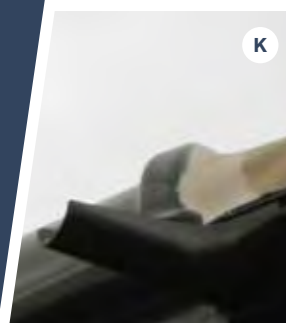
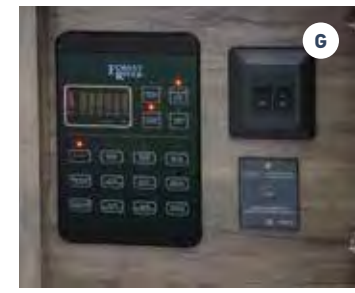
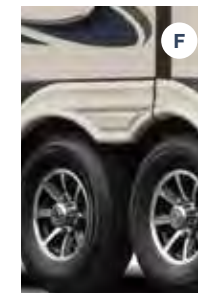



# Standards, Packages and Optional Features

## EXTERIOR FEATURES

- Color match high gloss gel coat colored exterior fiberglass
- Painted two-tone aerodynamic fiberglass front cap with improved turning radius
- Docking station: Easy winterization, hot and cold spray port, black tank flush, pull valves for tanks
- Enclosed and heated dump valves
- Underbelly Armor
- Large tinted windows with 80/20 UV prohibiter
- Aluminum radius quad entry steps
- "One Touch" Dometic® electric awning with LED light strip
- 16" Radial tires – F Rated
- Automotive-style fender skirts
- Hitch light
- Exterior kitchen (per floorplan)
- Porch light with interior switch
- 30 lb. double LP tanks on slide tray with auto change over
- Roof ladder
- 2 LED lighted exterior speakers
- Rain gutters with extra long drip spouts (prevents black streaking)
- Insulated heavy duty slam lock baggage doors
- Exterior foldable grab handle
- Unobstructed drop frame pass through storage area with cable jacks and 110V outlet
- 2 spray ports with 25' hose (one on each side)
- Upgraded aluminum rims
- 7,000 lb. axles
- Friction hinge entry door
- Hydraulic front jacks

## INTERIOR FEATURES

- 84" Interior height with 6'4" slide heights
- Hardwood slide-out fascia
- Stainless steel appliances
- Rustic wood plank linoleum
- Decorative backsplash
- Two color coordinated interiors
- Soft close full extension drawer glides
- Hidden hinged cabinet doors with soft close full extension drawer glides
- Stainless steel under mounted kitchen sink
- Washer/Dryer prep
- Handmade cabinetry with screwed lumber core stile construction
- LED lighting throughout
- Residential countertops
- Recessed residential lighting
- Colored shower surround
- Upgraded adjustable shower head with shelf
- Theater seating with LED lighting
- Accent lighting over dinette
- LED lighting at islands
- Night lights on fifth wheel steps
- Walk-in shower with seat (most models)
- Mocha accent crown molding over kitchen cabinets
- Extra large picture windows throughout
- Vented side windows in slide-outs
- TV antenna with booster
- Solid wood drawer fronts with birch sides

- Upgraded raised panel cabinet doors with designer rails
- Bedroom slideout fascia
- LED lighted headboard
- Teddy Bear® bunk mats
- 50" flat screen LED HD TV
- Premium soundbar with built in flush mounted DVD player
- Designer window treatment accented per decor
- Ceiling fan
- Tri-fold hide-a-bed sofa
- Glider sofa with USB/110 outputs (standard in all off door bunk slides)
- Residential stain resistant carpet
- Quilted bedspread
- Trash receptacle in kitchen

## APPLIANCES / SYSTEMS

- (2) 15K A/C with Quick Cool
- 22 cu. ft. residential refrigerator
- Floor ducted 35,000 BTU furnace
- 30" OTR Stainless microwave
- Four burner high output free standing range
- Interior monitor panel for holding tanks
- Flush floor hydraulic slide-outs (per floorplan)
- Dual battery prep
- Satellite and cable hookup with RG-6 cable for high quality picture
- Porcelain foot flush toilets
- 10 Gal. DSI water heater
- 65 Amp converter
- Power fan in bathroom

## CONSTRUCTION

- Welded aluminum-framed, vacuum bonded laminated superstructure
- 2" x 3" floor joists 12" on center
- 5/8" tongue & groove plywood floor decking
- 3/8" roof decking (full walk-on roof)
- Cambered powder coated frame with rust prohibitor
- Fully enclosed heated underbelly
- 5" truss roof rafters
- R-10E sidewall construction
- Laminated sidewalls
- Laminated slide-out walls

## FOR YOUR SAFETY

- Smoke alarm
- Fire extinguisher
- Breakaway switch (battery hook-up required)
- Dead-bolt lock on entry door
- LP/CO2 gas detector
- Fire escape windows

## POPULAR OPTIONS

- MOR/ryde "Step Above" entry step
- Tri-fold hide-a-bed with hinged bunk overhead (bunk slides)
- Free-standing dinette with 4 chairs (per floorplan)
- 18 cu. ft. gas/electric refer
- Washer and dryer (per floorplan)
- Generator prep
- Zamp® roof mounted solar prep
- Fantastic fan with rain sensor
- 32" bedroom TV
- 12 Volt heated holding tanks
- Central vacuum
- Slide room awnings (all slides)

## POLAR TECH PACKAGE (OPTIONAL)

- Thermal pane windows
- Heated holding tanks
- 40K BTU furnace

## SANDPIPER SIGNATURE PACKAGE (STANDARD)

- Stainless appliance package
- Slam lock baggage doors
- 30" OTR Stainless microwave
- (2) 15K Air conditioner
- Backsplash
- 10 Gal. G/E water heater w/DSI
- Soft close residential drawers and cabinet doors
- 16" spare tire kit
- Docking station
- Aluminum wheels with 7K axles
- High gloss gelcoat fiberglass exterior
- Washer/dryer prep
- 50" Flat screen television (most models)
- Water filter system
- Premium sound bar with DVD
- 2 folding dinette chairs (n/a with booths)
- Power fan in bathroom(s)
- 22 cu. ft. refer w/1000 watt inverter
- Dometic electric awning w/ LED light strip
- Backup camera prep
- LED interior lighting throughout
- LP quick disconnect
- Quad aluminum entry steps
- Shaw linoleum and carpet
- Roller shades
- Underbelly armor

## PLATINUM PACKAGE (STANDARD - Limited Time Offer)

- Solid surface countertops
- 6 point hydraulic leveling system
- High efficiency radiant foil (roof and floor)
- King pillowtop mattress (where available)
- 4 Burner stainless range (n/a 38FKOK)
- 2nd 15K A/C
- King Wi-Fi extender system
- 3 camera security prep

## ULTIMATE KITCHEN PACKAGE (STANDARD)

- 22 Cu. Ft. Stainless refer with 1000 watt inverter
- 4 Burner high output stainless free standing range (n/a 38FKOK)
- 30" OTR Stainless microwave
- Solid surface countertops
- Stainless steel sink
- Soft close doors and drawers.

## COMFORT PACKAGE (STANDARD)

- (2) 15K A/C's on thermostats
- Electric fireplace with 5,200 BTU space heater
- 35K BTU furnace
- High efficiency radiant foil (roof and floor)

## ULTIMATE ENTERTAINMENT PACKAGE (STANDARD)

- 50" Flatscreen TV's
- Soundbar with DVD player
- Exterior speakers



# Superior Construction

- A Rolled Aluminum Side Skirting
- B Tinted Safety Glass Windows (80%)
- C Dual Zone Ducted 15K BTU Air Conditioning
- D 7,000 Lb. Axles with Auto Adjust Brakes
- E Laminated Vacuum Bonded Aluminum Sidewalls
- F 16" F-rated Radial Tires (standard)
- G Aluminum Quad Entry Steps
- H Color Matched Seamless Rubber Roof (12-yr. Warranty)
- I 2" Block Foam Insulation
- J Deluxe Stain Resistant Carpet with Padding
- K 3/8" Roof decking (Full Walk-on Roof)
- L 5/8" Tongue and Groove Plywood Flooring
- M Underbelly Armor full length underbelly protection

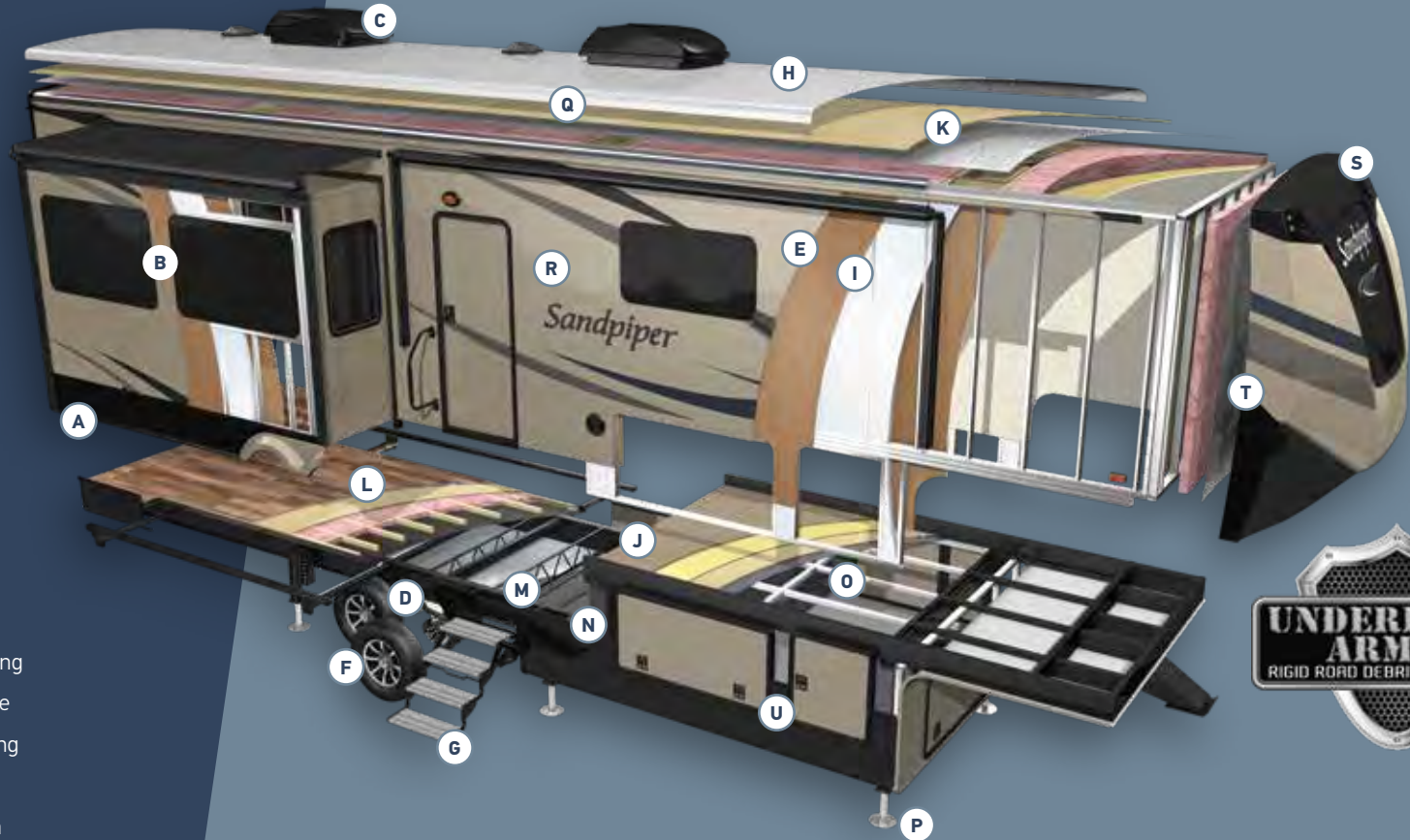

## Built to Last

The Sandpiper is built to last using only the best materials to ensure that your coach is in it for the long haul. Careful engineering, well appointed craftsmanship and an uncompromising sense of pride go into every fifth wheel that we produce. Rest assured that your Sandpiper is built for luxury living.

- N I-Beam Powder-Coated Frame with Rust Inhibitor
- O Aluminum, Insulated Bath Deck
- P Hydraulic 6-Point Level Up System
- Q Sleek Radius Roof
- R Painted Color Matched high gloss Gel-coated Fiberglass Exterior
- S Two-tone Painted Gel-coated Fiberglass Front Cap (Standard)
- T Improved Front Cap for Sharper Turning Radius
- U Insulated Slam Lock Baggage Doors





# Floorplans

*Find Your Perfect Match*

## SOMETHING FOR EVERYONE

Wherever you go, the Sandpiper lineup will ensure you make the most out of every adventure. Unique floorplan designs like bunkhouses, front living spaces, rear living/entertainment, or outside kitchens will accommodate any traveler or group. Luxurious features like premium hardwood accents, an exclusive stainless steel range, and patented Underbelly Armor, give the Sandpiper a reputation of elegance and outstanding quality.



## EXTERIOR KITCHEN

Our full size exterior kitchen features a swing arm gas grill, microwave, refrigerator, sink with hot and cold running water, and abundant counter and storage space.  
(Select models)

## 321RL

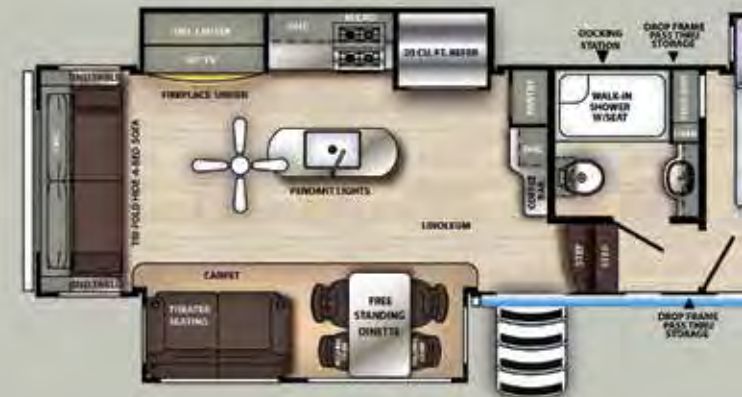

## 372LOK

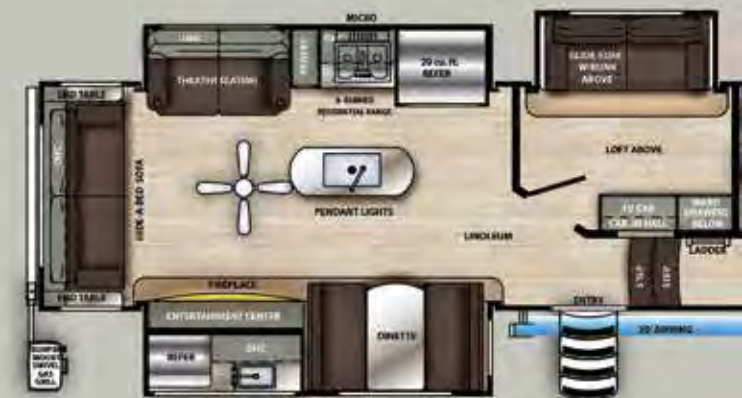

### 368FBDS



### 373BH



*Sandpiper*



# 379FLOK



# 38FKOK



# 383RBLOK



321RL

368FBDS

372LOK

373BH

379FLOK

38FKOK

383RBLOK

384QBOK

39BARK

## Specifications

Hitch	1,710	2,173	2,474	2,275	2,495	2,256	2,184	2,261	2,105
UVW	10,669	11,892	12,962	12,759	12,819	12,823	13,469	13,132	12,079
GVWR	15,500	15,500	15,500	15,500	15,500	15,500	15,500	15,500	15,500
Cargo	3,000	3,000	3,000	3,000	3,000	3,000	2,715	3,000	3,000
Length <small>Shopper to hitch, and 14" for overall length.</small>	35' 0"	41' 3"	41' 9"	41' 8"	42' 9"	41' 8"	42' 2"	41' 8"	41' 0"
Height	13' 5"	13' 5"	13' 5"	13' 5"	13' 5"	13' 5"	13' 5"	13' 5"	13' 5"
Awning	16'	12'	20'	16'	20'	20'	15'	15'	16'
Gray	52	104	134	97	134	134	127	134	104
Black	52	104	52	104	52	52	82	104	52
*Fresh	60	60	60	60	60	60	60	60	60

\* Fresh Water Capacity Includes 10 Gal Water Heater



384QBOK



39BARK



# Sandpiper



GVWR (Gross Vehicle Weight Rating) - is the maximum permissible weight of the unit when fully loaded. It includes all weights, inclusive of all fluids, cargo, optional equipment and accessories. For safety and product performance do NOT exceed the GVWR.

GAWR (Gross Axle Weight Rating) - is the maximum permissible weight, including cargo, fluids, optional equipment and accessories that can be safely supported by a combination of all axles.

UVW (Unloaded Vehicle Weight)\* - is the typical weight of the unit as manufactured at the factory. It includes all weight at the unit's axle(s) and tongue or pin and LP Gas. The UVW does not include cargo, fresh potable water, additional optional equipment or dealer installed accessories.

\*Estimated Average based on standard build optional equipment.

CCC (Cargo Carrying Capacity)\*\* - is the amount of weight available for fresh potable water, cargo, additional optional equipment and accessories. CCC is equal to GVWR minus UVW. Available CCC should accommodate fresh potable water (8.3 lbs per gallon). Before filling the fresh water tank, empty the black and gray tanks to provide for more cargo capacity.

\*\* Estimated average based on standard build optional equipment

Each Forest River RV is weighed at the manufacturing facility prior to shipping. A label identifying the unloaded vehicle weight of the actual unit and the cargo carrying capacity is applied to every Forest River RV prior to leaving our facilities.

The load capacity of your unit is designated by weight, not by volume, so you cannot necessarily use all available space when loading your unit.

All information contained in this brochure is believed to be accurate at the time of publication. However, during the model year, it may be necessary to make revisions and Forest River, Inc., reserves the right to make all such changes without notice, including prices, colors, materials, equipment and specifications as well as the addition of new models and the discontinuance of models shown in this brochure. Therefore, please consult with your Forest River dealer and confirm the existence of any materials, design or specifications that are material to your purchase decision.



**PRE-DELIVERY INSPECTION FACILITY**  
20,000 square feet of quality assurance. The bare essentials for a premium product. This state-of-the-art facility gives immediate daily feedback to production for quality assurance in every unit built.

**WWW.KOACARECAMPS.ORG**

**Fighting Cancer Making Memories**

When a Forest River product is purchased a donation is made to Koa Care Camps. Care Camps supports more than 100 specialized summer camps throughout North America that provide a true camping experience to children with cancer and their siblings. These camps are provided at no charge to the affected families. Thank you for considering Forest River.

For more information about Care Camps visit [www.koacarecamps.org](http://www.koacarecamps.org)

**24/7 EMERGENCY  
ROADSIDE ASSISTANCE  
WITH VEHICLE PURCHASE\***

TOWING	WINCH-OUT
JUMP-STARTS	MOBILE MECHANIC
TIRE CHANGES	TECHNICAL
FLUID DELIVERY	SUPPORT
LOCKOUT	DEALER LOCATOR
SERVICE	SERVICES

**SAFERIDER™  
MOTOR CLUB**

\*VALID FOR 1 YEAR FROM DATE OF PURCHASE

**FREE MEMBERSHIP**  
to Forest River Owners' Group

[www.forestriverfrog.com](http://www.forestriverfrog.com)

CUSTOMER SATISFACTION

**FOREST RIVER**  
encourages you to

**BUY LOCAL**

PREFERENTIAL SERVICE | PRODUCT INFORMATION

[www.ForestRiverBuyLocal.com](http://www.ForestRiverBuyLocal.com)



**Learn More**  
Scan this barcode using a QR Reader on your smart phone to learn more about Forest River.



A Berkshire Hathaway company.

Forest River, Inc.  
55470 C.R. 1, Elkhart, IN 46515  
(574) 389-4600  
[www.forestriverinc.com/Sandpiper](http://www.forestriverinc.com/Sandpiper)  
[www.forestriveraccessories.com](http://www.forestriveraccessories.com)

YOUR LOCAL SANDPIPER DEALER