

# 2005 DAMON INTRUDER



Messita, New Mexico

About the only thing it doesn't have is a big price tag.



WELCOME TO PARADISE.



We've put a lot of luxury into our stylishly appointed 2005 Intruder Motorhome. And, even better, we've done it without putting it out of reach of experienced, value-conscious recreation vehicle owners like you.

This year our refined new Intruder comes with more quality features for the money than ever before. With a warm, inviting interior, tasteful appointments all around and an exterior that's beautiful, yet tough as nails. And, as always, Intruder comes with more comfort and luxury than other motorhomes priced thousands higher.

Intruder. No wonder it's the industry's value leader.

#### LUXURY AMENITIES.

The optional booth dinette is more comfortable than typical foam cushion chairs due to steel springs in the seats.

A Carrier® ducted air conditioner is mounted on the roof and has a remote thermostat so you can adjust the temperature from inside your Intruder.





Model 373, Turning Leaf decor

A huge, full basement with extra-large, extra-strong pass-through storage compartments offers plenty of room to pack your active life. Plus, our rotocast storage compartment with one-way drain valves lets you give your basement a quick wash.

Aerodynamic gelcoated front and rear caps give your Intruder a sleek, elegant look. You can also option our seamless fiberglass roof, which practically eliminates maintenance costs.

Now you can tow most SUVs with Intruder's heavy-duty 5,000-lb. trailer hitch.



## FLOOR PLANS

Damon offers a variety of floor plans and options. All provide the roomiest, most convenient mobile living experience you've ever had.

**350**

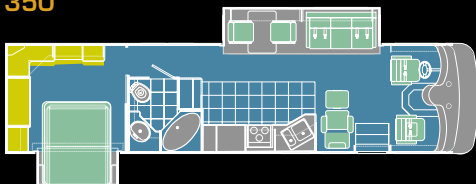

Washer/dryer available • Spacious bathroom • Vanity  
Extra large windows in hall

**369**

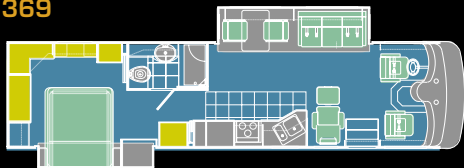

Living-area slideout • Washer/dryer available • Four wardrobes

**373**

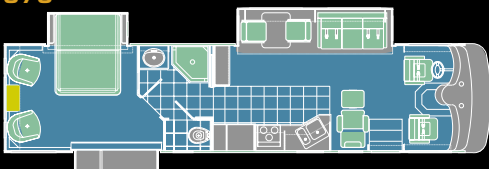

Living-area slideout • Triple slide • Dual-zone living  
Panoramic rear bedroom windows

**375**



Double slideout • Triple living-area windows • TV useable while driving

**377**

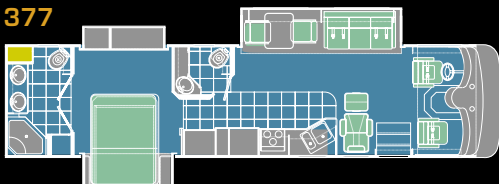

Private master bathroom • Triple slide • Living-area slideout

**391**

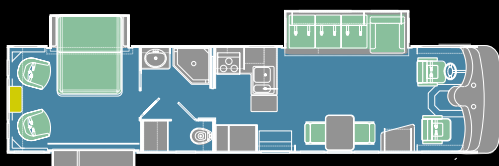

Dual zone living • Private stool area • L-shaped kitchen

## MORE "GEE-WHIZ" FEATURES.

Cockpit windows and an enormous windshield provide wide-open visibility and safety, plus give Intruder a smart, stylish look.

There's more headroom and less tripping across the living room with Intruder's flush-floor slideouts. They're quiet, too, operating on a smooth rack-and-pinion mechanism.

Intruder's heated, front-mounted rear-view power mirrors eliminate blind spots and let you easily and quickly see behind the coach.

Our premium Pioneer® AM/FM/CD player in the cockpit dash offers quality sound and makes your long drives more entertaining. Option our Pioneer XM-satellite radio tuner and you expand your choice of stations, plus get coast-to-coast programming, with no need to switch stations as you travel.

Optional Sherwin Williams® full-body paint packages will truly set your Intruder apart from other motorhomes.

Intruder's optional Surroundsound® home-theater system lets you enjoy all of your favorite movies, no matter where you are. Includes DVD/CD player, satellite speakers, Pioneer 250-watt receiver and subwoofer.

## SIDEWALLS

Sidewalls are five layers thick, consisting of:

- Exterior fiberglass
- Wood backer
- Aluminum frame
- Bead-foam insulation
- Interior wallboard

Walls are also vacuum-bond laminated for added strength and rigidity.

## FLOOR

A water-resistant, Structurwood® floor supports the living area. Framed in 1.5-inch welded-steel tubing, it's insulated with solid- bead foam and protected with a galvanized underbelly, which will not rust or corrode.





AS BEAUTIFUL ON THE INSIDE AS IT IS ON THE OUTSIDE.

#### ROOF

Intruder's roof is vacuum-bond laminated for superior strength and rigidity. It features an aluminum-rafter support system with bowed rafters to maintain the roof's crowned shape. A crowned roof permits better water runoff, which helps prevent leaks.

#### BASEMENT AND STORAGE

The Intruder basement construction incorporates a strong, welded-steel truss system. Trusses are horizontal to better distribute weight. They also allow for Intruder's full basement and massive pass-through storage compartments.

#### UTILITIES

Travel in any season because of Intruder's heated holding tanks and fully contained plumbing systems. Tanks are mounted horizontally, making service and maintenance easy.

#### CHASSIS

Quality construction starts here. And Intruder uses only the finest: either a rugged Ford® or Workhorse® chassis depending on the floor plan.



Motels, a combination of the words motor and hotel, evolved from auto camps, which developed as townspeople along Route 66 roped off spaces for travelers to camp for the night.

## NOW COMES THE HARD PART.

Time to choose your favorite paint color, floor plan, fabrics, styles and options. No matter which model and design package you choose, you can be assured that every Intruder motorhome we make is built the same way — the right way — with the same high-quality materials, components and state-of-the-art construction techniques.

### SPECIFICATIONS AND FEATURES

For a complete list, visit [www.DamonRV.com](http://www.DamonRV.com)

#### Bathroom

12" x 12" vinyl tile flooring	S
Full-height fiberglass tub or shower with skylight	S
Obscure glass window in private stool area (373, 377 & 391 only)	S
Power vent	S
Foot-flush porcelain toilet with sprayer	S

#### Bedroom

Pillowtop mattress and bedspread	S
Upgraded Memory Foam mattress	O
Wardrobe lights and pin-up lights	S
19-inch color TV	S
Lambrequin window treatments with day/night shades	S
AM/FM/CD player	O

#### Chassis

Ford® F53 chassis with 6.8L V-10 engine (310-hp, 425 lb.ft. torque)	O
Workhorse® W chassis with Vortec V-8 engine (340-hp, 445 lb.ft. torque)	O
Leveling jacks with semi-automatic touchpad controls	S
Front and rear mud flaps	S
Workhorse® 22.5-inch wheels and tires/Ford® 19.5-inch wheels and tires	S
Stainless-steel wheel liners	S
Trailer hitch (5,000 tow lbs. /500 tongue lbs.)	S
Emergency start circuit	S
Under-hood light	S
Layer of neoprene vibration dampener	S

#### Cockpit

Molded ABS dash with electronically controlled A/C	S
AM/FM/CD player with 4-speaker sound (single-disk, in-dash)	S
AM/FM/cassette with multi-disc CD changer	O
XM-satellite radio tuner	O
Dash fans	S
Electric trumpet horns	O
Driver's door with power window	O
Tinted wraparound windshield with privacy shade	S
Front-mounted power mirrors with heat	S
Reclining swivel captain's chairs (ultraleather optional)	S
Power 6-way seat (driver and/or passenger)	O
3-point, wall-mounted seatbelts	S
Side storage cabinets above driver and passenger	S
Sun visors	S
Back-up monitor system with audio and flip-up LCD screen	O

#### Entry

Electric entrance step	S
Ice chest and battery access in stairwell	S

#### Exterior

Paint package with deluxe graphics	S
Full-body paint package including color-coordinated Carefree® slideroom awnings	O
Fog lights	S
Radius-cornered domed BriteTEK® TPO roof	S
Fiberglass roof	O
Rear ladder	O
Aerodynamic front and rear fiberglass caps	S
Side-mounted patio awning	S
Color-coordinated electric patio awning (required with full-body paint)	O
Remote for electric patio awning (required w/full-body paint)	O
Side-mounted awning over slideout	S
Upgraded gelcoated sidewall	S
Locking exterior storage doors with gas pistons	S
White-trimmed, radius-topped entrance door	S
Black-framed, radius-cornered windows (dual-pane optional)	S
Two patio lights (one on each side)	S

Easy-to-clean, lighted, rotocast storage compartments	S
Full basement pass-through storage	S
Invisible Bra®	O

#### Kitchen

Refrigerator: large flush-mounted, double-door	S
Refrigerator: large flush-mounted, double-door with icemaker	O
Refrigerator: side-by-side with icemaker (no pantry)	O
Refrigerator: raised-panel, hardwood front (oak or maple)	S
3-burner range and oven with solid-surface cover	S
Cooktop IPO range & oven (requires convection microwave)	O
Microwave oven (microwave/convection oven optional)	S
Lighted power range hood	S
Monitor panel with LPG readout	S
Single-lever faucet with sprayer (water filter optional)	S
Pantry with drawers and adjustable shelves	S
Solid-surface countertops and sink covers(s)	S
Solid-wood, raised-panel cabinet doors (upper) (oak/maple)	S
12" x 12" vinyl tile flooring	S
Freestanding dinette with 2 chairs	S
2 folding chairs (available with freestanding dinette or buffet)	O
Buffet with additional storage (N/A on 375 & 391)	O
Booth dinette w/solid-surface-edged table (N/A on 375 & 391)	O
Mini blinds	S
Fantastic® power vent (rain sensor optional)	S

#### Living Area

Cloth incliner w/footrest (ultra-leather opt.) (375 & 391 only)	S
Euro recliner with leather seating surface and ottoman (passenger side) (N/A on 375 & 391)	S
Cloth hide-a-bed (ultra-leather optional)	S
Continental bed (ultra-leather)	O
Day/night shades	S
100% nylon carpeting with stain treatment and padding	S
27-inch TV in entertainment center over cockpit	S
Video package (VCR/DVD player and control center)	S
Home theater (VCR/DVD w/Dolby® receiver amplifier)	O
Aisle lights (fluorescent lighting optional)	S



Cinnamon Bronze



Smoky Pewter



Cabernet Sand Full-body Paint Package

## DÉCOR

Choose from a selection of well-appointed décor packages that lend a sense of personality and make you feel right at home in your Intruder.

### Utilities

Air conditioner: 13,500-BTU ducted central (front and rear)	S
Air conditioner: 15,000-BTU ducted central upgrade (front) (N/A with solar battery charger)	O
Remote thermostatically controlled air conditioning	S
5-watt chassis solar battery charger	O
Dual heat pumps w/15,000-BTU A/C & 12,700-BTU heat (N/A with optional A/C)	O
Furnace: 35,000-BTU electronic ignition, floor-ducted	S
Water heater: 6-gallon gas/electric w/electronic ignition	S
Water heater bypass kit	S
Generator: 5.5 kW Generac® Quietpact™	S
Generator: 5.5 kW Onan® Marquis Gold®	O
Generator: 7.0 kW Onan® Marquis Gold®	O
600-watt entertainment inverter w/Thermoil® 6-volt auxiliary batteries IPO standard batteries	O
Converter: solid-state, 75-amp, 12-volt	S
Dual 6-volt auxiliary batteries and battery disconnect	S
50-amp, 120-volt service w/marine detachable power cord	S

Exterior GFCI receptacle	S
Enclosed heated potable and holding tanks	S
Black-water tank flush	S
Three-way valve for tank/city water fill	S
Washer/dryer prep (N/A on 373 & 375)	O
Washer/dryer combo (N/A on 373 & 375)	O
Telephone, cable TV and satellite hookups	S
Pre-wired for roof-mounted satellite dish (DSS dish optional)	S
Exterior shower	S
Carbon monoxide, LP gas and smoke detectors	S

S = Standard      O = Optional      N/A = Not available

Weights & Measures	350	369	373	375	377	391
Chassis	Workhorse/Ford	Workhorse/Ford	Workhorse/Ford	Workhorse/Ford	Workhorse/Ford	Workhorse
Wheelbase	228	228	242	242	242	256
Overall length	36' 6"	36' 6"	37' 11"	37' 11"	37' 5"	39' 1"
Overall width	101"	101"	101"	101"	101"	101"
Overall height with AC	12' 0"	12' 0"	12' 0"	12' 0"	12' 0"	12' 0"
Std. weight (appx. lbs.)	18,498/17,814	18,168/18,080	19,297/18,845	18,619/17,864	18,722/18,433	19,895
GVWR	22K	22K	22K	22K	22K	24K
GCWR	26K	26K	26K	26K	26K	30K
Fresh water (appx. gal.)	80	80	80	80	80	80
Grey/black water (appx. gal.)	50/42	50/42	50/42	50	90/50	50
LP (lbs.)	103.5	103.5	103.5	103.5	103.5	103.5
Sleeping capacity	4	4	4	4	4	4
Exterior storage capacity (cu. ft.)	165	165	165	168	168	172
Interior drawers	26	30	18	30	21	13
Fuel capacity (appx. gal.)	75	75	75	75	75	75



Opus One

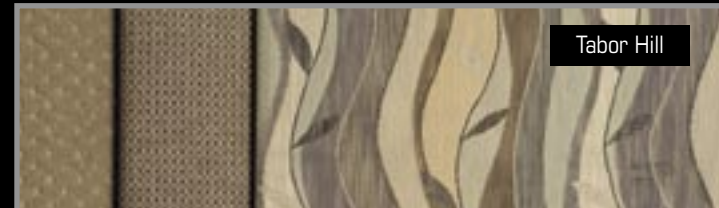

Tabor Hill

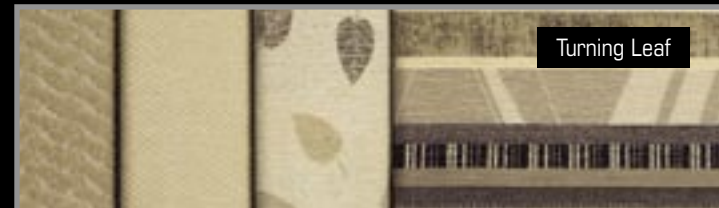

Turning Leaf

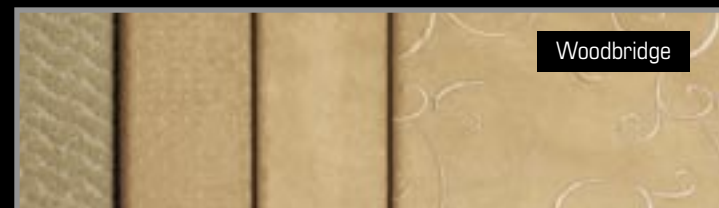

Woodbridge

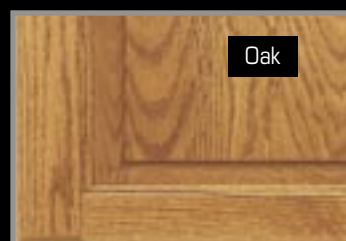

Oak

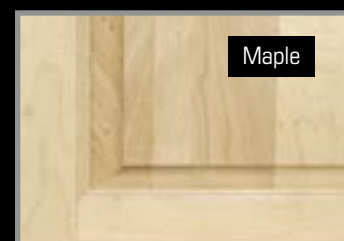

Maple



Emerald Champagne Full-body Paint Package



Ebony Sand Full-body Paint Package

## PAINT

Intruder's exterior has a wonderful fluid, sweeping look, with bold, clean graphics and optional paint styles. Few other motorhomes in Intruder's class offer this many choices.





Phillipsburg, Missouri



**DAMON**  
MOTOR COACH

P.O. Box 2888 • Elkhart, IN 46515

Sales: 800-860-5658

Customer Service: 800-860-3812

[www.DamonRV.com](http://www.DamonRV.com)

**RVIA**



**ARCA**

**THOR**  
AMERICA'S BEST RV VALUE

DC 8/04 © 2004 Damon Motor Coach Printed in U.S.A.

Due to constant product improvements, the specifications of the models may change without notice or obligation. Components and features may differ to conform to local codes. Due to EPA environmental restrictions, engine power and torque ratings may change mid-year.



# INTRUDER

## 2005.5 FLOOR PLANS

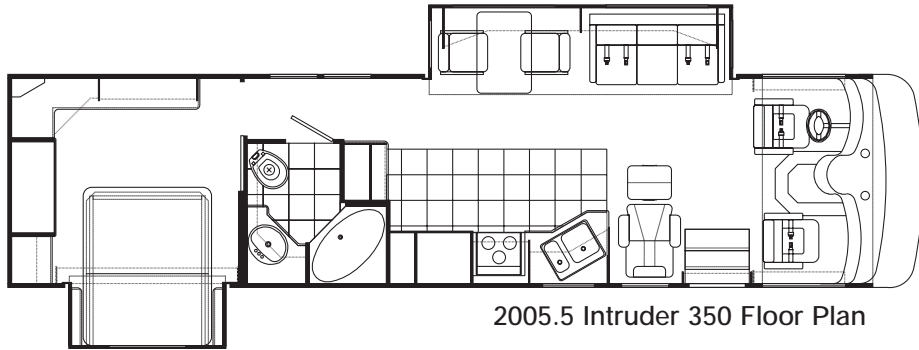

2005.5 Intruder 350 Floor Plan

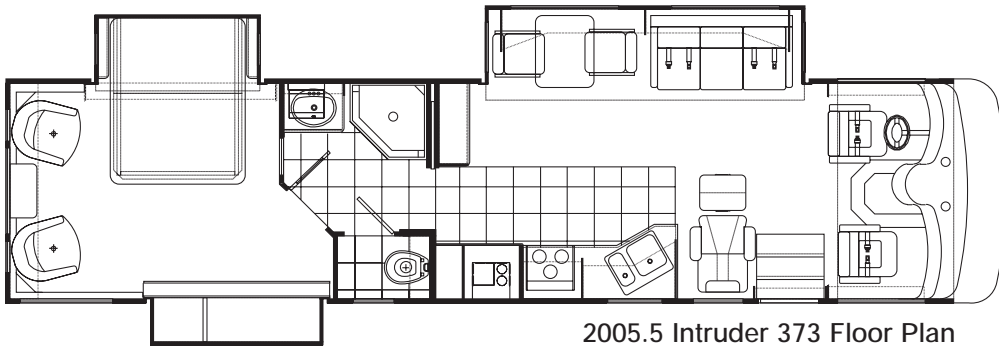

2005.5 Intruder 373 Floor Plan

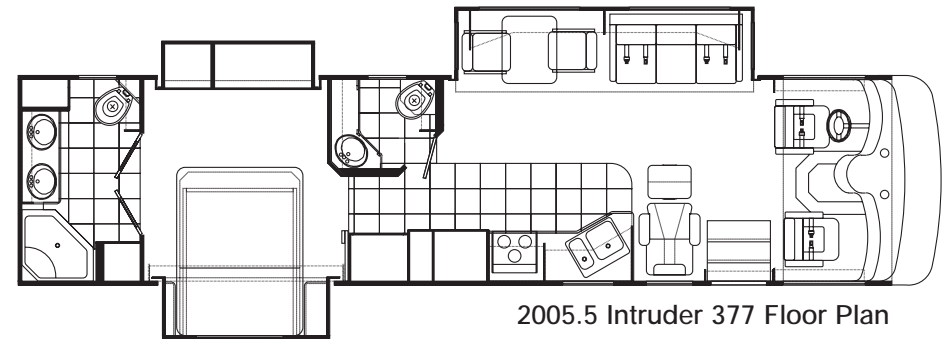

2005.5 Intruder 377 Floor Plan

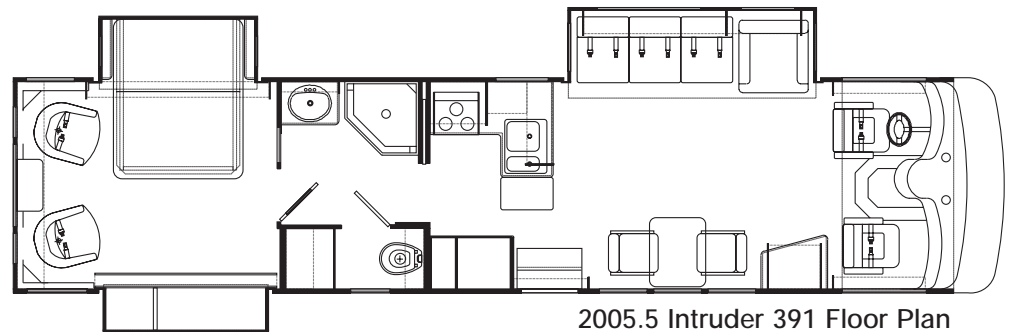

2005.5 Intruder 391 Floor Plan

*Value by design is back!*



## 2005.5 INTRUDER SPECIFICATIONS

Intruder Bathroom	350	373	377	391
Vinyl tile flooring	S	S	S	S
Full-height fiberglass tub or shower with door	S	S	S	S
Skylight in bath	S	S	S	S
Obscure glass window in private stool area	N/A	S	S	S
Power vent	S	S	S	S
Foot-flush porcelain toilet with sprayer	S	S	S	S
Wallpaper border	S	S	S	S
Intruder Bedroom	350	373	377	391
Pillowtop mattress	S	S	S	S
Bedspring	S	S	S	S
Wardrobe lights	S	S	S	S
19-inch color TV	S	S	S	S
Lambrequin window treatments	S	S	S	S
Day/night shades	S	S	S	S
Pin-up lights	S	S	S	S
AM/FM/CD player	0	0	0	0
Intruder Chassis	350	373	377	391
Leveling jacks with semi-automatic touchpad controls	S	S	S	S
Front and rear mud flaps	S	S	S	S
22.5" wheels and tires	S	S	S	S
Stainless-steel wheel liners (Workhorse® only)	S	S	S	S
Aluminum wheels (Ford® only)	S	S	S	N/A
Full-width stainless stone guard with Damon stencil	0	0	0	0
Trailer hitch (5,000 tow lbs. / 500 tongue lbs.)	S	S	S	S
Emergency start circuit	S	S	S	S
Under-hood light	S	S	S	S
Automatic transmission with overdrive	S	S	S	S
Layer of neoprene vibration dampener	S	S	S	S
Intruder Cockpit	350	373	377	391
Molded ABS dash	S	S	S	S
Electronically controlled dash air conditioning	S	S	S	S
AM/FM/CD player (single-disk, in-dash)	S	S	S	S
Multi-disc CD changer	0	0	0	0
4-speaker sound	S	S	S	S
Cruise control	S	S	S	S
Tilt steering wheel	S	S	S	S
Map lights (double-pancake)	S	S	S	S
Dash fans	S	S	S	S
Driver's door with power window	0	0	0	0
Tinted wraparound windshield	S	S	S	S
Windshield privacy shade	S	S	S	S
Front-mounted power mirrors with heat	S	S	S	S
Reclining swivel captain's chairs	S	S	S	S
Ultra-leather captain's chairs	0	0	0	0
Power 6-way seat (driver only)	S	S	S	S
3-point, wall-mounted seatbelts	S	S	S	S
Side storage cabinets above driver and passenger	S	S	S	S
Sun visors	S	S	S	S
Electric sun visors with two manual side shades	0	0	0	0

Back-up monitor system with audio and flip-up LCD screen	S	S	S	S
Drink holders	S	S	S	S
Intruder Entry	350	373	377	391
Electric entrance step	S	S	S	S
Battery access in stairwell	S	S	S	S
Intruder Exterior	350	373	377	391
Partial paint package with deluxe graphics	S	S	S	S
Full-body paint package including color-coordinated slideroom awnings	0	0	0	0
Fog lights	S	S	S	S
Wide-body design	S	S	S	S
Radius-cornered domed TPO roof	S	S	S	S
Rear ladder	S	S	S	S
Aerodynamic front and rear fiberglass caps	S	S	S	S
Side-mounted patio awning	S	S	S	S
Electric patio awning with remote	0	0	0	0
Side-mounted awning over slideout	S	S	S	S
Entry-assist lighted grab handle	S	S	S	S
Upgraded gelcoated sidewall	S	S	S	S
Locking exterior storage doors	S	S	S	S
White-trimmed, radius-topped entrance door with deadbolt lock and black-trimmed clear window with shade and valance	S	S	S	S
Black-framed, radius-cornered windows	S	S	S	S
Black-framed dual-pane windows	0	0	0	0
Two patio lights (one on each side)	S	S	S	S
Easy-to-clean, lighted, rotocast storage compartments	S	S	S	S
Full basement pass-through storage	S	S	S	S
Gas pistons on exterior storage doors	S	S	S	S
Invisible bra	0	0	0	0
Intruder Kitchen	350	373	377	391
Refrigerator: large flush-mounted, double-door	S	S	S	S
Refrigerator: large flush-mounted, double-door with icemaker	0	0	0	0
Refrigerator: side-by-side with icemaker IPO standard refrigerator and pantry	0	0	0	0
Refrigerator: raised-panel, hardwood front (oak or maple)	S	S	S	S
3-burner range and oven	S	S	S	S
Solid-surface range cover	S	S	S	S
Cooktop IPO range and oven (requires convection microwave)	0	0	0	0
Microwave oven	S	S	S	S
Microwave/convection oven	0	0	0	0
Lighted power range hood	S	S	S	S
Monitor panel with LPG readout	S	S	S	S
Solid-surface sink cover(s)	S	S	S	S
Single-lever faucet with sprayer	S	S	S	S
Kitchen faucet water filter	0	0	0	0
Pantry	S	S	S	S
Solid-surface countertops	S	S	S	S
Solid-wood, raised-panel cabinet doors (upper and lower)	S	S	S	S
Vinyl tile flooring	S	S	S	S

Freestanding dinette with 2 chairs	S	S	S	S
2 folding chairs (available with freestanding dinette or buffet)	0	0	0	0
Buffet with additional storage	0	0	0	N/A
Booth dinette	0	0	0	N/A
Mini blinds	S	S	S	S
Fantastic® power vent	S	S	S	S
Wallpaper border	S	S	S	S
Intruder Living Area	350	373	377	391
Incliner with footrest (cloth)	N/A	N/A	N/A	S
Incliner with footrest (ultra-leather)	N/A	N/A	N/A	0
Euro recliner with leather seating surface and ottoman (passenger side)	S	S	S	N/A
Hide-a-bed (cloth)	S	S	S	S
Day/night shades	S	S	S	S
100% nylon carpeting with stain treatment and padding	S	S	S	S
27-inch color TV in cockpit overhead with full-function remote, antenna booster and jack	S	S	S	N/A
27-inch color TV in entertainment center with full-function remote, antenna booster and jack	N/A	N/A	N/A	S
Video package (VCR/DVD player and control center)	S	S	S	S
Home theater package (VCR, DVD/CD player and 5-channel Dolby® Pro-Logic receiver amplifier)	0	0	0	0
Soft-touch, padded vinyl ceiling	S	S	S	S
Fluorescent lighting	S	S	S	S
Aisle lights	S	S	S	S
Intruder Utilities	350	373	377	391
Air conditioner: 13,500-BTU ducted central (front)	S	S	S	S
Air conditioner: 15,000-BTU ducted central upgrade (front)	0	0	0	0

Intruder Weights and Measures	350	373	377	391
Chassis	Workhorse/Ford	Workhorse/Ford	Workhorse/Ford	Workhorse/Ford
Wheelbase	228	242	242	256
Overall length	36' 6"	37' 11"	37' 5"	39' 1"
Overall width	101"	101"	101"	101"
Overall height with AC	12' 0"	12' 0"	12' 0"	12' 0"
Std. weight (appx. lbs.)	18,498/17,814	19,297/18,845	18,772/18,433	19,895
GVWR	22K/22K	22K/22K	22K/22K	24K
GCWR	26K/26K	26K/26K	26K/ 26K	30K
Fresh water (appx. gal.)	80	80	80	80
Grey / black water (appx. gal.)	42/50	42/50	50/90	50
LP (lbs.)	103.5	103.5	103.5	103.5
Sleeping capacity	4	4	4	4
Exterior storage capacity (cu. ft.)	165	165	168	172
Interior drawers	26	18	21	13
Interior storage capacity (cu. ft.)	13	11	16	8
Fuel capacity (appx. gal.)	75	75	75	75

Floor plans and specifications are subject to change without notice.



P.O. Box 2888 • Elkhart, IN 46515  
Customer Service: 800-860-3812  
Sales Department: 800-860-5658  
[www.DamonRV.com](http://www.DamonRV.com)

