

BUYER'S GUIDE 2003



Titanium[®]

Glendale Recreational Vehicles

Fifth Wheels — Travel Trailer

Building Quality Recreational Vehicles since 1950

Titanium®

U.S. Patent 6,394,533

Fifth Wheel Specifications

Model	24E29	26E31DS	28E33B	28E33	28E33SB	29E34	29E34MS	29E34RL	30E35DS	30E35RB	31E36MK	32E37	32E37DS
Sleeps (<i>standard build</i>)	4	4	8	6	6	6	6	4	6	9	6	6	6
Overall Length	29'-3"	31'-7"	34'	33'-4"	33'-3"	35'-1"	36'-4"	34'-11"	35'-10"	36'-4"	37'-4"	37'-4"	37'-4"
Overall Exterior Height	12'-5"	12'-9"	12'-4"	12'-5"	12'-8"	12'-11"	12'-8"	12'-8"	12'-8"	12'-8"	12'-9"	12'-9"	12'-9"
Dry Pin Weight (<i>lbs.</i>)	1,531	1,508	1,496	1,684	1,806	1,502	1,412	1,670	1,577	1,635	1,405	1,075	1,562
Dry Weight (<i>lbs.</i>)	6,723	8,228	7,707	7,927	7,860	8,318	8,232	8,303	9,341	8,589	9,121	8,724	9,061
G.V.W.R. (<i>lbs.</i>)	8,613	10,463	9,763	10,251	9,976	10,526	10,423	10,507	11,772	10,851	11,508	11,243	11,418
Main Body Width	96"	96"	96"	96"	96"	96"	96"	96"	96"	96"	96"	96"	96"
Interior Height Measurements (<i>Floor to Ceiling</i>)													
Max. Living Area Height	81"	81"	81"	81"	81"	90"	90"	90"	90"	90"	90"	90"	90"
Max. Bedroom Height	77"	77"	77"	77"	77"	77"	77"	77"	77"	77"	77"	77"	77"
Pin Box Area Clearance	60"	60"	60"	60"	60"	60"	60"	60"	60"	60"	60"	60"	60"

Our team of Engineers take full advantage of the testing capabilities offered by the BOSCH Automotive Proving Grounds test facilities in New Carlisle, Indiana. Titanium fifth wheels are put to the road test for both towability and product durability evaluations. The results of these tests help to continually improve our products.

Getting Hitched

All of our fifth wheel models are designed to provide exceptionally high clearance between the underside of the fifth wheel pin box area, and the top of the sidewall surfaces of pickup truck payload boxes. Generous clearance dimensions assist in providing a level towing character between the RV and the pickup, and provide extra clearance to help prevent any possible contact between the RV and the truck box while traveling on grade. This clearance extends to include most 4 x 4 truck heights.

A word about this Guide

The units described in this guide incorporate components produced by Glendale Recreational Vehicles and related companies and suppliers. During manufacturing, different components than initially scheduled may be used. All illustrations and specifications contained in this book are based on the latest product information available at the time of publication approval. However, because we continually upgrade and improve our product, the right is reserved to make changes at any time, without notice, in colours, materials, equipment, specifications and models. We also reserve the right to add or discontinue models without prior notice. Some equipment shown or described throughout this guide may only be available at extra cost and/or may only be available prior to production. Some options may not be available when your unit is built. Photos and drawings are representative of the products and may differ from actual production models. HOLDING TANK CAPACITIES = U.S. Gallons.



STRUCTURAL HIGHLIGHTS

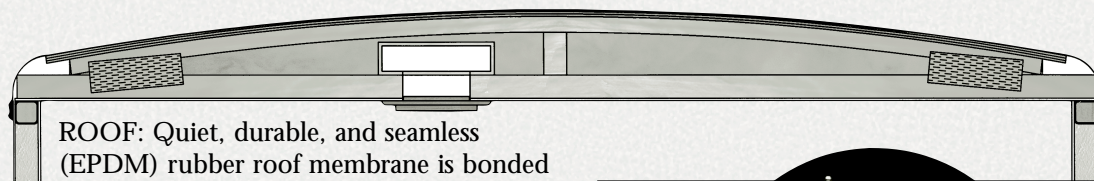

ROOF: Quiet, durable, and seamless (EPDM) rubber roof membrane is bonded to plywood. Full 5½" tapered aluminum crown roof structure proves outstanding strength and superior water drainage. Foam core ducted air conditioner with 3½" batt insulation.

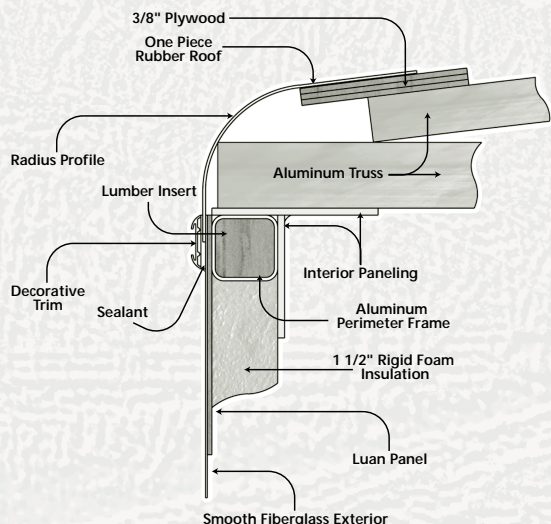

Titanium fifth wheels are constructed using electrically welded 1-1/2" tubular aluminum framing. The aluminum framing is light weight and provides outstanding long term durability.

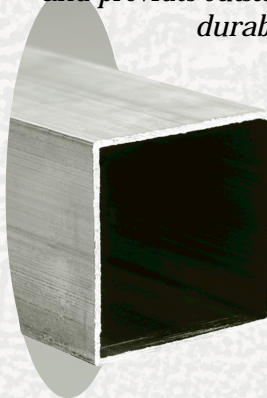

The aluminum framing is used for our engineered roof truss system and for perimeter framing.

2003 Insulation Values

Ceiling	R-12
Sidewall	R-9
Floor	R-16

Superior sidewall strength and excellent thermal values are achieved by utilizing rigid 1½" thermal foam block insulation. The full lamination vacuum bonding process ensures beam-like structural integrity.

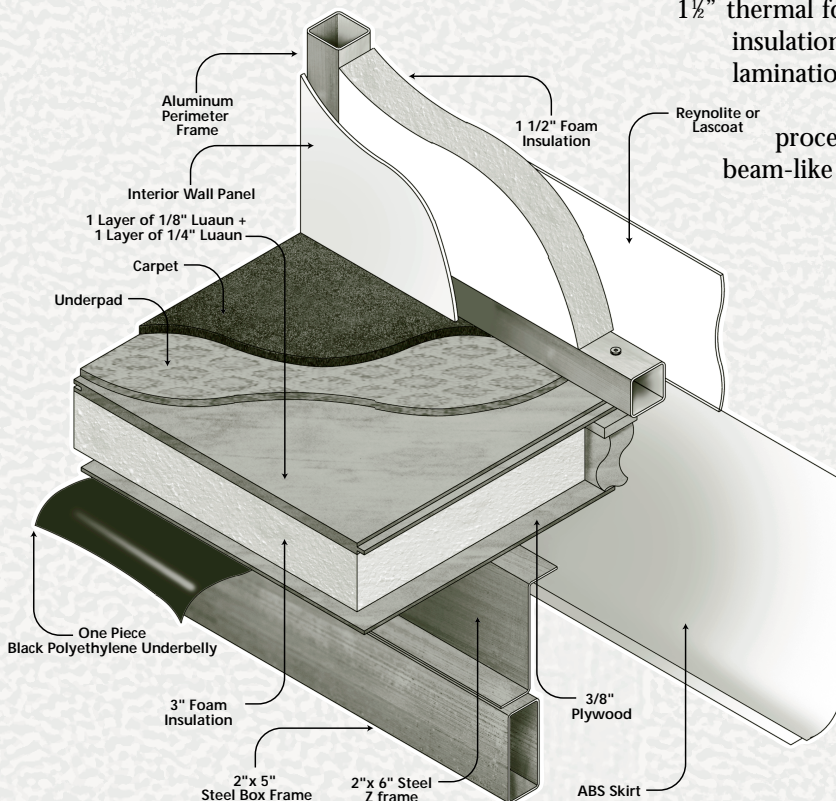

The advantages of our 3" thick composite floor are:

- light weight
- outstanding strength
- superior R-16 thermal insulation

2003 Model Year by Glendale RV

Fifth Wheel 2003 Model Year by Glendale RV

24E29

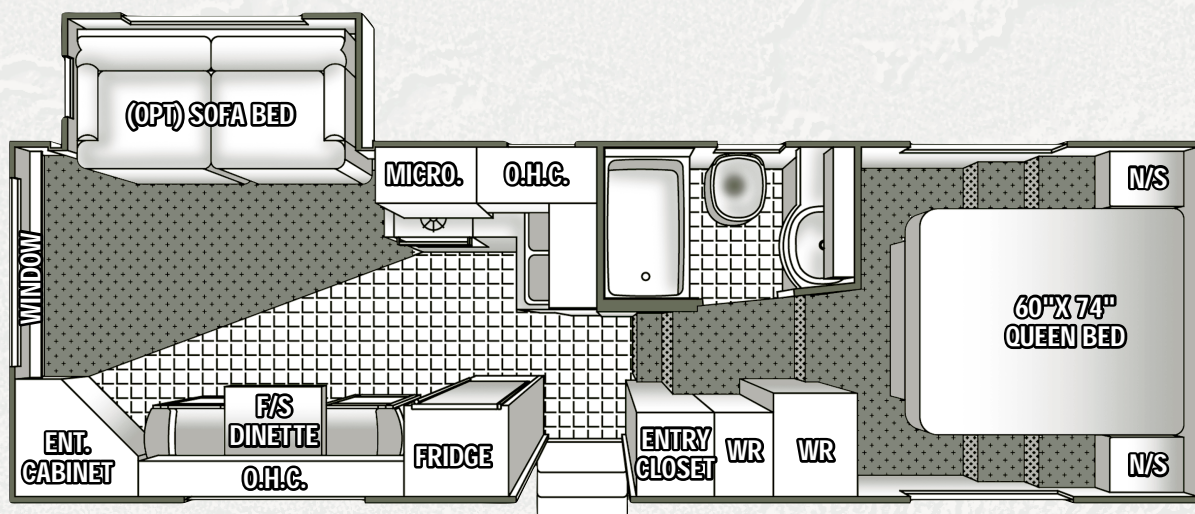

CONSTRUCTION

SIDEWALLS: Vacuum bonded ultra smooth *Lamilux* fiberglass siding. 1-1/2" lightweight aluminum perimeter sidewall framing and 1-1/2" rigid foam insulation.

ROOF: Seamless rubber roof membrane is bonded to 3/8" plywood decking. Full 5-1/2" tapered aluminum truss framing. Thick fiberglass batt insulation. Cathedral ceilings in the bedroom.

FLOOR: Composite laminated floor structure includes 3" foam insulation panel bonded between plywood panels and perimeter framing. *Darco* polythene moisture barrier between chassis underbelly. Seam guard under vinyl floor coverings.

CHASSIS: 11" combination Z channel/steel tube frame construction, twin 5,000 lb. 3" heavy duty axle assemblies, axle shocks at all wheels, *Goodyear* ST225/75R15 "C" radial tires, venting wheel rims, 12" x 2" electric brakes, underslung spare tire and rim, snap release pins on powered front landing gear, power landing gear includes a safety shut-off switch for your added protection, 2 stabilizer jacks, 72 degree adjustable pin box.

SLIDEOUT SPECIFICATIONS: Low maintenance powerful rack and gear 12V direct drive motor system, flush floor design, gear box release lever included for system manual override.

INTERIOR CABINET DOORS: Raised panel oak cabinet doors. Easy-Glide metal roller system on all drawers.

WINDOWS: Radius corner bronze tinted solar reflective glass.

ENTRANCE DOOR: 30" wide radius corner combination entrance door with screen and deadbolt lock, easy fold-away 24" triple rise entry steps, fold-away assist handle on entry door, porch light.

APPLIANCES

REFRIGERATOR: *Dometic* 8 cubic ft. double door, 2 way gas/110v. **RANGE:** *Wedgewood* High Output 21" 3 burner, piezo ignitor.

FURNACE: *Atwood* 2 stage Excaltur furnace 34,000 BTU ducted in floor heat system.

MICROWAVE OVEN: *Dometic* 22" 1.2 cubic ft. with turntable and built in range hood, light and exhaust fan.

AIR CONDITIONER: *Dometic* Briskair 13,500 BTU thermal insulated ducted in ceiling cool air system.

ENTERTAINMENT

STEREO: *Sanyo* MCD-S500 AM/FM stereo CD with remote and clock.

TV ANTENNA: *Winegard* RV antenna with booster.

TV HOOKUP: Coax cable hookup in bedroom and living area.

TELEPHONE JACK: Standard equipment.

SATELLITE HOOKUP: Pre-wired for quick dish connection to the RV.

EXTERIOR SOUND CENTRE: 2 auxiliary speakers.

AWNING

A&E 13' AWNING: Aloe/White. Awning features patented rugged steel roller tube and heavy duty torsion spring with 8' extension.

PLUMBING & ELECTRICAL

Sealand Traveler Lite foot pedal flush china toilet with hand spray (mandatory option), *Lyons* tub and surround, folding shower door, single lever white faucet in kitchen with sprayer, double white sink, bath vanity single lever chrome, water heater by-pass kit.

WATER HEATER: *Atwood* fast recovery 10 gallon gas/electric (*Direct Spark Ignition*).

HOLDING TANKS: Holding tanks are enclosed, insulated and heated. Garden style non-freeze drain tap on fresh water tank, sewage tank flush system.

HOLDING TANK CAPACITIES:

FRESH: 48 gallon **GREY:** 49 gallon **SEWAGE:** 49 gallon

ELECTRICAL CONVERTER: *Magnetek* 7345 solid state circuitry, whisper quiet operation.

HOOKUP: 30 AMP.

STANDARD FEATURES

Free standing dinette with 2 chairs, fiberglass front and back end caps, roof rack and ladder, oak edge counter tops, daveno, exterior rinse shower, venetian blinds, 2 x 30 lb. propane bottles with auto changeover regulator, systems monitor panel, color coordinated ABS lower sidewall skirting, huge under bed storage cavity, 60" x 74" queen bed, oak valances in kitchen, smoke detector, decorative clock over entry way.

OPTIONAL EQUIPMENT

Twin beds, sofa bed, straight dinette chairs, folding dinette chairs, straight table with 2 chairs, day/night shades, thermopane windows, storm windows, polished aluminum rims, exterior security lights, blanket box sofa table, dual powered front landing gear (mandatory option), extended pin box assembly, porcelain toilet (mandatory option), skylight in bathroom, 6,000 lb. axle upgrade.

OPTIONAL FEATURE PACKAGE UPGRADES

ENTERTAINMENT PACKAGE: 27" TV and VCR.

INTERIOR PACKAGE: Fluorescent ceiling lights, day/night shades, oak galley area flooring.

COMFORT PACKAGE: 15,000 BTU air conditioner upgrade, fantastic powered roof vent in bedroom, central vacuum.



**1/2 ton towing capability -
shown here Ford F150 Supercrew.**

29'-3"
Overall Length

24'-3"
Length - Bumper to Pin

8,613 lb.
G.V.W.R.

1,531 lb.
Dry Pin Weight

6,723 lb.
Dry Weight

12'-5"
Overall Height

96"
Main Body Width

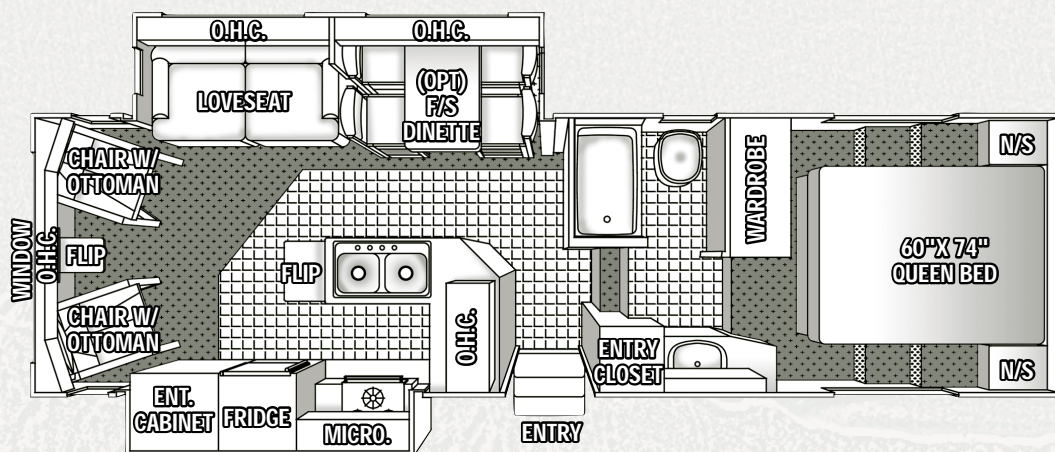

CONSTRUCTION

SIDEWALLS: Vacuum bonded ultra smooth *Lamilux* fiberglass siding, 1-1/2" light weight Aluminum Perimeter sidewall framing, and 1-1/2" rigid foam insulation.

ROOF: Seamless rubber roof membrane is bonded to 3/8" plywood decking. Full 5-1/2" tapered aluminum truss framing. Thick fiberglass batt insulation. Cathedral ceilings in the bedroom.

FLOOR: Composite laminated floor structure includes 3" foam insulation panel bonded between plywood panels and perimeter framing. *Darco* polythene moisture barrier between chassis underbelly. Seam guard under vinyl floor coverings.

CHASSIS: 11" combination Z channel/steel tube frame construction, twin 5,000 lb. 3" heavy duty axle assemblies, axle shocks at all wheels, *Goodyear* ST235/80R16 "D" radial tires, venting wheel rims, 12" x 2" electric brakes, underslung spare tire and rim, snap release pins on powered front landing gear, powered front landing gear includes a safety shut-off switch for your added protection, 2 stabilizer jacks, 72 degree adjustable pin box.

SLIDEOUT SPECIFICATIONS: Low maintenance powerful rack and gear 12V direct drive motor system, flush floor design, gear box release lever included for system manual override.

INTERIOR CABINET DOORS: Combination of flat and raised panel oak cabinet doors. Easy-Glide metal roller system on all drawers.

WINDOWS: Radius corner bronze tinted solar reflective glass.

ENTRANCE DOOR: 30" wide radius corner combination entrance door with screen and deadbolt lock, easy fold-away 24" triple rise entry steps, fold-away assist handle on entry door, porch light.

APPLIANCES

REFRIGERATOR: *Dometic* 8 cubic ft. double door, 2 way gas/110v.

RANGE: *Wedgewood* High Output 21" 3 burner, piezo ignitor.

FURNACE: *Atwood* 2 stage Excalibur furnace 34,000 BTU ducted in floor heat system.

MICROWAVE OVEN: *Dometic* 22" 1.2 cubic ft. with turntable and built in range hood, light and exhaust fan.

AIR CONDITIONER: *Dometic* Briskair 13,500 BTU thermal insulated ducted in ceiling cool air system.

ENTERTAINMENT

STEREO: *Sanyo* MCD-S500 AM/FM stereo CD with remote and clock.

TV ANTENNA: *Winegard* RV antenna with booster.

TV HOOKUP: Coax cable hookup in bedroom and living area.

TELEPHONE JACK: Standard equipment.

SATELLITE HOOKUP: Pre-wired for quick dish connection to the RV.

EXTERIOR SOUND CENTRE: 2 auxiliary speakers.

AWNING

A&E 18' AWNING: Aloe/White. Awning features patented rugged steel roller tube and heavy duty torsion spring with 8' extension.

PLUMBING & ELECTRICAL

Sealand Traveler Lite foot pedal flush china toilet with hand spray (mandatory option), *Lyons* tub with surround, folding shower door, double white sink in kitchen with single lever faucet and hand sprayer, bath vanity single lever chrome, water heater by-pass kit.

WATER HEATER: *Atwood* fast recovery 10 gallon gas/electric (Direct Spark Ignition).

HOLDING TANKS: Holding tanks are enclosed, insulated and heated. Garden style non-freeze drain tap on fresh water tank, sewage tank flush system.

HOLDING TANK CAPACITIES:

FRESH: 48 gallon **GREY:** 49 gallon **SEWAGE:** 49 gallon

ELECTRICAL CONVERTER: *Magnetek* 7345 solid state circuitry, whisper quiet operation.

HOOKUP: 30 AMP.

STANDARD FEATURES

Fiberglass front and back end caps, roof rack and ladder, oak edge counter tops, exterior rinse shower, venetian blinds, 2 x 30 lb. propane bottles with auto changeover regulator, systems monitor panel, color coordinated ABS lower sidewall skirting, smoke detector, decorative wall clock, huge under bed storage cavity, 60" x 80" queen bed, oak valance in kitchen, 2 chairs with ottomans.

OPTIONAL EQUIPMENT

Twin beds, Oak free standing dinette in place of booth style dinette, day/night shades, Loveseat (mandatory option), thermopane windows, storm windows, polished aluminum rims, exterior security lights, dual front landing gear (mandatory option), porcelain toilet (mandatory option), electric fireplace, skylight above shower with inner dome, 6,000 lb. axle upgrade.

OPTIONAL FEATURE PACKAGE UPGRADES

ENTERTAINMENT PACKAGE: *Panasonic* 27" TV and VCR.

INTERIOR PACKAGE: Fluorescent ceiling lights, day/night shades, Oak galley area flooring.

COMFORT PACKAGE: 15,000 BTU air conditioner upgrade, fantastic powered roof vent in bedroom, central vacuum, paddle fan.

26E31DS Fifth Wheel
2003 Model Year
by Glendale RV

31'-7"
Overall Length

26'-9"
Length - Bumper to Pin

10,463 lb.
G.V.W.R.

1,508 lb.
Dry Pin Weight

8,228 lb.
Dry Weight

12'-9"
Overall Height

96"
Main Body Width

28E33B

Fifth Wheel 2003 Model Year by Glendale RV

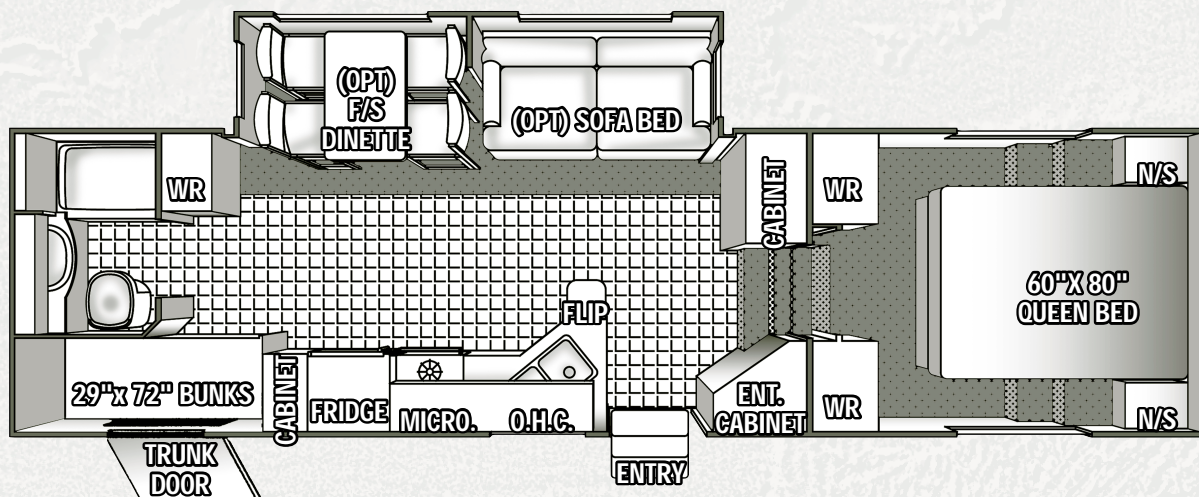

CONSTRUCTION

SIDEWALLS: Vacuum bonded ultra smooth fiberglass siding, 1-1/2" rigid foam insulation.
ROOF: Seamless rubber roof membrane is bonded to 3/8" plywood decking. Full 5-1/2" tapered aluminum truss framing. Thick fiberglass batt insulation. Cathedral ceilings in the bedroom.
FLOOR: Composite laminated floor structure includes 3" foam insulation panel bonded between plywood panels and perimeter framing. **Darco** polythene moisture barrier between chassis underbelly. Seam guard under vinyl floor coverings.
CHASSIS: 11" combination Z channel/steel tube frame construction, twin 5,000 lb. 3" heavy duty axle assemblies, axle shocks at all wheels, **Goodyear** ST225/75R15 "C" radial tires, venting wheel rims, 12" x 2" electric brakes, underslung spare tire and rim, snap release pins on powered front landing gear, power landing gear includes a safety shut-off switch for your added protection, 2 stabilizer jacks, 72 degree adjustable pin box.
SLIDEOUT SPECIFICATIONS: Low maintenance powerful rack and gear 12V direct drive motor system, flush floor design, gear box release lever included for system manual override.
INTERIOR CABINET DOORS: Combination of flat and raised panel oak cabinet doors. Easy-Glide metal roller system on all drawers.
WINDOWS: Radius corner bronze tinted solar reflective glass.
ENTRANCE DOOR: 30" wide radius corner combination entrance door with screen and deadbolt lock, easy fold-away 24" triple rise entry steps, fold-away assist handle on entry door, porch light.

APPLIANCES

REFRIGERATOR: **Dometic** 8 cubic ft. double door, 2 way gas/110v.
RANGE: **Wedgewood** High Output 21" 3 burner, piezo ignitor.
FURNACE: **Atwood** 2 stage Excalibur furnace 34,000 BTU ducted in floor heat system.
MICROWAVE OVEN: **Dometic** 22" 1.2 cubic ft. with turntable and built in range hood, light and exhaust fan.
AIR CONDITIONER: **Dometic** Briskair 13,500 BTU thermal insulated ducted in ceiling cool air system.

ENTERTAINMENT

STEREO: **Sanyo** MCD-S500 AM/FM stereo CD with remote and clock.
TV ANTENNA: **Winegard** RV antenna with booster.
TV HOOKUP: Coax cable hookup in bedroom and living area.

AWNING

A&E 20' AWNING: Aloe/White. Awning features patented rugged steel roller tube and heavy duty torsion spring with 8' extension.

PLUMBING & ELECTRICAL

Sealand Traveler Lite foot pedal flush china toilet with hand spray (mandatory option), **Lyons** tub and surround, folding shower door, single lever white faucet in kitchen with sprayer, double white sink, bath vanity single lever chrome, water heater by-pass kit.
WATER HEATER: **Atwood** fast recovery 10 gallon gas/electric (Direct Spark Ignition).
HOLDING TANKS: Garden style drain tap on fresh water tank.
HOLDING TANK CAPACITIES:
FRESH: 48 gallon **GREY:** 49 gallon **SEWAGE:** 49 gallon
ELECTRICAL CONVERTER: **Magnetek** 6345 solid state circuitry, whisper quiet operation.
HOOKUP: 30 AMP.

STANDARD FEATURES

Fiberglass front and back end caps, roof rack and ladder, oak edge counter tops, daveno, exterior rinse shower, 2 x 30 lb. propane bottles with auto changeover regulator, venetian blinds, systems monitor panel, color coordinated ABS lower sidewall skirting, huge under bed storage cavity, 60" x 80" queen bed, oak valance in kitchen, french doors in bedroom.

OPTIONAL EQUIPMENT

Twin beds, sofa bed, free standing dinette in place of booth style dinette, day/night shades, thermopane windows, storm windows, polished aluminum rims, exterior security lights, axle shock kit, dual powered front landing gear (mandatory option), satellite dish hook-up, porcelain toilet (mandatory option), enclosed insulated holding tanks, skylight with inner dome installed in bathroom, 6,000 lb. axle upgrade.

OPTIONAL FEATURE PACKAGE UPGRADES

ENTERTAINMENT PACKAGE: 27" TV and VCR.



Convenient Travel Storage

34'
Overall Length

28'-5"
Length - Bumper to Pin

9,763 lb.
G.V.W.R.

1,496 lb.
Dry Pin Weight

7,707 lb.
Dry Weight

12'-4"
Overall Height

96"
Main Body Width

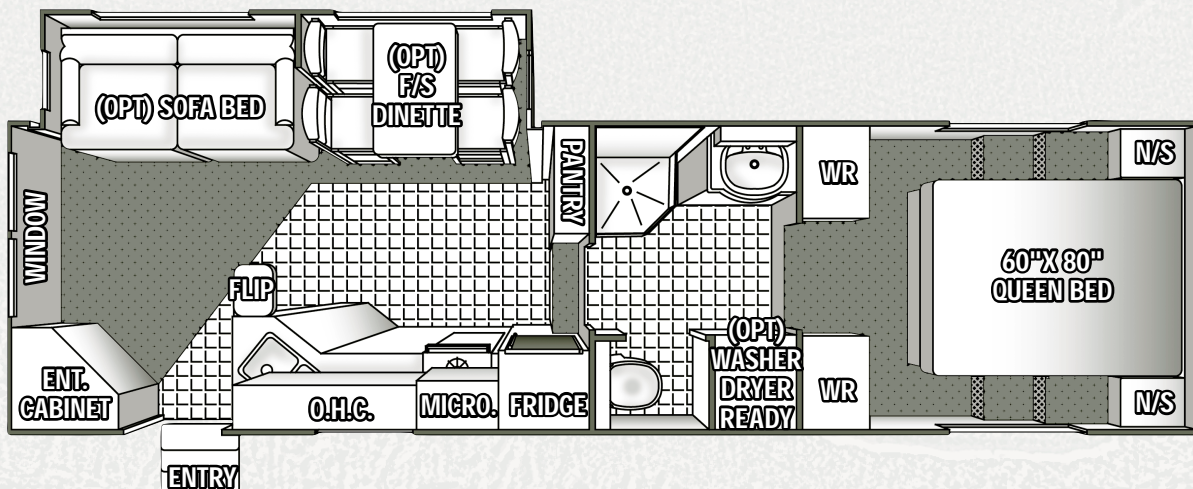

28E33

Fifth Wheel
2003 Model Year
by Glendale RV

CONSTRUCTION

SEIOWALLS: Vacuum bonded ultra smooth *Lamilux* fiberglass siding. 1-1/2" lightweight aluminum perimeter sidewall framing and 1-1/2" rigid foam insulation.

ROOF: Seamless rubber roof membrane is bonded to 3/8" plywood decking. Full 5-1/2" tapered aluminum truss framing. Thick fiberglass batt insulation. Cathedral ceilings in the bedroom.

FLOOR: Composite laminated floor structure includes 3" foam insulation panel bonded between plywood panels and perimeter framing. *Darco* polythene moisture barrier between chassis underbelly. Seam guard under vinyl floor coverings.

CHASSIS: 11" combination Z channel/steel tube frame construction, twin 5,000 lb. 3" heavy duty axle assemblies, axle shocks at all wheels, *Goodyear* ST235/80R16 "D" radial tires, venting wheel rims, 12" x 2" electric brakes, underslung spare tire and rim, snap release pins on powered front landing gear, power landing gear includes a safety shut-off switch for your added protection, 2 stabilizer jacks, 72 degree adjustable pin box.

SLIDEOUT SPECIFICATIONS: Low maintenance powerful rack and gear 12V direct drive motor system, flush floor design, gear box release lever included for system manual override.

INTERIOR CABINET DOORS: Raised panel oak cabinet doors. Easy-Glide metal roller system on all drawers.

WINDOWS: Radius corner bronze tinted solar reflective glass.

ENTRANCE DOOR: 30" wide radius corner combination entrance door with screen and deadbolt lock, easy fold-away 24" triple rise entry steps, fold-away assist handle on entry door, porch light.

APPLIANCES

REFRIGERATOR: *Dometic* 8 cubic ft. double door, 2 way gas/110v. **RANGE:** *Wedgewood* High Output 21" 3 burner, piezo ignitor.

FURNACE: *Atwood* 2 stage Excalibur furnace 34,000 BTU ducted in floor heat system.

MICROWAVE OVEN: *Dometic* 22" 1.2 cubic ft. with turntable and built in range hood, light and exhaust fan.

AIR CONDITIONER: *Dometic* Briskair 13,500 BTU thermal insulated ducted in ceiling cool air system.

ENTERTAINMENT

STEREO: *Sanyo* MCD-S500 AM/FM stereo CD with remote and clock.

TV ANTENNA: *Winegard* RV antenna with booster.

TV HOOKUP: Coax cable hookup in bedroom and living area.

TELEPHONE JACK: Standard equipment.

SATELLITE HOOKUP: Pre-wired for quick dish connection to the RV.

EXTERIOR SOUND CENTRE: 2 auxiliary speakers.

AWNING

A&E 19' AWNING: Aloe/White. Awning features patented rugged steel roller tube and heavy duty torsion spring with 8' extension.

PLUMBING & ELECTRICAL

Sealand Traveler Lite foot pedal flush china toilet with hand spray (mandatory option), *Lyons* corner shower with surround, double white sink in kitchen with single lever faucet and hand sprayer, bath vanity single lever chrome, water heater by-pass kit.

WATER HEATER: *Atwood* fast recovery 10 gallon gas/electric (*Direct Spark Ignition*).

HOLDING TANKS: Holding tanks are enclosed, insulated and heated. Garden style non-freeze drain tap on fresh water tank, sewage tank flush system.

HOLDING TANK CAPACITIES:

FRESH: 48 gallon *GREY:* 49 gallon *SEWAGE:* 49 gallon

ELECTRICAL CONVERTER: *Magnetek* 7345 solid state circuitry, whisper quiet operation.

HOOKEUP: 30 AMP.

STANDARD FEATURES

Fiberglass front and back end caps, roof rack and ladder, oak edge counter tops, daveno, exterior rinse shower, venetian blinds, 2 x 30 lb. propane bottles with auto changeover regulator, systems monitor panel, color coordinated ABS lower sidewall skirting, smoke detector, huge under bed storage cavity, 60" x 80" queen bed, oak valance in kitchen, french doors in bedroom.

OPTIONAL EQUIPMENT

Twin beds, sofa bed, oak free standing dinette in place of booth style dinette, day/night shades, thermopane windows, storm windows, polished aluminum rims, exterior security lights, dual front landing gear (mandatory option), porcelain toilet (mandatory option), electric fireplace, washer dryer ready, generator ready connection, skylight above shower with inner dome, blanket box style sofa table, 6,000 lb. axle upgrade.

OPTIONAL FEATURE PACKAGE UPGRADES

ENTERTAINMENT PACKAGE: 27" TV and VCR.

INTERIOR PACKAGE: Fluorescent ceiling lights, day/night shades, oak galley area flooring.

COMFORT PACKAGE: 15,000 BTU air conditioner upgrade, fantastic powered roof vent in bedroom, central vacuum, paddle fan.



Blanket Box Sofa
Table (optional).

33'-4"
Overall Length

28'-4"
Length - Bumper to Pin

10,251 lb.
G.V.W.R.

1,684 lb.
Dry Pin Weight

7,927 lb.
Dry Weight

12'-5"
Overall Height

96"
Main Body Width

Titanium 28E33SB Fifth Wheel 2003 Model Year by Glendale RV

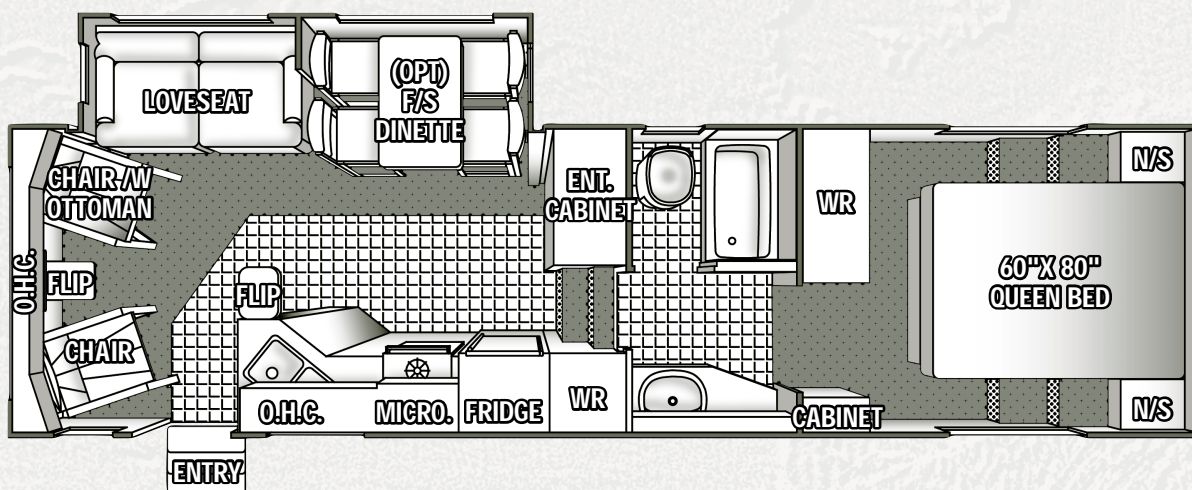

CONSTRUCTION

SIDEWALLS: Vacuum bonded ultra smooth *Lamilux* fiberglass siding. 1-1/2" lightweight aluminum perimeter sidewall framing and 1-1/2" rigid foam insulation.

ROOF: Seamless rubber roof membrane is bonded to 3/8" plywood decking. Full 5-1/2" tapered aluminum truss framing. Thick fiberglass batt insulation. Cathedral ceilings in the bedroom.

FLOOR: Composite laminated floor structure includes 3" foam insulation panel bonded between plywood panels and perimeter framing. *Darco* polythene moisture barrier between chassis underbelly. Seam guard under vinyl floor coverings.

CHASSIS: 11" combination Z channel/steel tube frame construction, twin 5,000 lb. 3" heavy duty axle assemblies, axle shocks at all wheels, *Goodyear* ST235/80R16 "D" radial tires, venting wheel rims, 12" x 2" electric brakes, underslung spare tire and rim, snap release pins on powered front landing gear, power landing gear includes a safety shut-off switch for your added protection, 2 stabilizer jacks, 72 degree adjustable pin box.

SLIDEOUT SPECIFICATIONS: Low maintenance powerful rack and gear 12V direct drive motor system, flush floor design, gear box release lever included for system manual override.

INTERIOR CABINET DOORS: Raised panel oak cabinet doors. Easy-Glide metal roller system on all drawers.

WINDOWS: Radius corner bronze tinted solar reflective glass.

ENTRANCE DOOR: 30" wide radius corner combination entrance door with screen and deadbolt lock, easy fold-away 24" triple rise entry steps, fold-away assist handle on entry door, porch light.

APPLIANCES

REFRIGERATOR: *Domestic* 8 cubic ft. double door, 2 way gas/110v.

RANGE: *Wedgewood* High Output 21" 3 burner, piezo ignitor.

FURNACE: *Atwood* 2 stage Excalturb furnace 34,000 BTU ducted in floor heat system.

MICROWAVE OVEN: *Domestic* 22" 1.2 cubic ft. with turntable and built in range hood, light and exhaust fan.

AIR CONDITIONER: *Domestic* Briskair 13,500 BTU thermal insulated ducted in ceiling cool air system.

ENTERTAINMENT

STEREO: *Sanyo* MCD-S500 AM/FM stereo CD with remote and clock.

TV ANTENNA: *Winegard* RV antenna with booster.

TV HOOKUP: Coax cable hookup in bedroom and living area.

TELEPHONE JACK: Standard equipment.

SATELLITE HOOKUP: Pre-wired for quick dish connection to the RV.

EXTERIOR SOUND CENTRE: 2 auxiliary speakers.

AWNING

A&E 19' AWNING: Aloe/White. Awning features patented rugged steel roller tube and heavy duty torsion spring . 8' extension.

PLUMBING & ELECTRICAL

Sealand Traveler Lite foot pedal flush china toilet with hand spray (mandatory option), *Lyons* tub and surround, folding shower door, double white sink in kitchen with single lever faucet and hand sprayer, bath vanity single lever chrome, water heater by-pass kit.

WATER HEATER: *Atwood* fast recovery 10 gallon gas/electric (Direct Spark Ignition).

HOLDING TANKS: Holding tanks are enclosed, insulated and heated. Garden style non-freeze drain tap on fresh water tank, sewage tank flush system.

HOLDING TANK CAPACITIES:

FRESH: 48 gallon *GREY:* 49 gallon *SEWAGE:* 49 gallon

ELECTRICAL CONVERTER: *Magnetek* 7345 solid state circuitry, whisper quiet operation.

HOOKUP: 30 AMP.

STANDARD FEATURES

Fiberglass front and back end caps, roof rack and ladder, oak edge counter tops, exterior rinse shower, venetian blinds, 2 x 30 lb. propane bottles with auto changeover regulator, systems monitor panel, color coordinated ABS lower sidewall skirting, smoke detector, huge under bed storage cavity, 60" x 80" queen bed, chairs with ottoman, oak valances in kitchen area, french doors in bedroom.

OPTIONAL EQUIPMENT

Twin beds, loveseat (mandatory option), oak free standing dinette in place of booth style dinette, day/night shades, thermopane windows, storm windows, polished aluminum rims, exterior security lights, dual powered front landing gear (mandatory option), porcelain toilet (mandatory option), electric fireplace, generator ready connection, skylight in bathroom, 6,000 lb. axle upgrade.

OPTIONAL FEATURE PACKAGE UPGRADES

ENTERTAINMENT PACKAGE: 27" TV and VCR.

INTERIOR PACKAGE: Fluorescent ceiling lights, day/night shades, oak galley area flooring.

COMFORT PACKAGE: 15,000 BTU air conditioner upgrade, fantastic powered roof vent in bedroom, central vacuum, paddle fan.

**Included in all Titanium models
HUGE UNDER BED
STORAGE CAVITY!**

33'-3"
Overall Length

28'-4"
Length - Bumper to Pin

9,976 lb.
G.V.W.R.

1,806 lb.
Dry Pin Weight

7,860 lb.
Dry Weight

12'-8"
Overall Height

96"
Main Body Width

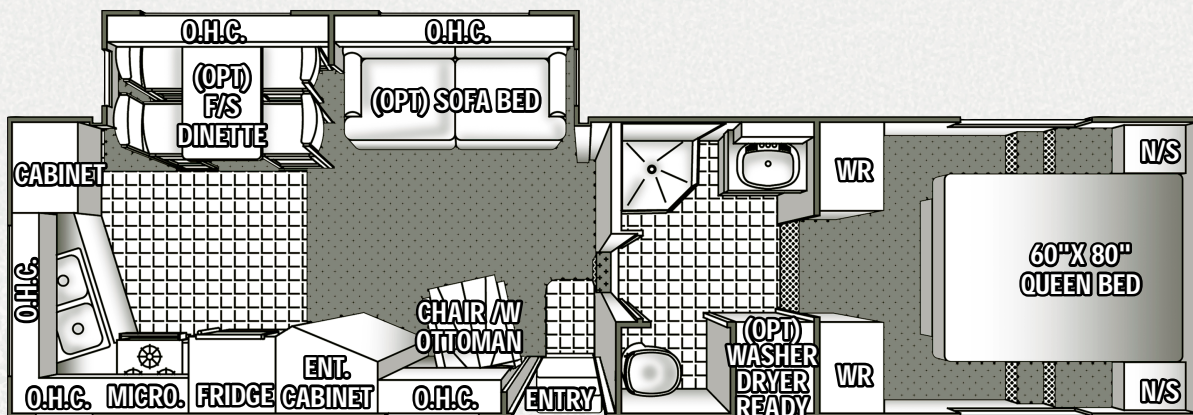

29E34

Fifth Wheel
2003 Model Year
 by Glendale RV

CONSTRUCTION

SIDEWALLS: Vacuum bonded ultra smooth *Lamilux* fiberglass siding. 1-1/2" lightweight aluminum perimeter sidewall framing and 1-1/2" rigid foam insulation.

ROOF: Seamless rubber roof membrane is bonded to 3/8" plywood decking. Full 5-1/2" tapered aluminum truss framing. Thick fiberglass batt insulation. Cathedral ceilings in the bedroom.

FLOOR: Composite laminated floor structure includes 3" foam insulation panel bonded between plywood panels and perimeter framing. *Darco* polythene moisture barrier between chassis underbelly. Seam guard under vinyl floor coverings.

CHASSIS: 11" combination Z channel/steel tube frame construction, twin 5,000 lb. 3" heavy duty axle assemblies, axle shocks at all wheels, *Goodyear* ST235/80R16 "D" radial tires, venting wheel rims, 12" x 2" electric brakes, underslung spare tire and rim, snap release pins on powered front landing gear, power landing gear includes a safety shut-off switch for your added protection, 2 stabilizer jacks, 72 degree adjustable pin box.

SLIDEOUT SPECIFICATIONS: Low maintenance powerful rack and gear 12V direct drive motor system, flush floor design, gear box release lever included for system manual override.

INTERIOR CABINET DOORS: Raised panel oak cabinet doors. Easy-Glide metal roller system on all drawers.

WINDOWS: Radius corner bronze tinted solar reflective glass.

ENTRANCE DOOR: 30" wide radius corner combination entrance door with screen and deadbolt lock, easy fold-away 24" triple rise entry steps, fold-away assist handle on entry door, porch light.

APPLIANCES

REFRIGERATOR: *Dometic* 8 cubic ft. double door, 2 way gas/110v.

RANGE: *Wedgewood* High Output 21" 3 burner, piezo ignitor.

FURNACE: *Atwood* 2 stage Excalibur furnace 34,000 BTU ducted in floor heat system.

MICROWAVE OVEN: *Dometic* 22" 1.2 cubic ft. with turntable and built in range hood, light and exhaust fan.

AIR CONDITIONER: *Dometic* Briskair 13,500 BTU thermal insulated ducted in ceiling cool air system.

ENTERTAINMENT

STEREO: *Sanyo* MCD-S500 AM/FM stereo CD with remote and clock.

TV ANTENNA: *Winegard* RV antenna with booster.

TV HOOKUP: Coax cable hookup in bedroom and living area.

TELEPHONE JACK: Standard equipment.

SATELLITE HOOKUP: Pre-wired for quick dish connection to the RV.

EXTERIOR SOUND CENTRE: 2 auxiliary speakers.

AWNING

A&E 19' AWNING: Aloe/White. Awning features patented rugged steel roller tube and heavy duty torsion spring. 8' extension.

PLUMBING & ELECTRICAL

Sealand Traveler Lite foot pedal flush china toilet with hand spray (mandatory option), *Lyons* corner shower with surround, double white sink in kitchen with single lever faucet and hand sprayer, bath vanity single lever chrome, water heater by-pass kit.

WATER HEATER: *Atwood* fast recovery 10 gallon gas/electric (*Direct Spark Ignition*).

HOLDING TANKS: Holding tanks are enclosed, insulated and heated. Garden style non-freeze drain tap on fresh water tank, sewage tank flush system.

HOLDING TANK CAPACITIES:

FRESH: 48 gallon *GREY:* 49 gallon *SEWAGE:* 49 gallon

ELECTRICAL CONVERTER: *Magnetek* 7345 solid state circuitry, whisper quiet operation.

HOOKUP: 30 AMP.

STANDARD FEATURES

Fiberglass front and back end caps, roof rack and ladder, oak edge counter tops, exterior rinse shower, venetian blinds, 2 x 30 lb. propane bottles with auto changeover regulator, systems monitor panel, color coordinated ABS lower sidewall skirting, smoke detector, huge under bed storage cavity, 60" x 80" queen bed, chair with ottoman, oak valances in kitchen, french doors in bedroom, *new* overhead cabinets in slideout area 13" deep, 9" height, decorative clock over doorway.

OPTIONAL EQUIPMENT

Twin beds, oak free standing dinette in place of booth style dinette, wall-a-way recliner, sofa bed, day/night shades, thermopane windows, storm windows, polished aluminum rims, exterior security lights, dual front landing gear (mandatory option), porcelain toilet (mandatory option), electric fireplace, washer dryer ready, generator ready connection, skylight in bathroom, 6,000 lb. axle upgrade.

OPTIONAL FEATURE PACKAGE UPGRADES

ENTERTAINMENT PACKAGE: 27" TV and VCR.

INTERIOR PACKAGE: Fluorescent ceiling lights, day/night shades, oak galley area flooring.

COMFORT PACKAGE: 15,000 BTU air conditioner upgrade, fantastic powered roof vent in bedroom, central vacuum, paddle fan.

**SPACIOUS REAR
 KITCHEN DESIGN**
*with an abundant amount of
 overhead cabinet space!*

35'-1"
 Overall Length

29'-3"
 Length - Bumper to Pin

10,526 lb.
 G.V.W.R.

1,502 lb.
 Dry Pin Weight

8,318 lb.
 Dry Weight

12'-11"
 Overall Height

96"
 Main Body Width

**Fifth Wheel
2003 Model Year
by Glendale RV**

29E34MS

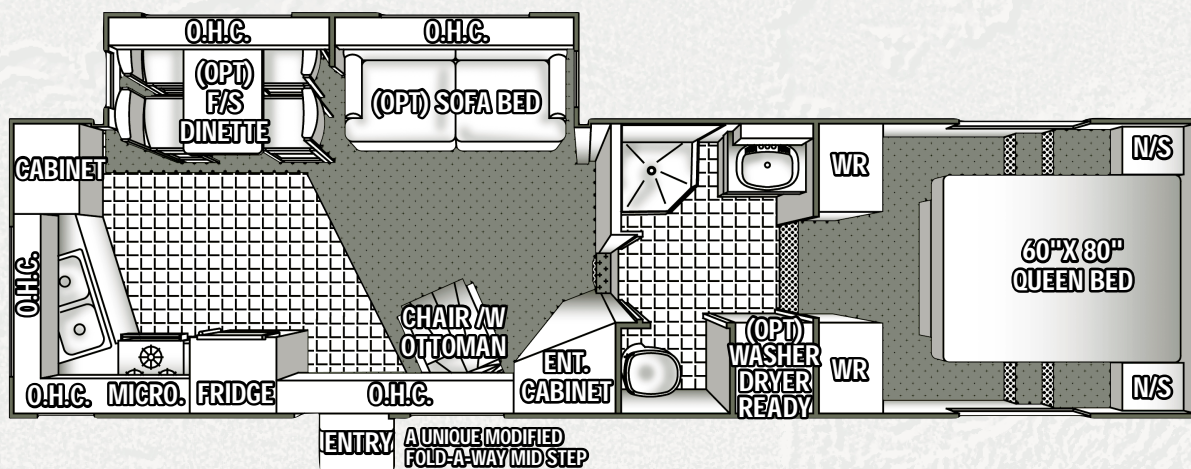

CONSTRUCTION

SIDEWALLS: Vacuum bonded ultra smooth *Lamilux* fiberglass siding. 1-1/2" lightweight aluminum perimeter sidewall framing and 1-1/2" rigid foam insulation.

ROOF: Seamless rubber roof membrane is bonded to 3/8" plywood decking. Full 5-1/2" tapered aluminum truss framing. Thick fiberglass batt insulation. Cathedral ceilings in the bedroom.

FLOOR: Composite laminated floor structure includes 3" foam insulation panel bonded between plywood panels and perimeter framing. *Darco* polythylene moisture barrier between chassis underbelly. Seam guard under vinyl floor coverings.

CHASSIS: 11" combination Z channel/steel tube frame construction, twin 5,000 lb. 3" heavy duty axle assemblies, axle shocks at all wheels, *Goodyear* ST235/80R16 "D" radial tires, venting wheel rims, 12" x 2" electric brakes, underslung spare tire and rim, snap release pins on powered front landing gear, power landing gear includes a safety shut-off switch for your added protection, 2 stabilizer jacks, 72 degree adjustable pin box.

SLIDEOUT SPECIFICATIONS: Low maintenance powerful rack and gear 12V direct drive motor system, flush floor design, gear box release lever included for system manual override.

INTERIOR CABINET DOORS: Raised panel oak cabinet doors. Easy-Glide metal roller system on all drawers.

WINDOWS: Radius corner bronze tinted solar reflective glass.

ENTRANCE DOOR: 30" wide radius corner combination entrance door with screen and deadbolt lock, unique modified fold-away mid step, fold-away assist handle on entry door, porch light.

APPLIANCES

REFRIGERATOR: *Domestic* 8 cubic ft. double door, 2 way gas/110v.

RANGE: *Wedgewood* High Output 21" 3 burner, piezo ignitor.

FURNACE: *Atwood* 2 stage Excalturb furnace 34,000 BTU ducted in floor heat system.

MICROWAVE OVEN: *Domestic* 22" 1.2 cubic ft. with turntable and built in range hood, light and exhaust fan.

AIR CONDITIONER: *Domestic* Briskair 13,500 BTU thermal insulated ducted in ceiling cool air system.

ENTERTAINMENT

STEREO: *Sanyo* MCD-S500 AM/FM stereo CD with remote and clock.

TV ANTENNA: *Winegard* RV antenna with booster.

TV HOOKUP: Coax cable hookup in bedroom and living area.

TELEPHONE JACK: Standard equipment.

SATELLITE HOOKUP: Pre-wired for quick dish connection to the RV.

EXTERIOR SOUND CENTRE: 2 auxiliary speakers.

AWNING

A&E 19' AWNING: Aloe/White. Awning features patented rugged steel roller tube and heavy duty torsion spring. 8' extension.

PLUMBING & ELECTRICAL

Sealand Traveler Lite foot pedal flush china toilet with hand spray (mandatory option), *Lyons* corner shower with surround, double white sink in kitchen with single lever faucet and hand sprayer, bath vanity single lever chrome, water heater by-pass kit.

WATER HEATER: *Atwood* fast recovery 10 gallon gas/electric (Direct Spark Ignition).

HOLDING TANKS: Holding tanks are enclosed, insulated and heated. Garden style non-freeze drain tap on fresh water tank, sewage tank flush system.

HOLDING TANK CAPACITIES:

FRESH: 48 gallon **GREY:** 49 gallon **SEWAGE:** 49 gallon

ELECTRICAL CONVERTER: *Magnetek* 7345 solid state circuitry, whisper quiet operation.

HOOKUP: 30 AMP.

STANDARD FEATURES

Fiberglass front and back end caps, roof rack and ladder, oak edge counter tops, exterior rinse shower, venetian blinds, 2 x 30 lb. propane bottles with auto changeover regulator, systems monitor panel, color coordinated ABS lower sidewall skirting, smoke detector, huge under bed storage cavity, 60" x 80" queen bed, chair with ottoman, fold-away mid step, oak valance in kitchen, smoke detector, french doors in bedroom, *new* overhead cabinets in slideout area 13" deep, 9" height, *new* overhead cabinets in entry way 34" width, 21" height, 9" deep.

OPTIONAL EQUIPMENT

Twin beds, oak free standing dinette in place of booth style dinette, wall-a-way recliner, day/night shades, thermopane windows, storm windows, polished aluminum rims, exterior security lights, dual front powered landing gear (mandatory option), porcelain toilet (mandatory option), electric fireplace, washer dryer ready, generator ready connection, skylight in bathroom, 6,000 lb. axle upgrade.

OPTIONAL FEATURE PACKAGE UPGRADES

ENTERTAINMENT PACKAGE: 27" TV and VCR.

INTERIOR PACKAGE: Fluorescent ceiling lights, day/night shades, oak galley area flooring.

COMFORT PACKAGE: 15,000 BTU air conditioner upgrade, fantastic powered roof vent in bedroom, central vacuum, paddle fan.



*This unique
modified fold-away
mid step design.*

34'-11"
Overall Length

29'-3"
Length - Bumper to Pin

10,423 lb.
G.V.W.R.

1,412 lb.
Dry Pin Weight

8,232 lb.
Dry Weight

12'-8"
Overall Height

96"
Main Body Width

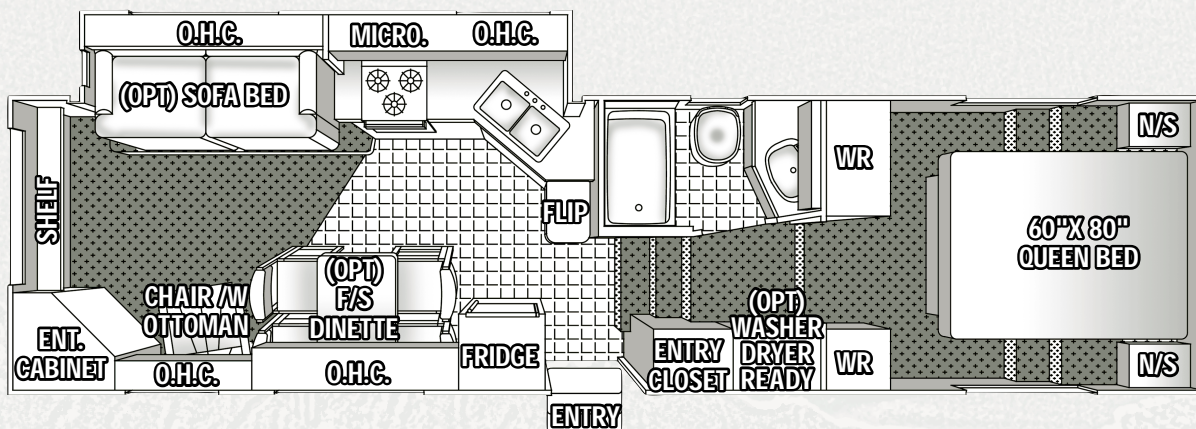

CONSTRUCTION

SIDEWALLS: Vacuum bonded ultra smooth *Lamilux* fiberglass siding. 1-1/2" lightweight aluminum perimeter sidewall framing and 1-1/2" rigid foam insulation.

ROOF: Seamless rubber roof membrane is bonded to 3/8" plywood decking. Full 5-1/2" tapered aluminum truss framing. Thick fiberglass batt insulation. Cathedral ceilings in the bedroom.

FLOOR: Composite laminated floor structure includes 3" foam insulation panel bonded between plywood panels and perimeter framing. *Darco* polythlene moisture barrier between chassis underbelly. Seam guard under vinyl floor coverings.

CHASSIS: 11" combination Z channel/steel tube frame construction, twin 5,000 lb. 3" heavy duty axle assemblies, axle shocks at all wheels, *Goodyear* ST235/80R16 "D" radial tires, venting wheel rims, 12" x 2" electric brakes, underslung spare tire and rim, snap release pins on powered front landing gear, power landing gear includes a safety shut-off switch for your added protection, 2 stabilizer jacks, 72 degree adjustable pin box.

SLIDEOUT SPECIFICATIONS: Low maintenance powerful rack and gear 12V direct drive motor system, gear box release lever included for system manual override.

INTERIOR CABINET DOORS: Raised panel oak cabinet doors. Easy-Glide metal roller system on all drawers.

WINDOWS: Radius corner bronze tinted solar reflective glass.

ENTRANCE DOOR: 30" wide radius corner combination entrance door with screen and deadbolt lock, easy fold-away 24" triple rise entry steps, fold-away assist handle on entry door, porch light.

APPLIANCES

REFRIGERATOR: *Dometic* 8 cubic ft. double door, 2 way gas/110v.

RANGE: *Wedgewood* High Output 21" 3 burner, piezo ignitor.

FURNACE: *Atwood* 2 stage Excalibur furnace 34,000 BTU ducted in floor heat system.

MICROWAVE OVEN: *Dometic* 22" 1.2 cubic ft. with turntable and built in range hood, light and exhaust fan.

AIR CONDITIONER: *Dometic* Briskair 13,500 BTU thermal insulated ducted in ceiling cool air system.

ENTERTAINMENT

STEREO: *Sanyo* MCD-S500 AM/FM stereo CD with remote and clock.

TV ANTENNA: *Winegard* RV antenna with booster.

TV HOOKUP: Coax cable hookup in bedroom and living area.

TELEPHONE JACK: Standard equipment.

SATELLITE HOOKUP: Pre-wired for quick dish connection to the RV.

EXTERIOR SOUND CENTRE: 2 auxiliary speakers.

AWNING

A&E 19' AWNING: Aloe/White. Awning features patented rugged steel roller tube and heavy duty torsion spring. 8' extension.

PLUMBING & ELECTRICAL

Sealand Traveler Lite foot pedal flush china toilet with hand spray (mandatory option), *Lyons* tub and surround, folding shower door, double white sink in kitchen with single lever faucet and hand sprayer, bath vanity single lever chrome, water heater by-pass kit.

WATER HEATER: *Atwood* fast recovery 10 gallon gas/electric (*Direct Spark Ignition*).

HOLDING TANKS: Holding tanks are enclosed, insulated and heated. Garden style non-freeze drain tap on fresh water tank, sewage tank flush system.

HOLDING TANK CAPACITIES:

FRESH: 48 gallon *GREY:* 49 gallon *SEWAGE:* 49 gallon

ELECTRICAL CONVERTER: *Magnetek* 7345 solid state circuitry, whisper quiet operation.

HOOKUP: 30 AMP.

STANDARD FEATURES

Fiberglass front and back end caps, roof rack and ladder, oak edge counter tops, exterior rinse shower, venetian blinds, 2 x 30 lb. propane bottles with auto changeover regulator, systems monitor panel, color coordinated ABS lower sidewall skirting, smoke detector, huge under bed storage cavity, 60" x 80" queen bed, chair with ottoman, oak valance in kitchen, french doors in bedroom.

OPTIONAL EQUIPMENT

Twin beds, sofa bed, oak free standing dinette, wall-a-way recliner, day/night shades, thermopane windows, storm windows, polished aluminum rims, exterior security lights, dual front landing gear (mandatory option), porcelain toilet (mandatory option), electric fireplace, washer dryer ready, generator ready connection, skylight in bathroom, 6,000 lb. axle upgrade.

OPTIONAL FEATURE PACKAGE UPGRADES

ENTERTAINMENT PACKAGE: 27" TV and VCR.

INTERIOR PACKAGE: Fluorescent ceiling lights, day/night shades, oak galley area flooring.

COMFORT PACKAGE: 15,000 BTU air conditioner upgrade, fantastic powered roof vent in bedroom, central vacuum, paddle fan.

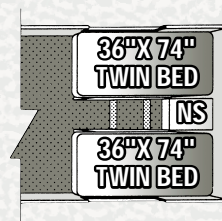

Optional Twin Bed Layout

29E34RL
 Fifth Wheel
 2003 Model Year
 by Glendale RV

36'-4"
Overall Length

29'-11"
Length - Bumper to Pin

10,507 lb.
G.V.W.R.

1,670 lb.
Dry Pin Weight

8,303 lb.
Dry Weight

12'-8"
Overall Height

96"
Main Body Width

Fifth Wheel
2003 Model Year
by Glendale RV

30E35DS

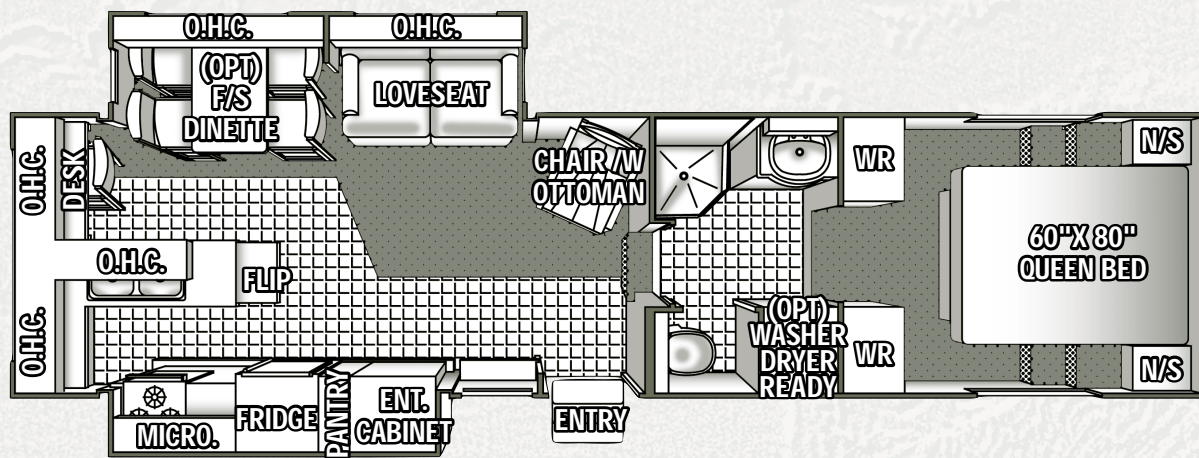

CONSTRUCTION

SIDEWALLS: Vacuum bonded ultra smooth *Lamilux* fiberglass siding. 1-1/2" lightweight aluminum perimeter sidewall framing and 1-1/2" rigid foam insulation.

ROOF: Seamless rubber roof membrane is bonded to 3/8" plywood decking. Full 5-1/2" tapered aluminum truss framing. Thick fiberglass batt insulation. Cathedral ceilings in the bedroom.

FLOOR: Composite laminated floor structure includes 3" foam insulation panel bonded between plywood panels and perimeter framing. *Darco* polythene moisture barrier between chassis underbelly. Seam guard under vinyl floor coverings.

CHASSIS: 11" combination Z channel/steel tube frame construction, twin 6,000 lb. 3" heavy duty axle assemblies, axle shocks at all wheels, *Goodyear* ST235/80R16 "D" radial tires, venting wheel rims, 12" x 2" electric brakes, underslung spare tire and rim, snap release pins on powered front landing gear, power landing gear includes a safety shut-off switch for your added protection, 2 stabilizer jacks, 72 degree adjustable pin box.

SLIDEOUT SPECIFICATIONS: Low maintenance powerful rack and gear 12V direct drive motor system, flush floor design (*sofa, dinette slide only*), gear box release lever included for system manual override.

INTERIOR CABINET DOORS: Raised panel oak cabinet doors. Easy-Glide metal roller system on all drawers.

WINDOWS: Radius corner bronze tinted solar reflective glass.

ENTRANCE DOOR: 30" wide radius corner combination entrance door with screen and deadbolt lock, easy fold-away 24" triple rise entry steps, fold-away assist handle on entry door, porch light.

APPLIANCES

REFRIGERATOR: *Dometic* 8 cubic ft. double door, 2 way gas/110v.

RANGE: *Wedgewood* High Output 21" 3 burner, piezo ignitor.

FURNACE: *Atwood* 2 stage Excalibur furnace 40,000 BTU ducted in floor heat system.

MICROWAVE OVEN: *Dometic* 22" 1.2 cubic ft. with turntable and built in range hood, light and exhaust fan.

AIR CONDITIONER: *Dometic* Briskair 13,500 BTU thermal insulated ducted in ceiling cool air system.

ENTERTAINMENT

STEREO: *Sanyo* MCD-S500 AM/FM stereo CD with remote and clock.

TV ANTENNA: *Winegard* RV antenna with booster.

TV HOOKUP: Coax cable hookup in bedroom and living area.

TELEPHONE JACK: Standard equipment.

SATELLITE HOOKUP: Pre-wired for quick dish connection to the RV.

EXTERIOR SOUND CENTRE: 2 auxiliary speakers.

AWNING

A&E 22" AWNING: Aloe/White. Awning features patented rugged steel roller tube and heavy duty torsion spring. 8' extension.

PLUMBING & ELECTRICAL

Sealand Traveler Lite foot pedal flush china toilet with hand spray (*mandatory option*), *Lyons* corner shower and surround, single lever white faucet in kitchen with sprayer, double white sink, bath vanity single lever chrome, water heater by-pass kit.

WATER HEATER: *Atwood* fast recovery 10 gallon gas/electric (*Direct Spark Ignition*).

HOLDING TANKS: Holding tanks are enclosed, insulated and heated. Garden style non-freeze drain tap on fresh water tank, sewage tank flush system.

HOLDING TANK CAPACITIES:

FRESH: 48 gallon *GREY:* 49 gallon *SEWAGE:* 49 gallon

ELECTRICAL CONVERTER: *Magnetek* 7445 solid state circuitry, whisper quiet operation.

HOOKUP: 50 AMP (detachable power cord).

STANDARD FEATURES

Fiberglass front and back end caps, roof rack and ladder, oak edge counter tops, exterior rinse shower, venetian blinds, 2 x 30 lb. propane bottles with auto changeover regulator, systems monitor panel, color coordinated ABS lower sidewall skirting, huge under bed storage cavity, 60" x 80" queen bed, chair with ottoman, french doors in bedroom, oak valance in kitchen, smoke detector, *new* overhead cabinets in slideout area 13" deep, 9" height, decorative clock over doorway.

OPTIONAL EQUIPMENT

Twin beds, oak free standing dinette in place of booth style dinette, day/night shades, thermopane windows, storm windows, polished aluminum rims, dual exterior security lights, electric fireplace, dual powered front landing gear (*mandatory option*), generator ready connection, porcelain toilet (*mandatory option*), loveseat (*mandatory option*), wall-a-way recliner, washer dryer ready, 7,000 lb. axle upgrade, skylight in bathroom, convection microwave.

OPTIONAL FEATURE PACKAGE UPGRADES

ENTERTAINMENT PACKAGE: 27" TV and VCR.

INTERIOR PACKAGE: Fluorescent ceiling lights, day/night shades, oak galley area flooring.

COMFORT PACKAGE: 15,000 BTU air conditioner upgrade, fantastic powered roof vent in bedroom, central vacuum, paddle fan.

New REAR KITCHEN - DESK AREA FLOORPLAN!

35'-10"
Overall Length

31'-0"
Length - Bumper to Pin

11,772 lb.
G.V.W.R.

1,577 lb.
Dry Pin Weight

9,341 lb.
Dry Weight

12'-8"
Overall Height

96"
Main Body Width

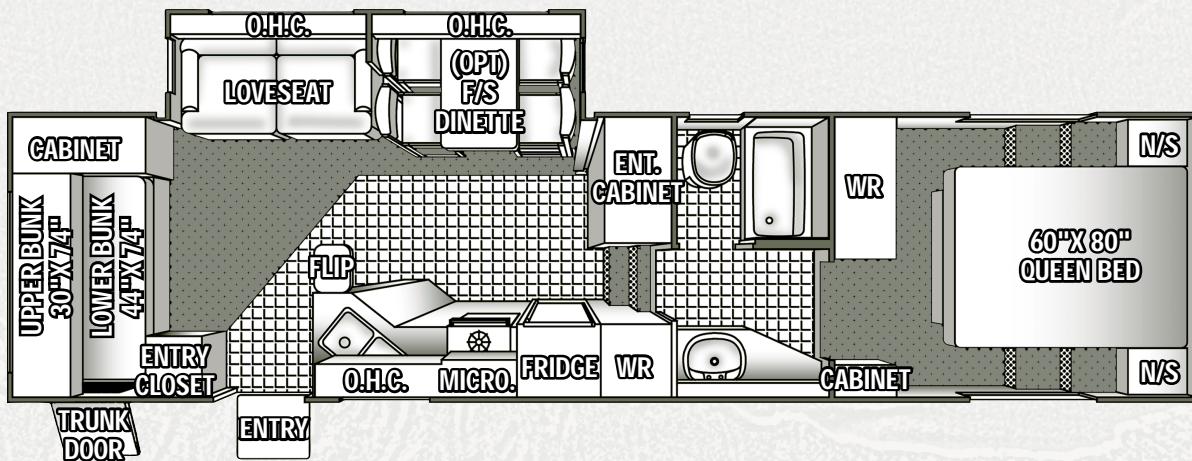

CONSTRUCTION

SIDEWALLS: Vacuum bonded ultra smooth *Lamilux* fiberglass siding. 1-1/2" lightweight aluminum perimeter sidewall framing and 1-1/2" rigid foam insulation.

ROOF: Seamless rubber roof membrane is bonded to 3/8" plywood decking. Full 5-1/2" tapered aluminum truss framing. Thick fiberglass batt insulation. Cathedral ceilings in the bedroom.

FLOOR: Composite laminated floor structure includes 3" foam insulation panel bonded between plywood panels and perimeter framing. *Darco* polythene moisture barrier between chassis underbelly. Seam guard under vinyl floor coverings.

CHASSIS: 11" combination Z channel/steel tube frame construction, twin 5,000 lb. 3" heavy duty axle assemblies, axle shocks at all wheels, *Goodyear* ST235/80R16 "D" radial tires, 6 bolt venting wheel rims, 12" x 2" electric brakes, underslung spare tire and rim, snap release pins on powered front landing gear, power landing gear includes a safety shut-off switch for your added protection, 2 stabilizer jacks, 72 degree adjustable pin box.

SLIDEOUT SPECIFICATIONS: Low maintenance powerful rack and gear 12V direct drive motor system, flush floor design, gear box release lever included for system manual override.

INTERIOR CABINET DOORS: Raised panel oak cabinet doors. Easy-Glide metal roller system on all drawers.

WINDOWS: Radius corner bronze tinted solar reflective glass.

ENTRANCE DOOR: 30" wide radius corner combination entrance door with screen and deadbolt lock, easy fold-away 24" triple rise entry steps, fold-away assist handle on entry door, porch light.

APPLIANCES

REFRIGERATOR: *Dometic* 8 cubic ft. double door, 2 way gas/110v.

RANGE: *Wedgewood* High Output 21" 3 burner, piezo ignitor.

FURNACE: *Atwood* 2 stage Excalibur furnace 40,000 BTU ducted in floor heat system.

MICROWAVE OVEN: *Dometic* 22" 1.2 cubic ft. with turntable and built in range hood, light and exhaust fan.

AIR CONDITIONER: *Dometic* Briskair 13,500 BTU thermal insulated ducted in ceiling cool air system.

ENTERTAINMENT

STEREO: *Sanyo* MCD-S500 AM/FM stereo CD with remote and clock.

TV ANTENNA: *Winegard* RV antenna with booster.

TV HOOKUP: Coax cable hookup in bedroom and living area.

TELEPHONE JACK: Standard equipment.

SATELLITE HOOKUP: Pre-wired for quick dish connection to the RV.

EXTERIOR SOUND CENTRE: 2 auxiliary speakers.

AWNING

A&E 19' AWNING: Aloe/White. Awning features patented rugged steel roller tube and heavy duty torsion spring. 8' extension.

PLUMBING & ELECTRICAL

Sealand Traveler Lite foot pedal flush china toilet with hand spray (mandatory option), *Lyons* tub and surround, folding shower door, single lever white faucet in kitchen with sprayer, double white sink, bath vanity single lever chrome, water heater by-pass kit.

WATER HEATER: *Atwood* fast recovery 10 gallon gas/electric (Direct Spark Ignition).

HOLDING TANKS: Holding tanks are enclosed, insulated and heated. Garden style non-freeze drain tap on fresh water tank, sewage tank flush system.

HOLDING TANK CAPACITIES:

FRESH: 48 gallon **GREY:** 49 gallon **SEWAGE:** 49 gallon

ELECTRICAL CONVERTER: *Magnetek* 7345 solid state circuitry, whisper quiet operation.

HOOKUP: 30 AMP.

STANDARD FEATURES

Fiberglass front and back end caps, roof rack and ladder, oak edge counter tops, exterior rinse shower, venetian blinds, 2 x 30 lb. propane bottles with auto changeover regulator, systems monitor panel, color coordinated ABS lower sidewall skirting, huge under bed storage cavity, 60" x 80" queen bed, oak valance in kitchen, smoke detector, *new* overhead cabinets in slideout area 13" deep, 9" height, french doors in bedroom, decorative clock over doorway.

OPTIONAL EQUIPMENT

Twin beds, oak free standing dinette in place of booth style dinette, day/night shades, thermopane windows, storm windows, polished aluminum rims, dual exterior security lights, dual powered front landing gear (mandatory option), porcelain toilet (mandatory option), generator ready connection, loveseat (mandatory option), skylight in bathroom, 6,000 lb. axle upgrade.

OPTIONAL FEATURE PACKAGE UPGRADES

ENTERTAINMENT PACKAGE: 27" TV and VCR.

INTERIOR PACKAGE: Fluorescent ceiling lights, day/night shades, oak galley area flooring.

COMFORT PACKAGE: 15,000 BTU air conditioner upgrade, fantastic powered roof vent in bedroom, central vacuum, paddle fan.



Convenient Travel Storage Area

30E35RB

Fifth Wheel
2003 Model Year
by Glendale RV

36'-4"
Overall Length

30'-8"
Length - Bumper to Pin

10,851 lb.
G.V.W.R.

1,635 lb.
Dry Pin Weight

8,589 lb.
Dry Weight

12'-8"
Overall Height

96"
Main Body Width

31E36MK

Fifth Wheel
2003 Model Year
by Glendale RV

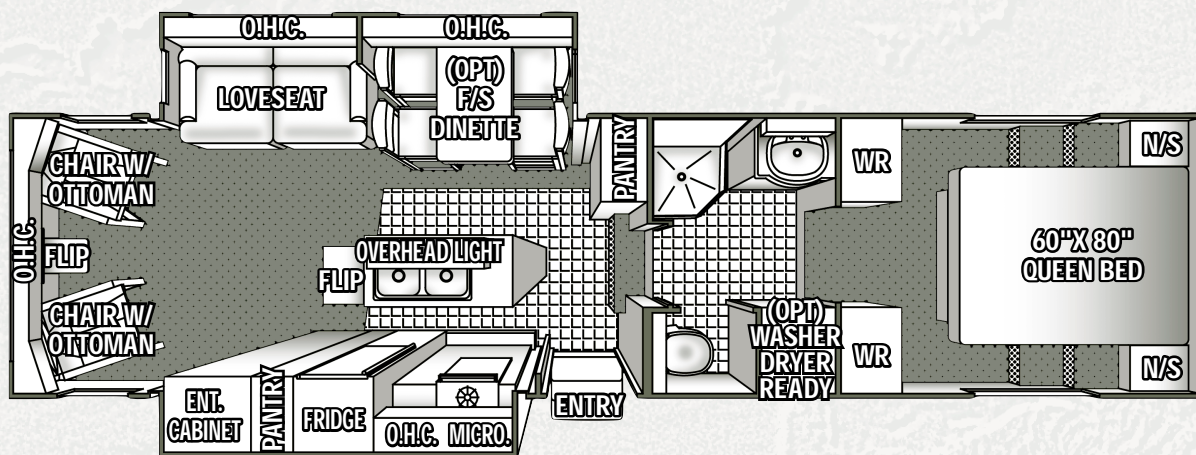

CONSTRUCTION

SIDEWALLS: Vacuum bonded ultra smooth *Lamilux* fiberglass siding. 1-1/2" lightweight aluminum perimeter sidewall framing and 1-1/2" rigid foam insulation.

ROOF: Seamless rubber roof membrane is bonded to 3/8" plywood decking. Full 5-1/2" tapered aluminum truss framing. Thick fiberglass batt insulation. Cathedral ceilings in the bedroom.

FLOOR: Composite laminated floor structure includes 3" foam insulation panel bonded between plywood panels and perimeter framing. *Darco* polythene moisture barrier between chassis underbelly. Seam guard under vinyl floor coverings.

CHASSIS: 11" combination Z channel/steel tube frame construction, twin 6,000 lb. 3" heavy duty axle assemblies, axle shocks at all wheels, *Goodyear* ST235/80R16 "D" radial tires, venting wheel rims, 12" x 2" electric brakes, underslung spare tire and rim, snap release pins on powered front landing gear, power landing gear includes a safety shut-off switch for your added protection, 2 stabilizer jacks, 72 degree adjustable pin box.

SLIDEOUT SPECIFICATIONS: Low maintenance powerful rack and gear 12V direct drive motor system, flush floor design (*sofa, dinette slide only*), gear box release lever included for system manual override.

INTERIOR CABINET DOORS: Raised panel oak cabinet doors. Easy-Glide metal roller system on all drawers.

WINDOWS: Radius corner bronze tinted solar reflective glass.

ENTRANCE DOOR: 30" wide radius corner combination entrance door with screen and deadbolt lock, easy fold-away 24" triple rise entry steps, fold-away assist handle on entry door, porch light.

APPLIANCES

REFRIGERATOR: *Domestic* 8 cubic ft. double door, 2 way gas/110v.

RANGE: *Wedgewood* High Output 21" 3 burner, piezo ignitor.

FURNACE: *Atwood* 2 stage Excalibur furnace 40,000 BTU ducted in floor heat system.

MICROWAVE OVEN: *Domestic* 22" 1.2 cubic ft. with turntable and built in range hood, light and exhaust fan.

AIR CONDITIONER: *Domestic* Briskair 13,500 BTU thermal insulated ducted in ceiling cool air system.

ENTERTAINMENT

STEREO: *Sanyo* MCD-S500 AM/FM stereo CD with remote and clock.

TV ANTENNA: *Winegard* RV antenna with booster.

TV HOOKUP: Coax cable hookup in bedroom and living area.

TELEPHONE JACK: Standard equipment.

SATELLITE HOOKUP: Pre-wired for quick dish connection to the RV.

EXTERIOR SOUND CENTRE: 2 auxiliary speakers.

AWNING

A&E 20' AWNING: Aloe/White. Awning features patented rugged steel roller tube and heavy duty torsion spring. 8' extension.

PLUMBING & ELECTRICAL

Sealand Traveler Lite foot pedal flush china toilet with hand spray (*mandatory option*), *Lyons* corner shower and surround, single lever white faucet in kitchen with sprayer, double white sinks, bath vanity single lever chrome, water heater by-pass kit.

WATER HEATER: *Atwood* fast recovery 10 gallon gas/electric (*Direct Spark Ignition*).

HOLDING TANKS: Holding tanks are enclosed, insulated and heated. Garden style non-freeze drain tap on fresh water tank, sewage tank flush system.

HOLDING TANK CAPACITIES:

FRESH: 48 gallon *GREY:* 49 gallon *SEWAGE:* 49 gallon

ELECTRICAL CONVERTER: *Magnetek* 7445 solid state circuitry, whisper quiet operation.

HOOKUP: 50 AMP (detachable power cord).

STANDARD FEATURES

Fiberglass front and back end caps, roof rack and ladder, oak edge counter tops, exterior rinse shower, venetian blinds, 2 x 30 lb. propane bottles with auto changeover regulator, systems monitor panel, color coordinated ABS lower sidewall skirting, huge under bed storage cavity, 60" x 80" queen bed, (2) chairs with ottoman, oak valance in kitchen, smoke detector, *new* overhead cabinets in slideout area 13" deep, 9" height, french doors in bedroom.

OPTIONAL EQUIPMENT

Twin beds, day/night shades, oak free standing dinette in place of booth style dinette, thermopane windows, storm windows, polished aluminum rims, dual exterior security lights, electric fireplace, generator ready connection, dual powered front landing gear (*mandatory option*), porcelain toilet (*mandatory option*), loveseat (*mandatory option*), wall-a-way recliners, washer dryer ready, 7,000 lb. axle upgrade, convection microwave, neo angle skylight in bathroom.

OPTIONAL FEATURE PACKAGE UPGRADES

ENTERTAINMENT PACKAGE: 27" TV and VCR.

INTERIOR PACKAGE: Fluorescent ceiling lights, day/night shades, oak galley area flooring.

COMFORT PACKAGE: 15,000 BTU air conditioner upgrade, fantastic powered roof vent in bedroom, central vacuum, paddle fan.

ELEGANT ISLAND DESIGN LAYOUT!

37'-4"
Overall Length

31'-2"
Length - Bumper to Pin

11,508 lb.
G.V.W.R.

1,405 lb.
Dry Pin Weight

9,121 lb.
Dry Weight

12'-9"
Overall Height

96"
Main Body Width

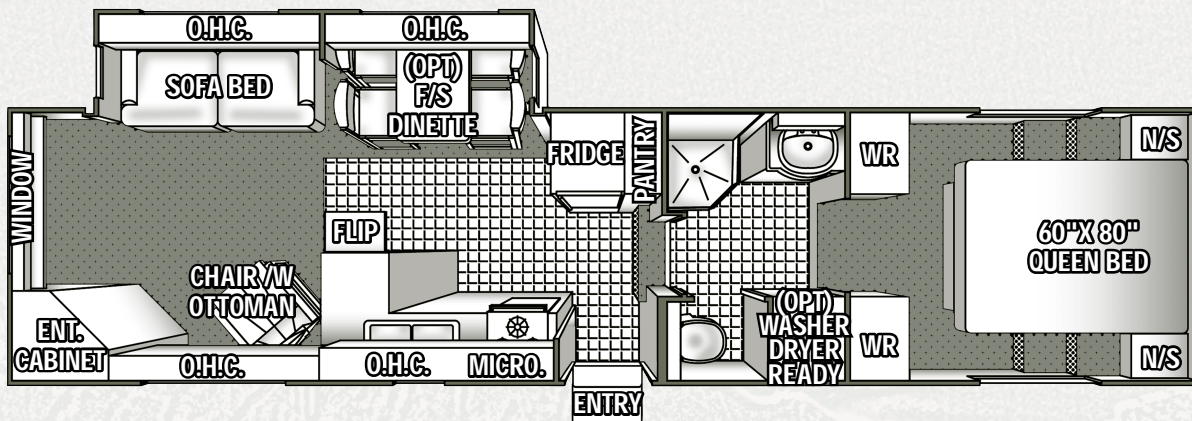

32E37

Fifth Wheel
2003 Model Year
by Glendale RV

CONSTRUCTION

SIDEWALLS: Vacuum bonded ultra smooth *Lamilux* fiberglass siding. 1-1/2" lightweight aluminum perimeter sidewall framing and 1-1/2" rigid foam insulation.

ROOF: Seamless rubber roof membrane is bonded to 3/8" plywood decking. Full 5-1/2" tapered aluminum truss framing. Thick fiberglass batt insulation. Cathedral ceilings in the bedroom.

FLOOR: Composite laminated floor structure includes 3" foam insulation panel bonded between plywood panels and perimeter framing. *Darco* polythylene moisture barrier between chassis underbelly. Seam guard under vinyl floor coverings.

CHASSIS: 11" combination Z channel/steel tube frame construction, twin 6,000 lb. 3" heavy duty axle assemblies, axle shocks at all wheels, *Goodyear* ST235/80R16 "D" radial tires, venting wheel rims, 12" x 2" electric brakes, underslung spare tire and rim, snap release pins on powered front landing gear, power landing gear includes a safety shut-off switch for your added protection, 2 stabilizer jacks, 72 degree adjustable pin box.

SLIDEOUT SPECIFICATIONS: Low maintenance powerful rack and gear 12V direct drive motor system, flush floor design, gear box release lever included for system manual override.

INTERIOR CABINET DOORS: Raised panel oak cabinet doors. Easy-Glide metal roller system on all drawers.

WINDOWS: Radius corner bronze tinted solar reflective glass.

ENTRANCE DOOR: 30" wide radius corner combination entrance door with screen and deadbolt lock, easy fold-away 24" triple rise entry steps, fold-away assist handle on entry door, porch light.

APPLIANCES

REFRIGERATOR: *Dometic* 8 cubic ft. double door, 2 way gas/110v.

RANGE: *Wedgewood* High Output 21" 3 burner, piezo ignitor.

FURNACE: *Atwood* 2 stage Excalibur furnace 40,000 BTU ducted in floor heat system.

MICROWAVE OVEN: *Dometic* 22" 1.2 cubic ft. with turntable and built in range hood, light and exhaust fan.

AIR CONDITIONER: *Dometic* Briskair 13,500 BTU thermal insulated ducted in ceiling cool air system.

ENTERTAINMENT

STEREO: *Sanyo* MCD-S500 AM/FM stereo CD with remote and clock.

TV ANTENNA: *Winegard* RV antenna with booster.

TV HOOKUP: Coax cable hookup in bedroom and living area.

TELEPHONE JACK: Standard equipment.

SATELLITE HOOKUP: Pre-wired for quick dish connection to the RV.

EXTERIOR SOUND CENTRE: 2 auxiliary speakers.

AWNING

A&E 21' AWNING: Aloe/White. Awning features patented rugged steel roller tube and heavy duty torsion spring. 8' extension.

PLUMBING & ELECTRICAL

Sealand Traveler Lite foot pedal flush china toilet with hand spray (mandatory option), *Lyons* corner shower and surround, single lever white faucet in kitchen with sprayer, double white sink, bath vanity single lever chrome, water heater by-pass kit.

WATER HEATER: *Atwood* fast recovery 10 gallon gas/electric (*Direct Spark Ignition*).

HOLDING TANKS: Holding tanks are enclosed, insulated and heated. Garden style non-freeze drain tap on fresh water tank, sewage tank flush system.

HOLDING TANK CAPACITIES:

FRESH: 48 gallon *GREY:* 49 gallon *SEWAGE:* 49 gallon

ELECTRICAL CONVERTER: *Magnetek* 7445 solid state circuitry, whisper quiet operation.

HOOKUP: 50 AMP (detachable power cord).

STANDARD FEATURES

Sofa bed, fiberglass front and back end caps, roof rack and ladder, oak edge counter tops, exterior rinse shower, venetian blinds, 2 x 30 lb. propane bottles with auto changeover regulator, systems monitor panel, color coordinated ABS lower sidewall skirting, huge under bed storage cavity, 60" x 80" queen bed, chair with ottoman, oak valance in kitchen, smoke detector, *new* overhead cabinets in slideout area 13" deep, 9" height, decorative clock over doorway, french doors in bedroom.

OPTIONAL EQUIPMENT

Twin beds, oak free standing dinette in place of booth style dinette, day/night shades, thermopane windows, storm windows, polished aluminum rims, dual exterior security lights, electric fireplace, dual front landing gear (mandatory option), porcelain toilet (mandatory option), generator ready connection, wall-a-way recliner, washer dryer ready, skylight in bathroom, 7,000 lb. axle upgrade, oak valance in kitchen, convection microwave.

OPTIONAL FEATURE PACKAGE UPGRADES

ENTERTAINMENT PACKAGE: 27" TV and VCR.

INTERIOR PACKAGE: Fluorescent ceiling lights, day/night shades, oak galley area flooring.

COMFORT PACKAGE: 15,000 BTU air conditioner upgrade, fantastic powered roof vent in bedroom, central vacuum, paddle fan.

37'-4"

Overall Length

31'-11"

Length - Bumper to Pin

11,243 lb.

G.V.W.R.

1,075 lb.

Dry Pin Weight

8,724 lb.

Dry Weight

12'-9"

Overall Height

96"

Main Body Width

Fifth Wheel 2003 Model Year by Glendale RV 32E37DS

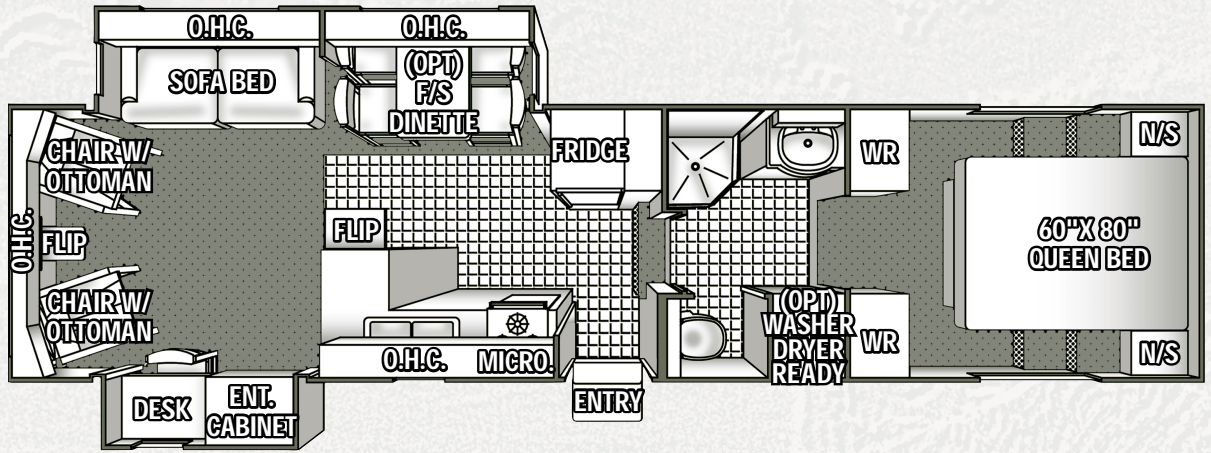

CONSTRUCTION

SIDEWALLS: Vacuum bonded ultra smooth *Lamilux* fiberglass siding. 1-1/2" lightweight aluminum perimeter sidewall framing and 1-1/2" rigid foam insulation.

ROOF: Seamless rubber roof membrane is bonded to 3/8" plywood decking. Full 5-1/2" tapered aluminum truss framing. Thick fiberglass batt insulation. Cathedral ceilings in the bedroom.

FLOOR: Composite laminated floor structure includes 3" foam insulation panel bonded between plywood panels and perimeter framing. *Darco* polythene moisture barrier between chassis underbelly. Seam guard under vinyl floor coverings.

CHASSIS: 11" combination Z channel/steel tube frame construction, twin 6,000 lb. 3" heavy duty axle assemblies, axle shocks at all wheels, *Goodyear* ST235/80R16 "D" radial tires, venting wheel rims, 12" x 2" electric brakes, underslung spare tire and rim, snap release pins on powered front landing gear, power landing gear includes a safety shut-off switch for your added protection, 2 stabilizer jacks, 72 degree adjustable pin box.

SLIDEOUT SPECIFICATIONS: Low maintenance powerful rack and gear 12V direct drive motor system, flush floor design, gear box release lever included for system manual override.

INTERIOR CABINET DOORS: Raised panel oak cabinet doors. Easy-Glide metal roller system on all drawers.

WINDOWS: Radius corner bronze tinted solar reflective glass.

ENTRANCE DOOR: 30" wide radius corner combination entrance door with screen and deadbolt lock, easy fold-away 24" triple rise entry steps, fold-away assist handle on entry door, porch light.

APPLIANCES

REFRIGERATOR: *Dometic* 8 cubic ft. double door, 2 way gas/110v.

RANGE: *WedgeWood* High Output 21" 3 burner, piezo ignitor.

FURNACE: *Atwood* 2 stage Excalibur furnace 40,000 BTU ducted in floor heat system.

MICROWAVE OVEN: *Dometic* 22" 1.2 cubic ft. with turntable and built in range hood, light and exhaust fan.

AIR CONDITIONER: *Dometic* Briskair 13,500 BTU thermal insulated ducted in ceiling cool air system.

ENTERTAINMENT

STEREO: *Sanyo* MCD-S500 AM/FM stereo CD with remote and clock.

TV ANTENNA: *Winegard* RV antenna with booster.

TV HOOKUP: Coax cable hookup in bedroom and living area.

TELEPHONE JACK: Standard equipment.

SATELLITE HOOKUP: Pre-wired for quick dish connection to the RV.

EXTERIOR SOUND CENTRE: 2 auxiliary speakers.

AWNING

A&E 15' AWNING: Aloe/White. Awning features patented rugged steel roller tube and heavy duty torsion spring with 8' extension.

PLUMBING & ELECTRICAL

Sealand Traveler Lite foot pedal flush china toilet with hand spray (mandatory option), *Lyons* corner shower and surround, single lever

white faucet in kitchen with sprayer, double white sink, bath vanity single lever chrome, water heater by-pass kit.

WATER HEATER: *Atwood* fast recovery 10 gallon gas/electric (*Direct Spark Ignition*).

HOLDING TANKS: Holding tanks are enclosed, insulated and heated. Garden style drain tap on fresh water tank.

HOLDING TANK CAPACITIES:

FRESH: 48 gallon **GREY:** 49 gallon **SEWAGE:** 49 gallon

ELECTRICAL CONVERTER: *Magnetek* 7445 solid state circuitry, whisper quiet operation.

HOOKUP: 50 AMP (detachable power cord).

STANDARD FEATURES

Fiberglass front and back end caps, sofa bed, roof rack and ladder, oak edge counter tops, exterior rinse shower, venetian blinds, 2 x 30 lb. propane bottles with auto changeover regulator, systems monitor panel, color coordinated ABS lower sidewall skirting, huge under bed storage cavity, 60" x 80" queen bed, chairs with ottoman, smoke detector, *new* overhead cabinets in slideout area 13" deep, 9" height, decorative clock over doorway, french doors in bedroom.

OPTIONAL EQUIPMENT

Twin beds, oak free standing dinette in place of booth style dinette, day/night shades, thermopane windows, storm windows, polished aluminum rims, dual exterior security lights, electric fireplace, dual powered front landing gear (mandatory option), porcelain toilet (mandatory option), wall-a-way recliners, 7,000 lb. axle upgrade, washer dryer ready, neo angle skylight in bathroom, convection microwave.

OPTIONAL FEATURE PACKAGE UPGRADES

ENTERTAINMENT PACKAGE: 27" TV and VCR.

INTERIOR PACKAGE: Fluorescent ceiling lights, day/night shades, oak galley area flooring.

COMFORT PACKAGE: 15,000 BTU air conditioner upgrade, fantastic powered roof vent in bedroom, central vacuum, paddle fan.

OPTIONAL FLOOR PLAN

REAR DESK/ENTERTAINMENT LAYOUT

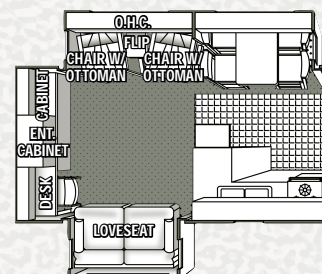

37'-4"
Overall Length

31'-11"
Length - Bumper to Pin

11,418 lb.
G.V.W.R.

1,562 lb.
Dry Pin Weight

9,061 lb.
Dry Weight

12'-9"
Overall Height

96"
Main Body Width

TRAVEL TRAILER

31RLS

Travel Trailer
2003 Model Year
by Glendale RV

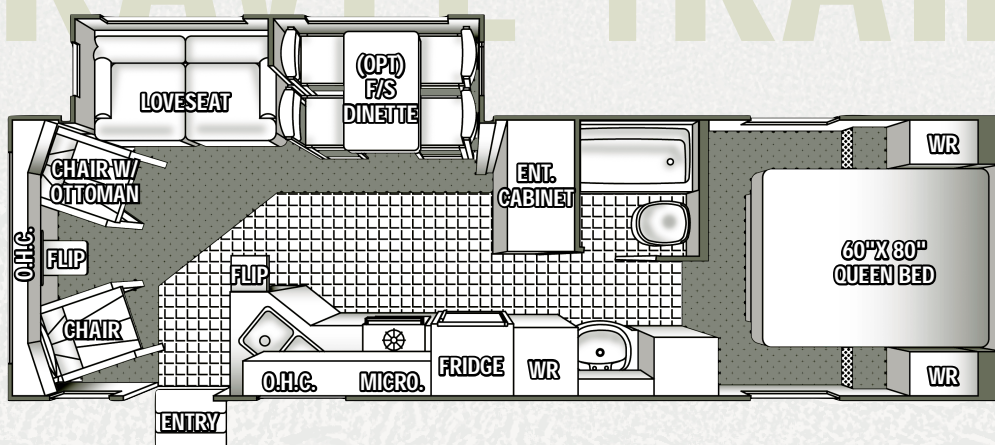

CONSTRUCTION

SIDEWALLS: Vacuum bonded ultra smooth *Lamilux* fiberglass siding. 1-1/2" lightweight aluminum perimeter sidewall framing and 1-1/2" rigid foam insulation.

ROOF: Seamless rubber roof membrane is bonded to 3/8" plywood decking. Full 5-1/2" tapered aluminum truss framing. Thick fiberglass batt insulation.

FLOOR: Composite laminated floor structure includes 3" foam insulation panel bonded between plywood panels and perimeter framing. *Darco* polythene moisture barrier between chassis underbelly. Seam guard under vinyl floor coverings.

CHASSIS: Combination steel tubular Z channel engineered chassis, twin 5,000 lb. 3" axle assemblies, chrome finished bullet style wheel caps, *Goodyear* ST225/75R15 "C" radial tires, 12" x 2" electric brakes, 4 stabilizer jacks.

SLIDEOUT SPECIFICATIONS: Low maintenance powerful rack and gear 12V direct drive motor system, flush floor design.

INTERIOR CABINET DOORS: Combination of raised panel oak cabinet doors. Easy-Glide metal roller system on all drawers.

WINDOWS: Radius corner bronze tinted solar reflective glass.

ENTRANCE DOOR: 30" wide radius corner combination entrance door with screen and deadbolt lock, easy fold-away double step, and fold-away assist handle on entry door.

APPLIANCES

REFRIGERATOR: *Dometic* 8 cubic ft. double door, 2 way gas/110v.

RANGE: *WedgeWOOD* High Output 21" 3 burner, piezo ignitor.

FURNACE: *Atwood* 2 stage Excalibur furnace 40,000 BTU ducted in floor heat system.

MICROWAVE OVEN: *Dometic* 22" 1.2 cubic ft. with turntable and built in range hood, light and exhaust fan.

AIR CONDITIONER: *Dometic* Briskair 13,500 BTU thermal insulated ducted in ceiling cool air system.

ENTERTAINMENT

STEREO: *Sanyo* MCD-S500 AM/FM stereo CD with remote and clock.

TV ANTENNA: *Winegard* RV antenna with booster.

TELEPHONE JACK: Standard equipment.

EXTERIOR SOUND CENTRE: 2 auxiliary speakers.

AWNING

A&E 21' AWNING: Aloe/White. Awning features patented rugged steel roller tube and heavy duty torsion spring. 8' extension.

PLUMBING & ELECTRICAL

Sealand Traveler Lite foot pedal flush china toilet with hand spray (*mandatory option*), folding shower door, single lever white faucet in kitchen with sprayer, double white sink, bath vanity single lever chrome, in-line water filter, water heater by-pass kit.

WATER HEATER: *Atwood* fast recovery 10 gallon gas/electric (*Direct Spark Ignition*).

HOLDING TANK CAPACITIES:

FRESH: 48 gallon **GREY:** 30 gallon **SEWAGE:** 30 gallon

ELECTRICAL CONVERTER: *Magnetek* 7345 solid state circuitry, whisper quiet operation.

HOOKUP: 30 AMP.

STANDARD FEATURES

Fiberglass front and back end caps, roof rack and ladder, oak edge counter tops, venetian blinds, 2 x 30 lb. propane bottles with auto changeover regulator, color coordinated ABS lower sidewall skirting, huge under bed storage cavity, 60" x 80" queen bed, spare tire and rim, telescopic lifts provide easy underbed storage access, 2 chairs with one ottoman.

OPTIONAL EQUIPMENT

Twin beds, loveseat (*mandatory option*), oak free standing dinette, pre-wire for satellite, day/night shades, axle shocks, storm windows, thermal windows, polished aluminum rims, heated enclosed and insulated holding tanks, central vacuum, porcelain toilet (*mandatory option*).

OPTIONAL FEATURE PACKAGE

INTERIOR PACKAGE - Fluorescent ceiling lights, day/night shades, Oak galley area flooring.



Handy, bus-style, trunk travel storage.

31'-3"

Overall Length

92 3/4"

Interior Width

9,480 lb.

G.V.W.R.

855 lb.

Dry Pin Weight

7,421 lb.

Dry Weight

10'-7"

Overall Height

96"

Main Body Width

© Titanium STREAMLINED AERODYNAMICS

SIGNIFICANT FUEL SAVING

This illustration demonstrates how air flow is swept away from the pin box area of the fifth wheel.

Titanium's patented front cap design provides a natural air foil that appears to mold itself over the cab area of the pick-up contributing to:

- SIGNIFICANT FUEL SAVING
- EXCEPTIONAL ROAD HANDLING
- REDUCED WIND DRAG

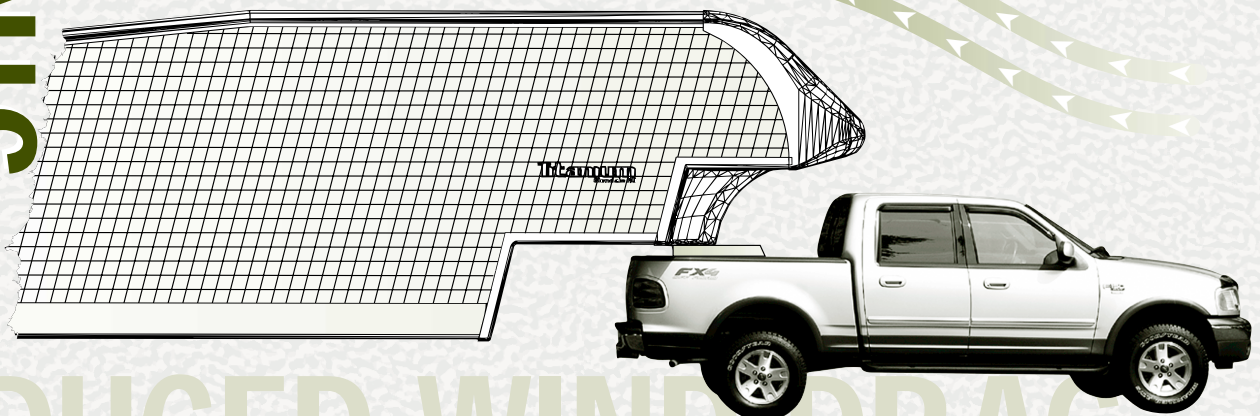

REDUCED WIND DRAG

The 2003 32E37DS

with the Blue Decor Scheme



All Titanium fifth wheels offer vaulted ceilings in the bedroom area giving an incredible 6'4" clearance floor to ceiling.



Residential style french doors (selected models).



Titanium's spacious interior layouts offer a cozy optional fireplace for those cool evenings. (selected models only)



Titanium models offer spacious bedroom layouts with exceptional his and hers wardrobe storage convenience.



Titanium[®]

www.glendalerv.com

You can travel with confidence knowing that Glendale provides specific structural warranty coverage for a period of 3 years. All of our warranty commitments are valid in both Canada and the United States. All appliances are name-brand highly regarded products. See dealer for complete warranty details.

YEAR **3** LIMITED
STRUCTURE
WARRANTY



GLENDAL RV



Contact your local dealer for product specifications and available floor plans. Be sure to test-tow this exciting fifth wheel today...

Your Local Titanium Dealer:

Glendale Recreational Vehicles - 145 Queen Street, Strathroy, Ontario N7G 3J6