

FOREST RIVER PRESENTS
ROCKWOOD

FREEDOM | PREMIER | HIGH WALL | HARD SIDE



ROCKWOOD
FREEDOM | PREMIER | HIGH WALL | HARD SIDE





Yes, your camping, but that does not mean your comfort stays home. Residential living standards that make life easy make camping easy.

Features like the three-speed Create-A-Breeze ventilation fan to pull in fresh outside ambient air, and swing level galley to keep kitchen utensils in their place are simple amenities that add tremendously to the comfort of your vacation. It's your vacation. Do it right.

Rockwood Freedom Series



A



D



G



B



E



H



C



F



I

- A** Metal drawer guides
- B** Outside grill with work table (Except LTDs)
- C** Spare tire (Std. with package B)
- D** Exterior electric plug (Except LTDs)
- E** Under floor 20 gallon water tank (Except LTDs)
- F** Heated Mattress (Std. Opt.)
- G** Water pump
- H** Swing down galley (Except LTDs)
- I** Plywood Bed Ends



The Rockwood Premier is the premier tent camper on the market today. It is loaded with features that make your camping experience more enjoyable. From the expansive sliding storage trunk for that extra cargo space,

to a comfortable, heated, inner-spring mattress, for a peaceful night's sleep and the convenient power lift system for easier setup are some of the basic features that really make your camper a Premier.

Rockwood Premier Series

A Hanging Shirt Bar
(Std. Premier & High Wall)

B Outside Shower

C Port-a-Potty (Std. on Selected Floorplans)

D Bunk Light and Fan
(Std. Premier & High Wall)

E One-Piece Door
(Except LTDs)

F Crank Down Stabilizer Jack with Sand Pad (STD.)

G Water Filter
(Std. with Hot Water Heater)

H Fantastic Fan
(Except LTDs.)



A



D



F



B



E



G



C



H







Wanting to camp but don't want to "rough it?" Welcome to the Rockwood High Wall Series. We have designed this series for the camping family who wants the refinement of larger vacationing units in a light-

weight camper. Ample counterspace, upgraded appliances and tasteful interiors make this camper a gorgeous option to experience.

Rockwood High Wall Series



A



B



C



D

- A** Sliding Storage Trunk (Some Models)
- B** Exterior Speaker (STD. Premier & High Wall)
- C** AM/FM Stereo with CD Player (STD. Premier & High Wall)
- D** Beautiful hardwall shower with a residential-style flush toilet complete with a 12-gallon black water holding tank. (Std. High Wall)

No more waiting in line for the showers. While breakfast is started, take a morning shower in privacy without leaving your camper. Our high wall models include a three burner range with cover and oven, microwave, stereo, a larger kitchen sink and shower which brings the finer amenities to tent camping.



ROCKWOOD

CONSTRUCTION

- 1) Three Stage Double Arm Lifter Posts (NA Hard Side)
- 2) Fiberglass Vacuum Bonded Radius Roof w/ No Center Seam (NA Hard Side)
- 3) Five-Piece Vinolon Supreme Tenting (NA Hard Side)
- 4) E-Z Crank Down Stabilizer Jacks w/Sand Pads
- 5) Full Perimeter Aluminum Bed Frames (NA Hard Side)
- 6) Plywood Bunk Ends (NA Hard Side)
- 7) Seven-Way Pigtail Wiring
- 8) Under Floor 20 Gallon Fresh Water Tank (LTDs 10 Gallon Above Floor)
- 9) Powder Coated Tubular Steel Frame
- 10) Powder Coated Rafter Poles and Bed Bows (NA Hard Side)
- 11) Air Conditioner Reinforcing Laminated Into Roof (NA Hard Side)
- 12) Steel Radial Tires
- 13) Easy Lube Axles (Except LTDs)
- 14) Smooth Fiberglass Vacuum Bonded Exterior (NA on Freedoms)
- 15) One-Piece Door (Except LTDs & Hard Side)

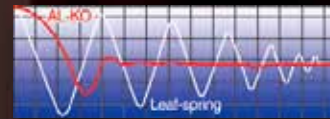

The UltraLube™ Hubs allow you to repack bearings quickly and easily without disassembly.

ALKO® AXLES AND EASY LUBE HUBS

AL-KO Axles offer many advantages over conventional axles:

- Fully Independent Wheel Suspension
- No Metal to Metal Contact and No Springs, Shackles, Hangers, or U-bolts to Break or Wear Out
- Lower Trailer Center of Gravity For Improved Stability

Note: Torsion Axles on Premiers and HWs only. Easy-Lube Hubs on all units except LTDs.

Rockwood High Wall Series

STANDARDS & OPTIONS

STANDARD FEATURES

- Cherry Interior with "Tile-Look" Linoleum
- Two-Tone Fabric Interiors
- Stainless Steel Look Appliances and Sink
- Double Pan Sink with High Rise Faucet
- Electric Water Pump
- Hot Water Package (Incl. Water Filter, Outside Shower, Six Gallon DSI Hot Water Heater)
- Hard Wall Shower with Residential Flush Toilet
- Three Burner Stove with Oven
- Microwave
- Free Standing Table – High Pressure Laminate
- Comfortable Family Style Dinette w/ 4" Reversible Cushions
- Residential Style Raised Panel Doors
- Wood Drawers w/ Metal Guides
- Large Clothes Bar
- AM/FM Stereo with CD player
- TV Outlet with Cable and Satellite Hook Up
- LCD TV (HW296 Only)
- 35 Amp Converter with Built in Battery Charger
- 12V Safety Switch
- Interior Floor Lights
- Bunk Light with Fan
- LP Leak Detector
- Lined Privacy Curtain
- Roof Valances
- Soft Quilted Top Innerspring Mattresses
- Torsion Axles by AL-KO w/ Easy-Lube Axles
- 14" Tires with Aluminum Wheels
- Electric Brakes
- Power Lift System
- Battery Box and Wiring Kit
- Dual 20 lb. Gas Bottles
- Diamond Plated Front Cap
- Outdoor Gas Grill w/ Worktable
- Outside Speaker
- Patio Light
- 110V Exterior Outlet
- Black Water Hose Storage
- One Piece Screen Door

- Folding Grab Handle
- Exterior Graphic Design

STANDARD CONSTRUCTION FEATURES

- Fiberglass Vacuum Bonded Radius Roof w/ No Center Seam
- Steel Air Conditioner Vent Reinforcing Laminated Into Roof
- 3-Stage Double Arm Lifter Posts
- Smooth Fiberglass Vacuum Bonded Exterior
- Lower Door Operational in Closed Position
- Five Piece Sectionalized Vinolon Supreme Tenting
- Tent Permanently Attached on Bunk Ends and Slide Out
- Plywood Bunk Ends
- Full Perimeter Aluminum Bed Frames
- Powder Coated Rafter Poles and Bed Bows
- Tinted Vinyl Windows
- One Piece Undercoated Structure wood Floor
- Automotive E-Coated Tubular Steel Frame
- (4) E-Z Crank-Down Stabilizer Jacks w/ Sand Pads
- Seamless, High Density Polyethylene Wheel Wells
- Under Floor 20 Gallon Fresh Water Tank
- 12 Gallon Gray Water Holding Tank
- 12 Gallon Black Water Holding Tank
- 2000 lb. Tongue Jack w/ Swivel Wheel
- 7-Way Pigtail Plug

OPTIONS

- Create-a-Breeze 3 Speed Fantastic Fan
- Carbon Monoxide Detector
- Air Conditioner Wiring Kit
- 13,500 BTU Air Conditioner
- 20,000 BTU Forced Air Furnace w/ Electric Ignition
- Extra Large 4.0 cu. ft. Refrigerator
- Heated Innerspring Mattresses
- Hanging Wardrobe
- Hanging Pantry
- Power Front Jack
- Screen Room w/ Privacy Panels
- Option Package 1 (Incl. Spare Tire, Tire Bracket, Tire Cover, Installed Step, Awning)

HW256

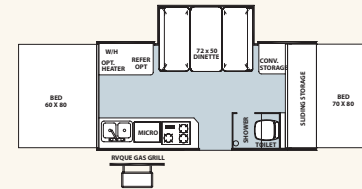

HW276

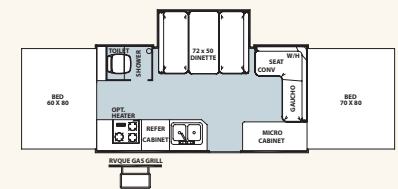

HW277

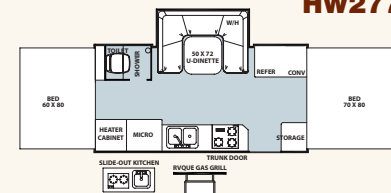

HW296

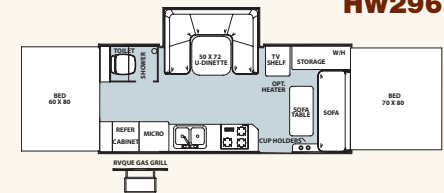

HW316TH

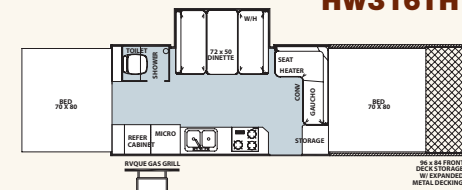

Rockwood High Wall Series SPECIFICATIONS

Model number of any particular unit does not necessarily reflect the overall length of the unit itself. Dry weight are estimates.

MODEL	HW256	HW277	HW276	HW296	HW316TH
GVWR (Gross Vehicle Weight Rating)	3873	3779	3859	4573	6250
BASE/DRY UNIT WEIGHT	2910	2806	2959	3135	3676
BASE DRY HITCH WEIGHT	373	279	359	373	404
BASE DRY AXLE WEIGHT	2537	2527	2600	2762	3272
CARGO CAPACITY	963	935	862	1217	2317
BOX SIZE	12'	14'	14'	16'	14'
TRAILER SIZE (Closed w/ Hitch)	19' 1"	19' 4"	19' 4"	21' 4"	28' 4"
HEIGHT (Closed)	68"	68"	68"	68"	68"
TRAILER LENGTH (Open)	22' 6"	24' 9"	24' 9"	26' 9"	33' 9"
FRESH WATER CAPACITY	26	26	26	26	26
GRAY WATER CAPACITY	12	12	12	12	12
BLACK WATER CAPACITY	12	12	12	12	12



Rockwood Hard Side Series

A122

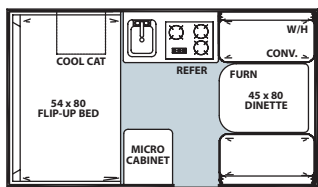

A126

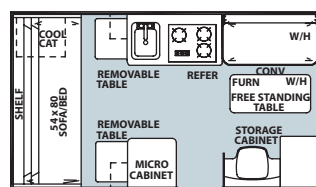

A128

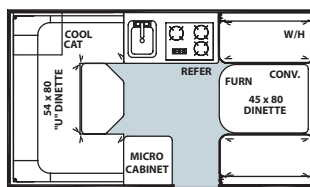

Rockwood Hard Side A122

Rockwood Hard Side Series SPECIFICATIONS

Model number of any particular unit does not necessarily reflect the overall length of the unit itself. Dry weight are estimates.

MODEL	A122	A126	A128
GVWR (Gross Vehicle Weight Rating)	3179	3205	3082
BASE/DRY UNIT WEIGHT	1784	1803	1846
BASE DRY HITCH WEIGHT	257	259	273
BASE DRY AXLE WEIGHT	1527	1544	1573
CARGO CAPACITY	1217	1217	1217
BOX SIZE	12'	12'	12'
TRAILER SIZE (Closed w/ Hitch)	17' 1"	17' 1"	17' 1"
HEIGHT (Closed)	60"	60"	60"
FRESH WATER CAPACITY	26	26	26

* Hard Side standards and options available on page 12.

Rockwood Premier / Hard Side Series

STANDARDS & OPTIONS

Premier / Hard Side Standard Features

- Cherry Interior with "Tile-Look" Linoleum
- Two-Tone Fabric Interiors
- Residential Style Kitchen Faucet w/ Electric Water Pump
- Larger Deeper Sinks
- Hot Water Pkg. (Incl. Water Filter, Outside Shower, Six Gallon DSI Hot Water Heater, Demand Water Pump)
- Permanently Mounted 3-Burner Indoor Range w/ Stove Cover
- Free Standing Table – High Pressure Laminate
- Comfortable Family Style Dinette w/ 4" Reversible Cushions (N/A A126)
- Residential Style Raised Panel Doors
- Wood Drawers w/ Metal Guides
- Large Clothes Bar
- AM/FM Stereo w/ CD Player
- Cable Ready
- 35 Amp Converter with Built In Battery Charger
- 12V Safety Switch
- LP Leak Detector
- Port-a-Potty (1904, 2514G, A122, A128)

- Soft Quilted Top Innerspring Mattresses (N/A A126, A128)
- Independent Torsion Axles
- Easy Lube Axles
- 13" Radial Tires with Aluminum Wheels
- Electric Brakes
- Battery Box and Wiring Kit
- Outdoor Gas Grill w/ Worktable
- Outside Speaker
- 110V Exterior Outlet
- Folding Grab Handle
- Exterior Graphic Design

Premier Additional Standards

- 3 Double Ceiling Lights w/ Jacks for Accessories
- Bunk Light w/ Fan
- Swing Level Galley
- Large Built-in Ice Box
- Lined Privacy Curtains
- Roof Valances
- One Piece Screen Door
- Patio Light
- Electric Lifter system

- 20 lb. LP Bottle
- 28.5" Front Storage Deck (1907BH Only)
- Sliding Storage Tray on All Front Trunk Models (Except 1904)

Hard Side Additional Standards

- Create-A Breeze Three Speed Fantastic Fan
- Large, Opening Picture Window
- Privacy Curtains
- 10,000 BTU Cool Cat Heat Pump
- 3 Way Refer 2.5 Cu. Ft. 110V & 12V
- Stainless Steel Appliances
- Microwave
- Cassette Toilet (A126)
- 2 Double Ceiling Lights
- Interior Floor Light
- Thermostatically Controlled Heated Mattresses (STD with A122)
- Courtesy Light on Front
- Double 20lb LP Bottles w/ Cover

Standard Construction Features

- Smooth Fiberglass Vacuum Bonded Exterior
- One Piece Undercoated Structurewood Floor
- Automotive E-Coated Tubular Steel Frame
- (4) E-Z Crank-Down Stabilizer Jacks w/ Sand Pads

- Seamless, High Density Polyethylene Wheel Wells
- Under Floor 20 Gallon Fresh Water Tank
- 2000 lb. Tongue Jack w/ Swivel Wheel
- 7-Way Pigtail Plug

Premier Additional Standard Construction Features

- Five Piece Sectionalized Vinolon Supreme Tenting
- Tent Permanently Attached on Bunk Ends and Slide Out
- Plywood Bunk Ends
- Full Perimeter Aluminum Bed Frames
- Powder Coated Rafter Poles and Bed Bows
- Tinted Vinyl Windows
- Fiberglass Vacuum Bonded Radius Roof w/ No Center Seam
- Steel Air Conditioner Vent Reinforcing Laminated Into Roof
- 3-Stage Double Arm Lifter Posts
- Lower Door Operational in Closed Position

Hard Side Additional Standard Construction Features

- Completely Enclosed Living Area
- Fiberglass Vacuum Bonded Roof with Metal

- Interior Roof
- Large Tinted Sky Light with Shade
- Aerodynamic Diamond Plate Front
- Automatic LP Regulator
- Installed Door Step
- Spare Tire and Mount

Options

- Carbon Monoxide Detector
- Create-A Breeze Three Speed Fantastic Fan
- 20,000 BTU Forced Air Furnace w/ Electric Ignition

Premier Additional Options

- Thermostatically Controlled Heated Mattresses
- Extra-Large 2.5 Cubic Ft. Refrigerator
- Add-A-Room w/ Privacy Panels
- Overhead Kitchen Pantry
- Hanging Wardrobe
- Air Conditioning Wiring Kit
- Dual 20 lb. LP Bottles w/Cover
- Option Pkg. 1 (Incl. Awning Spare Tire, Tire Bracket, Tire Cover, Installed Step)

Hard Side Additional Options

- Power Front Jack

Rockwood Premier Series SPECIFICATIONS

Model number of any particular unit does not necessarily reflect the overall length of the unit itself. Dry weight are estimates.

MODEL	1904	1907BH	2317G	2514G	2516G
GVWR (Gross Vehicle Weight Rating)	3136	3235	3318	3263	3252
BASE/DRY UNIT WEIGHT	1917	1917	2445	2446	2473
BASE DRY HITCH WEIGHT	247	275	358	303	292
BASE DRY AXLE WEIGHT	1670	1642	2087	2143	2181
CARGO CAPACITY	1017	1299	854	798	760
BOX SIZE	10'	10'	12'	12'	12'
TRAILER SIZE (Closed w/ Hitch)	16' 5"	16' 7"	19' 1"	19' 1"	19' 1"
HEIGHT (Closed)	57"	57"	61"	61"	61"
TRAILER LENGTH (Open)	20' 2"	20' 2"	23' 6"	23' 6"	23' 6"
FRESH WATER CAPACITY	26	26	26	26	26

Rockwood Popular Options

- A** Add-a-Room with Privacy Panels
- B** Hanging Wardrobe
- C** Hanging Pantry
- D** Power Lift (Std. Premier, High Wall Opt. LTD. and Freedom)



A

Rockwood Premier Series

1904

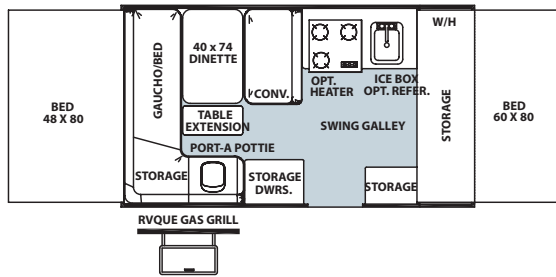

1907BH

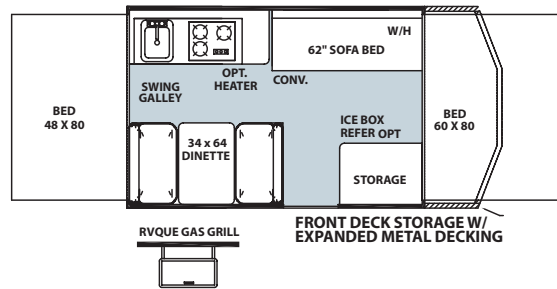

2317G

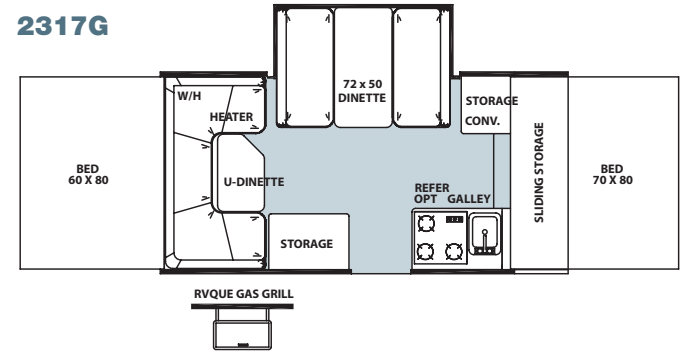

2514G

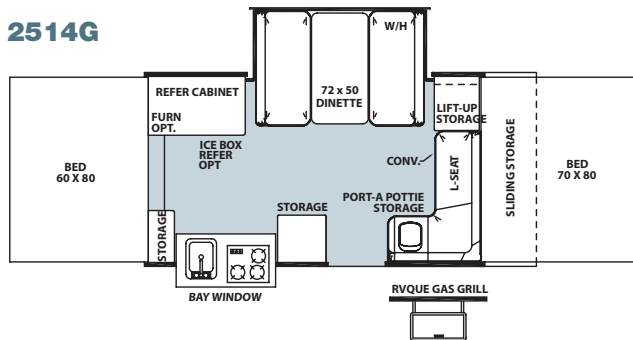

2516G

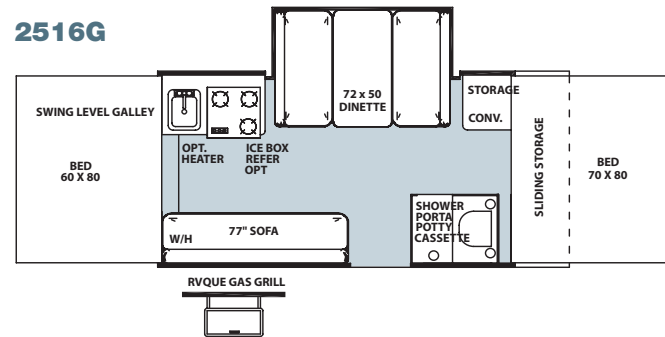

Rockwood Freedom / LTD Series

STANDARDS & OPTIONS

Freedom / LTD Standard Features

- Oak Interior with "Tile-Look" Linoleum
- Two-Tone Fabric Interiors
- Residential Kitchen Faucet w/ Electric Water Pump
- Water Filtration System w/ All Shower Models (Freedom Only)
- Port-a-Potty (1910 Only)
- Shower Cassette Package (1950, 2560G, 232XR, 242XR, 282TXR)
- Swing Level Galley with Storage (Freedom Only)
- Metal Drawer Guides
- Permanently Mounted 3 Burner Indoor Range (Freedom Only)
- Large Built-In Icebox
- Free Standing Table – High Pressure Laminate
- Comfortable Family Style Dinette w/ Cushions
- LP Leak Detector
- 35 Amp Converter w/ Built in Battery Charger (Freedom Only)
- Automatic 12 Volt Safety Switch
- Soft Quilted-Top Bed Mattresses
- Leaf-Spring Axle
- Easy Lube Axles (Freedom Only)
- 13" Radial Tires (Freedom only)

- 15" Mud Rover Tires, Al. Wheels & Shocks (232XR, 242XR, 282TXR Only)
- Electric Brakes (Freedom Only)
- Power Lift System (232XR, 242XR, 282TXR Only)
- Battery Box (Freedom Only)
- 20 lb LP Bottle
- (2) 20 lb LP Bottles (232XR, 242XR, 282XR Only)
- 28.5" Front Storage Deck (1920BH, 2280BH Only)
- 48" Front Storage Deck (232XR Only)
- 96" Front Storage Deck (242XR, 282TXR Only)
- Diamond Plated Front, Rear and Side Skirt (232XR, 242XR, 282TXR Only)
- Outside Gas Grill (Freedom Only)
- Exterior Work Table (Freedom Only)
- Folding Grab Handle (Freedom Only)
- One Piece Screen Door (Freedom Only)
- Installed Double Step (232XR, 242XR, 282TXR Only)
- Exterior Graphic Design

LTD Additional Standard Features

- Fold Over Galley with Upper and Lower Storage
- Two Burner Free-Standing Range
- 25 Amp Converter w/ Built in Battery Charger
- Roof Vent

- Privacy Curtains
- 10 Gallon Fresh Water Tank
- 12" Radial Tires
- Rear Crank Down Stabilizer Jacks w/ Sand Pads
- Exterior Outlet (1940 LTD only)
- Patio Light (1940 LTD only)
- Awning
- Installed Door Step
- Spare Tire

Standard Construction Features

- Fiberglass Vacuum Bonded Radius Roof w/ No Center Seam
- Three-Stage Double Arm Lifter Posts
- Main Door Operational in Closed Position
- Five-Piece Vinolon Supreme Tenting
- Tent Permanently Attached on Bunk Ends and Slide Out
- Plywood Bunk Ends
- Full Perimeter Aluminum Bed Frames
- Powder Coated Rafter Poles and Bed Bows
- Tinted Vinyl Windows
- One-Piece Undercoated Structurewood Floor
- Automotive E-Coated Tubular Steel Frame
- Seamless, High Density Polyethylene Wheel Wells

- (4) E-Z Crank Down Stabilizer Jacks w/ Sand Pads (Freedom Only)
- 2,000 lb. Tongue Jack w/ Swivel Wheel
- Seven-Way Pigtail Wiring

Freedom Popular Options

- Create-A-Breeze Three Speed Fantastic Fan
- 20,000 BTU Forced Air Furnace w/ Electric Ignition
- Air Conditioner Wiring Kit
- Shower/Cassette Option: Incl. Water Filtration System, Six Gallon DSI Hot Water Heater, Demand Water Pump, and Cassette Toilet (Model 2280, 2280BH, 2318G)
- Hot Water Package w/ Outside Shower (1910, 1920BH, 1970, 1980, 2270, 2280, 2280BH, 2318G)
- Carbon Monoxide Detector
- Large 1.9 Cubic Ft. 3 Way Refrigerator
- Overhead Kitchen Pantry
- Thermostatically Controlled Heated Bed Mattresses
- Power Lift System (Std. 232XR, 242XR, 282TXR)
- Dual 20 Lb. LP Bottles with Cover
- Add-A-Room w/ Privacy Panels
- Option Pkg. A (Incl. Privacy Curtains, Roof Valances, 4" Foam Cushions w/ Cover, Under Floor 20 Gallon Fresh Water Tank, A/C Bracing, Patio Light, 110V Exterior Outlet)
- Option Pkg. B (Incl. Spare Tire, Tire Bracket, Tire Cover, Installed Step, Awning)

Rockwood Freedom / LTD Series SPECIFICATIONS

Model number of any particular unit does not necessarily reflect the overall length of the unit itself. Dry weight are estimates.

MODEL	1910	1920BH	1950	1970	1980	2270	2280	2280BH	2318G	2560G	232XR	242XR	282TXR	1640LTD	1940LTD
GVWR (Gross Vehicle Weight Rating)	2990	3022	2785	2669	2607	3024	3077	3109	3059	2988	3770	3876	5576	2151	2274
BASE/DRY UNIT WEIGHT	1772	1809	1854	1638	1589	1892	1986	2037	2158	2278	2545	2388	2991	1347	1493
BASE DRY HITCH WEIGHT	241	272	223	240	230	274	327	359	309	238	270	376	190	175	174
BASE DRY AXLE WEIGHT	1531	1537	1431	1398	1359	1618	1659	1678	1849	2040	2275	2012	2801	1172	1319
CARGO CAPACITY	1066	1066	917	866	866	966	966	1053	882	691	1206	1469	2317	683	762
BOX SIZE	10'	10'	10'	10'	10'	12'	12'	12'	12'	14'	12'	10'	12'	8'	10'
TRAILER SIZE (Closed w/ Hitch)	16' 5"	16' 7"	14'	14'	14'	15' 9"	15' 9"	18' 6"	15' 9"	17' 9"	21' 5"	23' 6"	25' 7"	12'	14'
HEIGHT (Closed)	57"	57"	57"	57"	57"	57"	57"	57"	57"	57"	62.5"	62.5"	62.5"	57"	57"
TRAILER LENGTH (Open)	20' 2"	20' 2"	20' 2"	20' 2"	20' 2"	22' 6"	22' 6"	22' 6"	22' 6"	24' 9"	27'	27'	30' 3"	17'	20' 2"
FRESH WATER CAPACITY	20	20	20	20	20	20	20	20	20	26	26	26	26	11	11

LTD Popular Options

- Thermostatically Controlled Heated Bed Mattresses
- Large 1.9 Cubic Ft. Refrigerator
- 20,000 BTU Forced Air Furnace w/ Electronic Ignition
- Electric Brakes
- Outside Gas Grill
- Battery Box
- Power Lift
- Carbon Monoxide Detector
- Add-A-Room w/ Privacy Panels

Rockwood Freedom / LTD Series

1910

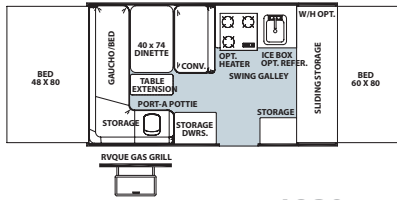

1920BH

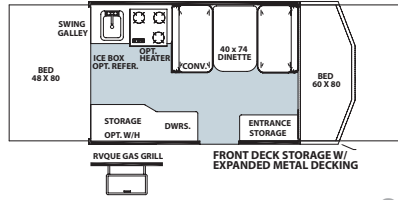

1950

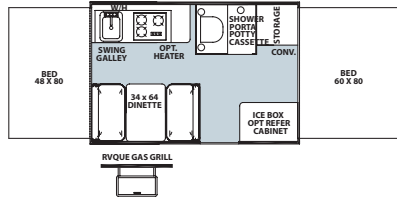

1970

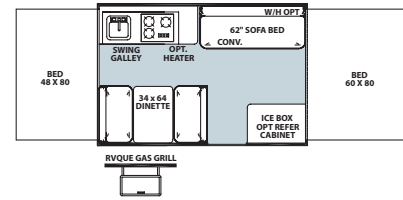

1980

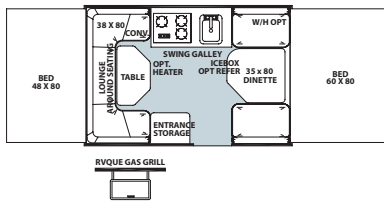

2270

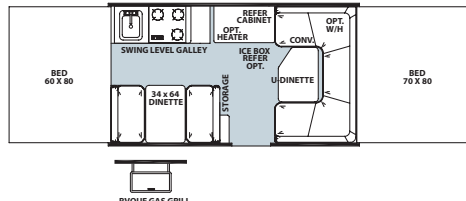

2280

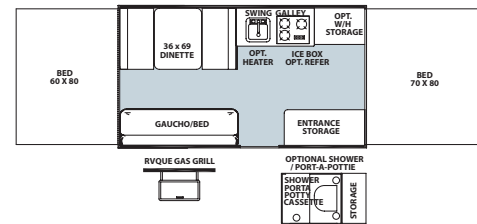

2280BH

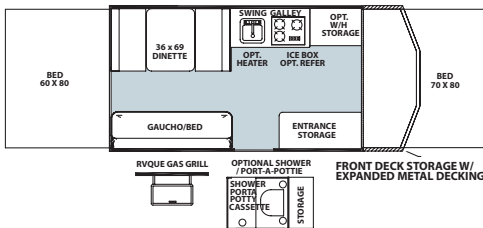

2318G

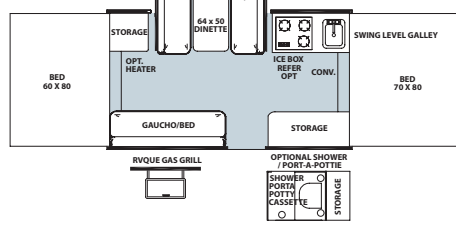

2560G

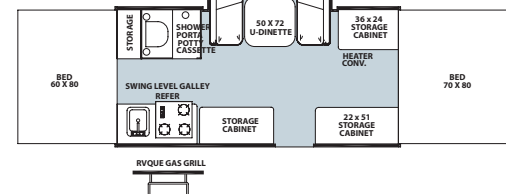

232XR

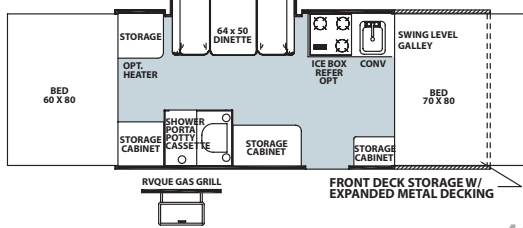

242XR

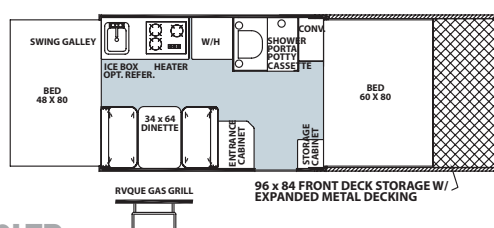

282TXR

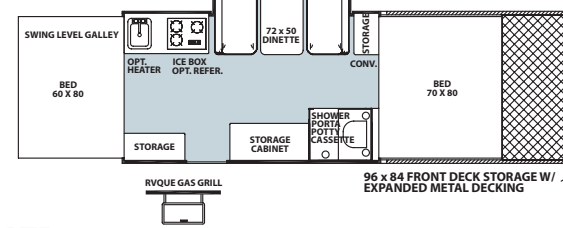

1640LTD

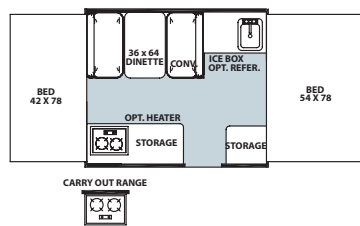

1940LTD

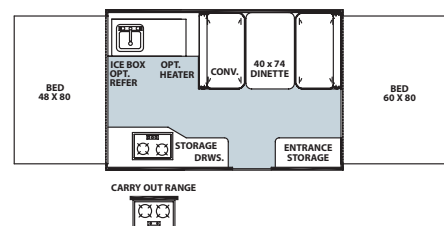



PEACE OF MIND.

Forest River has yet another exclusive feature to offer: One year of free roadside assistance will be given to every 2011 Rockwood customer. This is just one more way to say "Thank you" and to ensure an enjoyable traveling experience.

ROCKWOOD WARRANTY INFORMATION

For details on Rockwood's complete warranty program, see your Rockwood dealer. When it comes to backing products with the same quality and commitment it does when it begins the manufacturing process, the only name you have to remember when you're looking for a recreational vehicle is Rockwood. Rockwood offers the following additional limited warranties to the original purchasers. Consult written warranty for details.

1. Five-year roof warranty,
2. Twenty-five-year floor warranty,
3. Five-year frame warranty,
4. Five-year tent warranty,
5. Five-year warranty on torsion axle suspension,
6. Limited life-time warranty of lifter system,
7. One-year bumper to bumper. Ask your dealer about the available lifetime structural warranty.

FOREST RIVER'S HALLMARK OF EXCELLENCE PRE-DELIVERY INSPECTION FACILITIES



THAT'S 20,000 SQUARE FEET OF QUALITY ASSURANCE. THE BARE ESSENTIALS FOR A PREMIUM PRODUCT.

Brought online in 2005, Forest River is proud of its state-of-the-art test facility. This beautiful building blends many of the old tried and true methods of testing our diverse types of RVs with new innovative ways of solving quality issues. Being centrally located to most Forest River manufactur-

ing facilities, this 20,000 square foot PDI (Pre-delivery Inspection) test building gives immediate daily feedback to individual managers. This assures the production facilities that nothing has slipped by the plant's quality assurance personnel and the units are "green" and ready to ship.

FOREST RIVER ENCOURAGES YOU TO **BUY LOCALLY** FROM YOUR HOMETOWN DEALERSHIP.

Forest River, Inc. strongly encourages our retail customers to purchase from their local dealership whenever possible due to the following factors:

- 1) Our Dealers are as a rule, independently owned and operated businesses. Outside of those customers they personally sold products to, they are not contractually obligated to perform warranty service on Forest River products that were purchased elsewhere. There may be an occasion that you would be required to return to the point of purchase to satisfy warranty requirements.
- 2) Although many dealerships will eventually service products not purchased at their place of business, they will usually take care of their customers and other Forest River customers who are traveling away from their local dealer as they would their own.

3) Local purchases allow a customer to establish a relationship with a dealer close to home. This relationship provides the customer with a convenient location for service and support from a "home town" professional.

4) The opportunity for a thorough PDI (Pre Delivery Inspection) and product orientation is an additional benefit of buying from your local dealer. Further providing the opportunity for refresher courses or the ability to get questions answered much more conveniently.

5) For our Canadian customers, there are also requirements which must be met to bring an RV purchased out of the country to their home. Although not insurmountable, these requirements may involve such things as additional inspections and certifications, taxes and fees. Your local Canadian Dealer is a professional at meeting these requirements.

6) Forest River's goal is for all RV Owners to fully enjoy their RV experience. In light of this goal, and considering the advantages of buying local, we encourage you to be thorough when determining what product to purchase and which dealer to purchase it from as both are key to your ultimate satisfaction and the realization of your dreams.



Forest River, Inc. 55470 C.R. 1 Elkhart, IN 46515

www.forestriverinc.com www.forestriveraccessories.com 574.389.4600

Scan this barcode using a QR Reader on your smart phone to learn more about Forest River.



Your Rockwood Dealer