

WWW.KEYSTONERV.COM/PASSPORT

Passport

ULTRA-LITE



EXPRESS

GRAND TOURING

ELITE

GO ANYWHERE

★ ★ ★ ★ ★ ★

EXPRESS SUPER LITE



What looks small, but packs a big punch when it comes to living space; the Passport Express Super Lite! Whether it's the feel of sleeping in the open air with our expandable models or the need for a trailer that can be towed by most small SUV's, the Passport Express Super Lite is the Passport way of making camping easy.



199ML SHOWN IN DRIFTWOOD DECOR

Passport
ULTRA LITE

EXPRESS SUPER LITE



195RB SHOWN IN RATTAN DECOR



239ML SHOWN IN GRANITE DECOR



LIGHTED PASS-THRU STORAGE (N/A ON EXPANDABLES)



EXTERIOR SHOWER ON ALL MODELS



HEAVY DUTY DRAWER ROLLER GUIDES

MURPHY BED

STANDARD IN 195RB, 199ML & 239ML

The Passport murphy bed is an innovative way to have both a bed and sofa in a space saving design.

Now available in Passport Express 195RB, 199ML and 239ML.



STEP 1

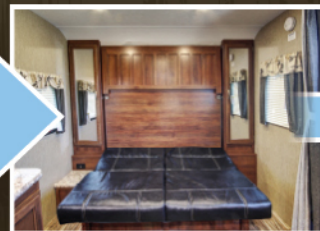

STEP 2



STEP 3



DEEP SINK WITH HIGH-RISE FAUCET AND SINK COVERS



ADJUSTABLE LED ELECTRIC AWNING



EASY OPEN LP TANK COVER W/DUAL TANKS



DUAL USB CHARGING PORTS

ALL NEW EXPANDABLES NOW AVAILABLE!



Passport expandables compact design comes with travel-friendly lengths and lightweight floorplans that make this travel trailer towable by many smaller vehicles*.

*CHECK WITH YOUR VEHICLE MANUFACTURER FOR TOWING SPECIFICATIONS

The Passport Express Expandable Series has been specifically engineered to maximize sleeping capacity while keeping both weight and overall length of the trailer in mind. Without sacrificing the look, comfort and amenities found in the regular Passport Express, the expandables also offer the latest in hybrid technology.



PASSPORT HYBRID EXPANDABLE TENT SYSTEM

Our tent system makes setting up and tearing down your hybrid a breeze. You no longer have to worry about awkward support bars or the tent canvas not being properly sealed to the tent door.

AVAILABLE IN 171EXP AND 217EXP FLOOR PLANS

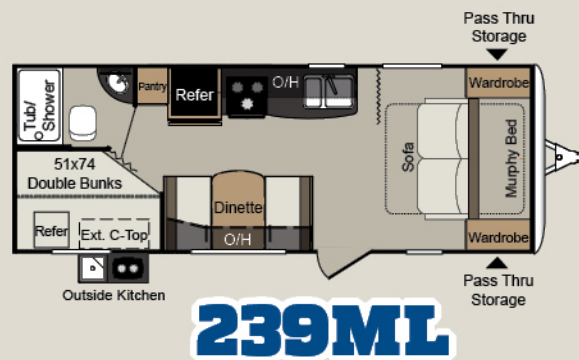
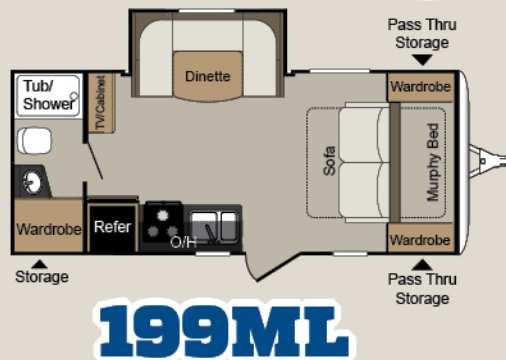
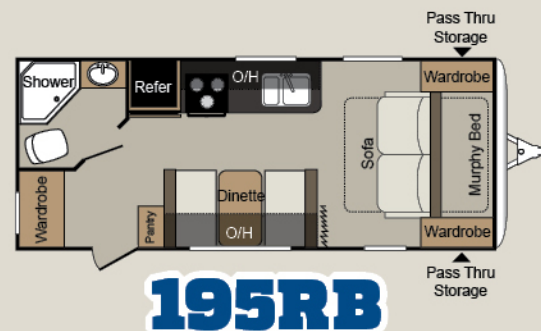
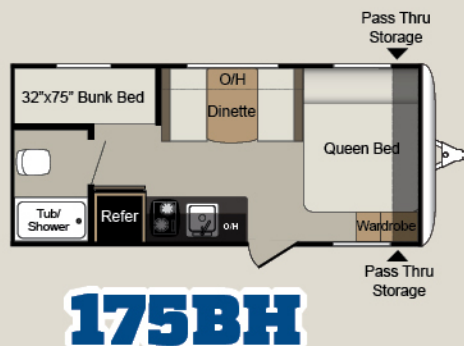
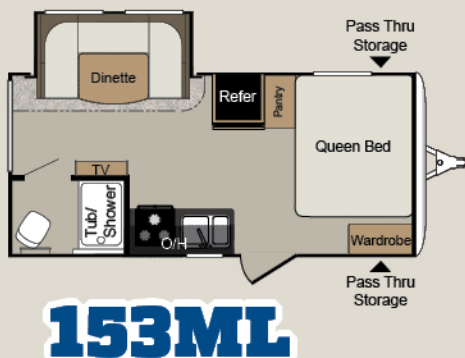
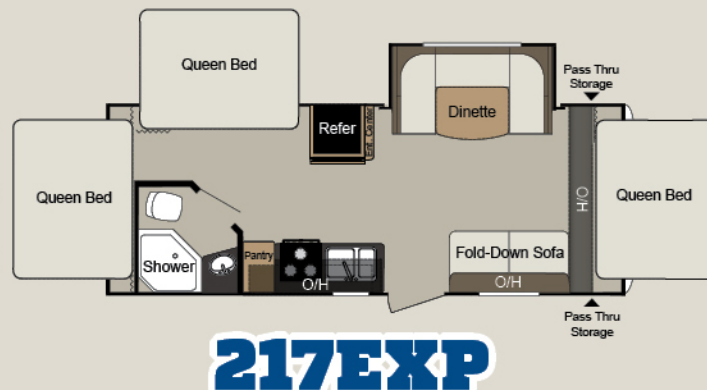
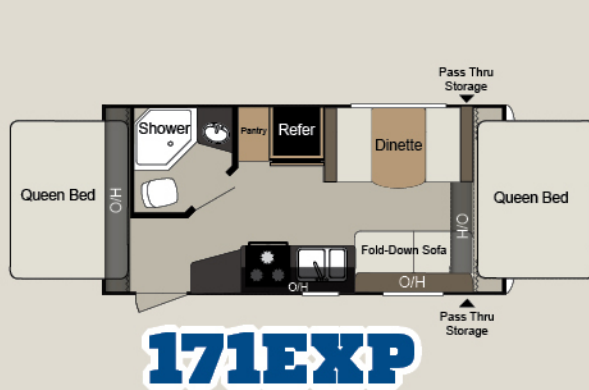

EXPRESS FLOOR PLANS

MODEL	SHIPPING WEIGHT	CARRYING CAPACITY	HITCH	LENGTH	HEIGHT	FRESH WATER	WASTE WATER	GRAY WATER	LPG	AWNING
171EXP	3612	1588	410	20' 2"	10' 1"	43	38	38	40	10'
217EXP	4340	2215	575	24' 11"	10' 1"	43	38	38	40	15'
153ML	3415	1085	415	20' 11"	11'	43	38	38	40	12'
175BH	3160	1340	410	21' 3"	11'	43	38	38	40	10'
195RB	3711	1489	405	23' 4"	10' 1"	43	38	38	40	15'
199ML	3595	1605	385	21' 9"	10' 1"	43	38	38	40	10'
239ML	3970	1430	415	25' 5"	10' 2"	43	38	38	40	15'

GRAND TOURING



One word describes the Passport Grand Touring. Amazing! The Passport Grand Touring didn't get the memo that it was suppose to act like the other lite weights. With size and features of a full size camper, this Passport is still made for today's SUV's and half ton vehicles. So go ahead and live large, go lite, and get more with a Passport Grand Touring.



3350 BH SHOWN IN DRIFTWOOD DECOR

GRAND TOURING



XL FOLDING ENTRY ASSIST HANDLE WITH TRIPLE STEP ENTRY STEPS (GT AND ELITE)



LOAD EQUALIZATION AXLES (GT AND ELITE) WITH STANDARD ALUMINUM WHEELS



GAS/ELECTRIC DSI WATER HEATER FOR LONGER HOT SHOWERS



BUMPER MOUNT GRILL (ON SELECT FLOOR PLANS)



8 GRAND TOURING BUNK MODELS TO CHOOSE FROM (2400BH, 2670BH, 2810BH, 2920BH, 3220BH, 3290BH, 3320BH, 3350BH)

ENTERTAINMENT CENTER WITH DVD PLAYER, AM/FM RADIO, MP3, AUX PORT AND BLUETOOTH

GRAND TOURING



EXTERIOR LIGHTS ALLOW EASY ACCESS TO THE TERMINATION VALVE

TRI-FOLD SOFA (N/A IN 2400BH, 2520RL)

60" X 80" QUEEN SIZE BED (60" X 74" IN 3350BH)

OUTSIDE KITCHEN (AVAILABLE ON 239ML, 2400BH, 2920BH, 3220BH, 3320BH)

**GRILL INCLUDED IN PLACE OF 2 BURNER RANGE*

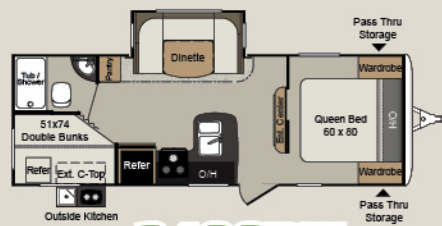

2400BH



2510RB



2520RL

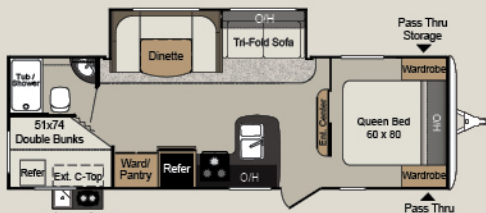

2670BH

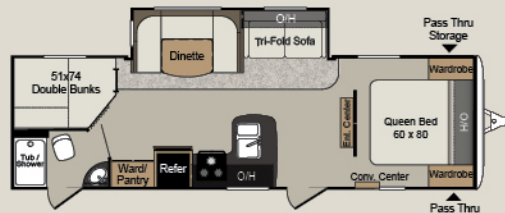

2810BH



2890RL



2900RK



2920BH

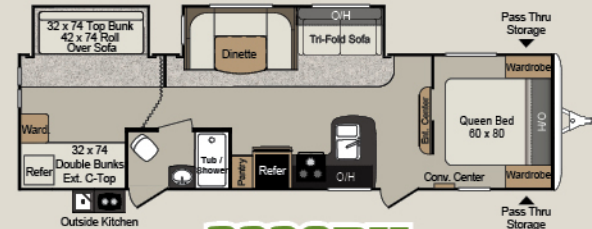

3220BH



3290BH



3320BH



3350BH

GRAND TOURING FLOOR PLANS

MODEL	SHIPPING WEIGHT	CARRYING CAPACITY	HITCH	LENGTH	HEIGHT	FRESH WATER	WASTE WATER	GRAY WATER	LP6	AWNING
2400BH	4801	2199	500	27' 10"	10' 7"	43	30	30	40	15'
2510RB	4880	2120	495	28' 10"	10' 7"	43	38	38	40	19'
2520RL	4930	2070	550	29' 5"	10' 7"	43	38	76	40	20'
2670BH	5085	1915	625	30' 6"	10' 7"	43	38	38	40	19'
2810BH	5165	2035	565	31' 10"	10' 9"	43	38	38	40	19'
2890RL	5500	1700	635	33' 3"	10' 9"	43	38	76	40	19'
2900RK	TBD	TBD	TBD	TBD	TBD	TBD	TBD	TBD	TBD	TBD
2920BH	5443	1757	625	32' 10"	10' 9"	43	38	38	40	15'
3220BH	6096	1404	695	35' 5"	10' 9"	43	38	38	40	15' & 10'
3290BH	6368	1632	825	36' 8"	10' 11"	43	38	38	40	15'
3320BH	6586	1414	690	36' 10"	10' 11"	43	38	76	40	19'
3350BH	6550	2930	680	37' 7"	10' 11"	43	76	76	40	20'

ELITE

by Passport



Taking camping to the next level, Passport has created the ultimate in lightweight luxury! Once inside, you will see why the wide open spaces, all the amenities and high end finishes make this ultra-lite travel trailer Elite indeed.



31RE SHOWN IN RATTAN DECOR



ENTERTAINMENT CENTER TO ENJOY WITH THE WHOLE FAMILY



SOLID SURFACE COUNTERTOP W/DEEP BASIN STAINLESS STEEL SINK WITH PULL OUT SPRAYER



60" X 80" TRI-FOLD QUEEN SIZE HIDE-A-BED

ELITE

by Passport



FIBERGLASS FRONT CAP W/KEYSHIELD ROCK GUARD



31RE SHOWN IN RATTAN DECOR

ELITE



ADJUSTABLE PANTRY SHELVING
(SELECT FLOOR PLANS)



60" X 80" QUEEN SIZE BED
(IN MOST GT AND ELITE FLOOR PLANS)

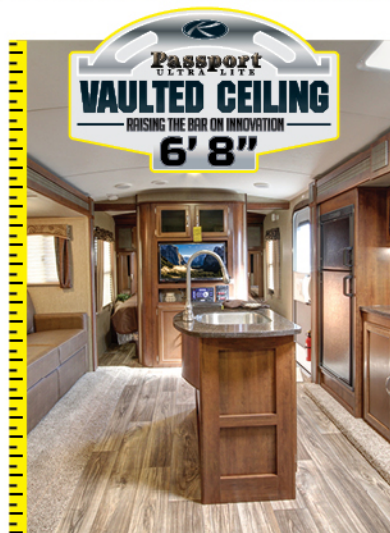

VAULTED CEILING ALLOWS FOR
A 6' 8" CEILING HEIGHT



FRAMELESS TINTED
WINDOWS



POWER TONGUE JACK

ELITE

by Passport

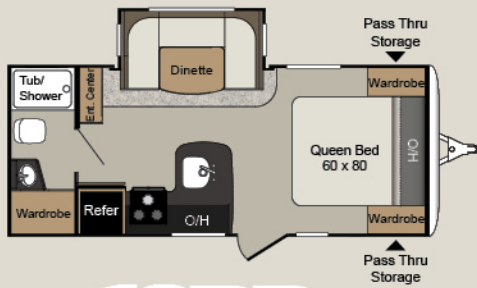
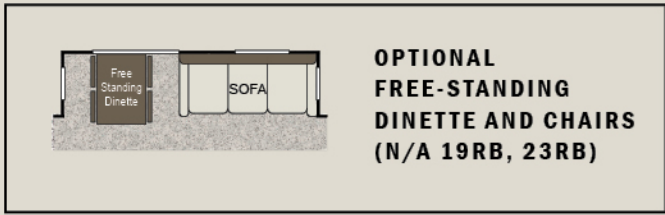

19RB

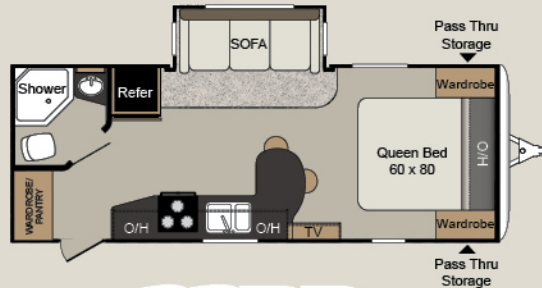

23RB

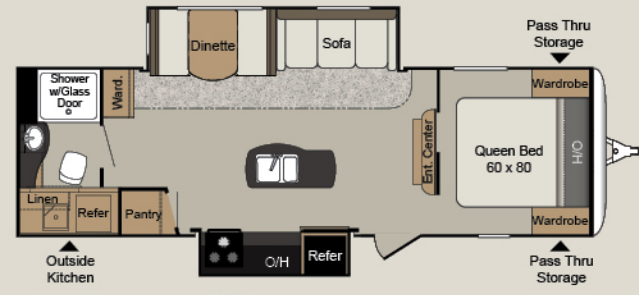

27RB

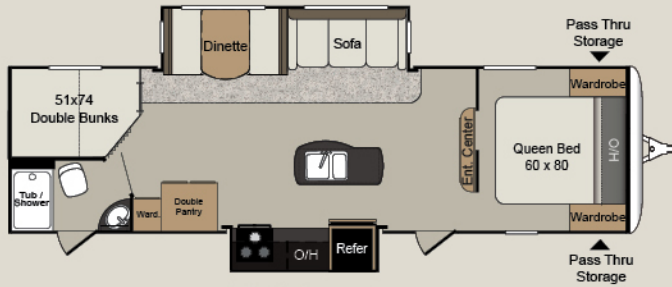

29BH

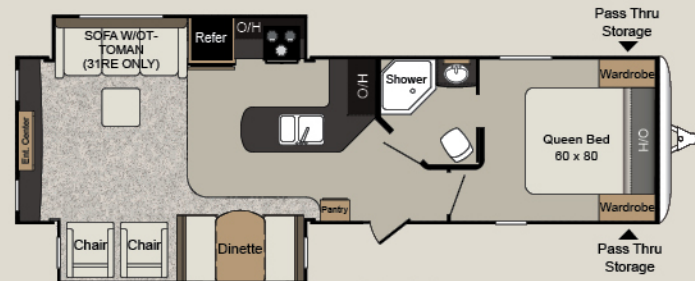

31RE

ELITE FLOOR PLANS

MODEL	SHIPPING WEIGHT	CARRYING CAPACITY	HITCH	LENGTH	HEIGHT	FRESH WATER	WASTE WATER	GRAY WATER	LPG	AWNING
19RB	4280	4520	520	23' 11"	11'	43	38	38	40	15'
23RB	4747	2053	565	26' 3"	11'	43	38	38	40	15'
27RB	5880	1920	750	31' 5"	11'	43	38	76	40	20'
29BH	6070	1730	810	34'	11'	43	38	76	40	19'
31RE	6495	1505	780	35'	11'	43	38	38	40	12'

SPECIFICALLY BUILT FOR THE WEST

EXPRESS AND GT WESTERN EDITION MODELS ARE AVAILABLE



Oregon production gives West Coast buyers an extreme price advantage over products produced in Indiana due to decreased freight costs. The Pendleton, OR plant also enables the Passport team to offer a trailer that is “specifically built for the West”

What do we mean by “specifically built for the West”? The Western Edition Passport is geared to the specific needs of the West, where camping is done year round and primarily without the luxury of full hook ups to sewer, water, and electricity regularly found in campgrounds in the Midwest and the East.

The Western Edition Passport models are generally, smaller, lighter, and carry more robust features such as added insulation, larger holding tank capacities, more interior and exterior storage. We hope that you enjoy our affordable west coast floor plans, added features, and ease of towability with the Western Edition Passport.



195RBWE

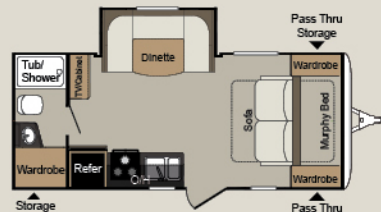

199MLWE

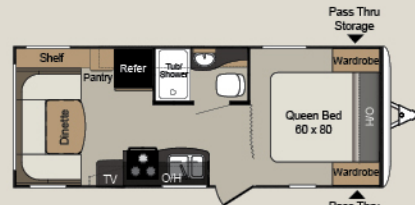

234QBWE

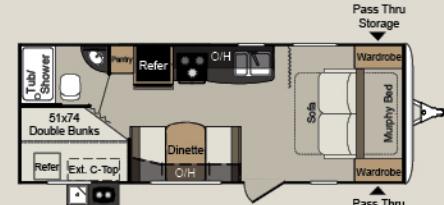

239MLWE

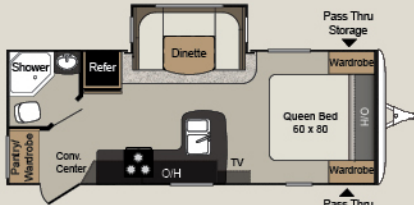

2200RBWE

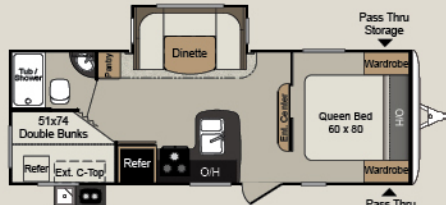

2400BHWE



2450RLWE

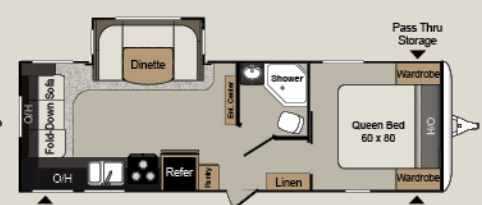

2520RLWE

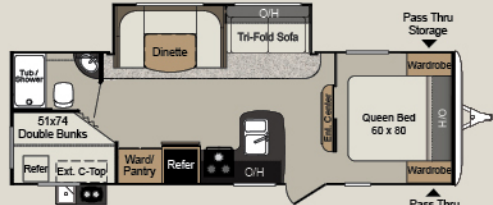

2670BHWE

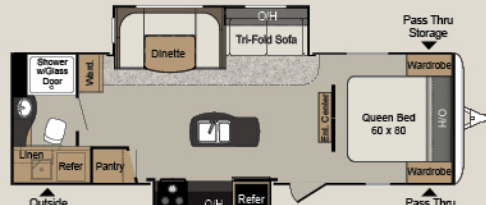

2770RBWE



2810BHWE



2890RLWE

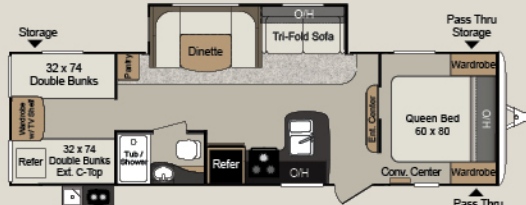

2920BHWE

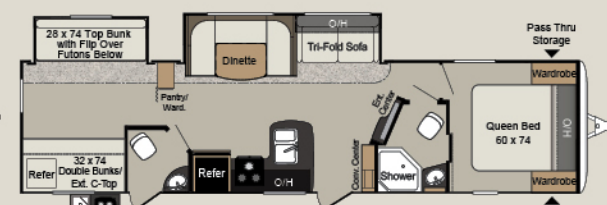

3350BHWE

WESTERN EDITION FLOOR PLANS

MODEL	SHIPPING WEIGHT	CARRYING CAPACITY	HITCH	LENGTH	HEIGHT	FRESH WATER	WASTE WATER	GRAY WATER	LPG	AWNING
195RBWE	3848	2082	418	24' 5"	10' 1"	36	30	30	40	14'
199MLWE	TBD	TBD	TBD	22' 9"	10' 2"	43	30	30	40	12'
234QBWE	3880	2510	390	25' 4"	10' 1"	43	30	30	40	15'
239MLWE	4233	1167	395	25' 5"	10' 2"	43	30	30	40	10'
2200RBWE	4436	2064	538	25' 10"	10' 7"	43	30	30	40	15'
2400BHWE	4801	2199	500	27' 10"	10' 7"	43	30	30	40	19'
2450RLWE	4874	2126	542	28' 7"	10' 7"	43	30	30	40	15'
2520RLWE	4990	2010	616	29' 10"	10' 7"	43	30	60	40	15'
2670BHWE	5274	1726	624	29' 4"	10' 7"	43	30	30	40	19'
2770RBWE	5676	1724	696	30' 9"	10' 7"	43	30	60	40	20'
2810BHWE	5323	1877	550	31' 10"	10' 7"	43	30	30	40	19'
2890RLWE	5738	1462	620	32' 9"	10' 7"	43	30	60	40	19'
2920BHWE	5655	1545	670	32' 10"	10' 9"	43	30	30	40	15'
3350BHWE	6947	2053	740	37' 7"	10' 11"	43	76	76	40	20'

Passport

ULTRA-LITE

PASSPORT CONSTRUCTION

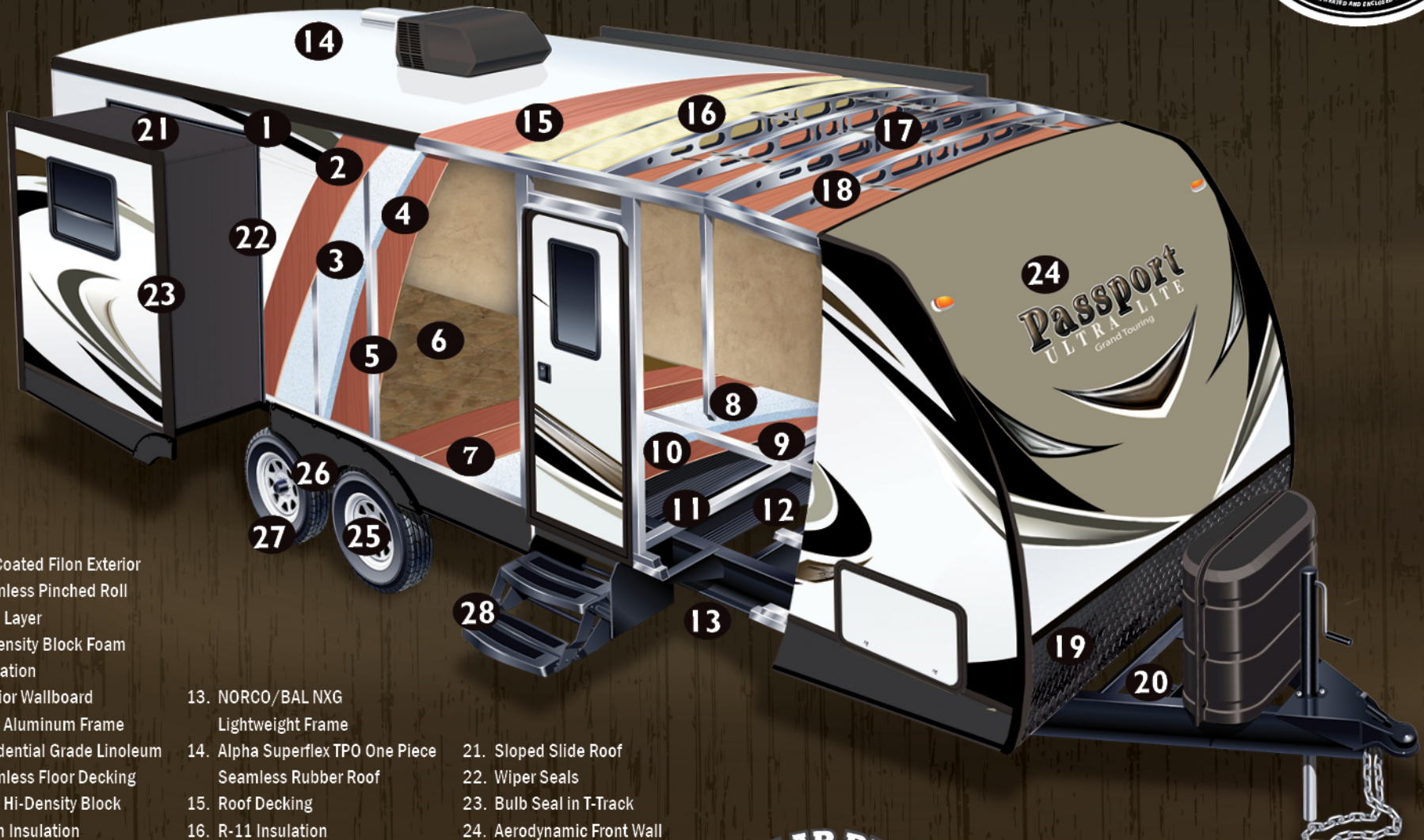

- | | | |
|------------------------------------------|--------------------------------------------------------|-------------------------------------------------|
| 1. Gel Coated Filon Exterior | 13. NORCO/BAL NXG Lightweight Frame | 21. Sloped Slide Roof |
| 2. Seamless Pinched Roll Luan Layer | 14. Alpha Superflex TPO One Piece Seamless Rubber Roof | 22. Wiper Seals |
| 3. Hi-Density Block Foam Insulation | 15. Roof Decking | 23. Bulb Seal in T-Track |
| 4. Interior Wallboard | 16. R-11 Insulation | 24. Aerodynamic Front Wall |
| 5. Total Aluminum Frame | 17. 5" Crowned/Stamped Galvanized Steel Roof Trusses | 25. Easy Lube Axles |
| 6. Residential Grade Linoleum | 18. Hurricane Straps | 26. Load Equalization Axles (GT and Elite only) |
| 7. Seamless Floor Decking | 19. Diamond Plate | 27. Radial Tires |
| 8. R-11 Hi-Density Block Foam Insulation | 20. Dual Battery Tray | 28. Radius Entry Steps |
| 9. Aluminum Floor Studs | | |
| 10. Bottom layer floor decking | | |
| 11. Moisture Barrier Wrap | | |
| 12. Enclosed Underbelly (GT & Elite) | | |



AVAILABLE ON GRAND
TOURING AND ELITE



AVAILABLE ON GRAND
TOURING AND ELITE



	EXPRESS	GT	ELITE
CHASSIS			
Engineered specifically for each floor plan	●	●	●
Tube style bumper w/ sewer hose storage	●	●	●
Fully welded outriggers	●	●	●
Cambered for added structural support	●	●	●
Extra support cross members	●	●	●
Electric slide out system	●	●	●
Enclosed, sealed and heated underbelly	●	●	●
CONSTRUCTION			
Welded aluminum framed sidewalls	●	●	●
Seamless laminated gel-coated filon exterior walls	●	●	●
High density block foam insulation in sidewalls (R-7 insulation)	●	●	●
Laminated aluminum framed floor 2" thick	●	●	●
One piece breathable Darco protective wrap	●	●	●
R-11 high density block floor insulation	●	●	●
Stamped galvanized 5" thick crowned rafters	●	●	●
One piece seamless Alpha Superflex TPO roof	●	●	●
R-11 ceiling rolled fiberglass insulation	●	●	●
EXTERIOR FEATURES			
Insulated lockable radius baggage doors with hold backs	●	●	●
Insulated radius entrance door with screen door	●	●	●
Double entry steps at main door	●	●	●
Triple entry steps at main door	●	●	●
Heavy duty front mechanical jack	●	●	●
4 scissor style stabilizer jacks	●	●	●
2-20lb. Propane bottles with flip top cover	●	●	●
Dual battery rack over A-frame	●	●	●
Rain gutters with extended downspouts	●	●	●
Electric adjustable awning	●	●	●
Lighted exterior pass thru storage compartment	●	●	●
Portable outside grill (Select models. Not all outdoor kitchen models)	●	●	●
Patio entrance light	●	●	●
Exterior shower w/ hot & cold	●	●	●
Front diamond plate	●	●	●
Molded fiberglass front cap w/KeyShield Rock Guard	●	●	●
Fold away exterior grab handle (main door)	●	●	●
Load Equalization (spread axle design)	●	●	●
EZ lube axles	●	●	●
Exterior speakers	●	●	●
Exterior light at dump valves	●	●	●
15" aluminum wheels	●	●	●
15" radial tires	●	●	●
Frameless windows	●	●	●
Upgraded graphics package	●	●	●
Electric power tongue jack	●	●	●
LED awning lights	●	●	●

	EXPRESS	GT	ELITE
EXTERIOR FEATURES (CONTINUED)			
Black tank flush	●	●	●
Satellite prep	●	●	●
Solar prep	●	●	●
Backup camera prep	●	●	●
INTERIOR FEATURES			
Residential style furniture with high grade fabric	●	●	●
Convenience center with slide, lights, awning, water system controls, and 110V receptacle	●	●	●
13,500 BTU A/C standard	●	●	●
30,000 BTU furnace	●	●	●
Ducted in floor heating	●	●	●
6 gallon gas/electric DSI water heater (17.8 gal/hr)	●	●	●
Water system winterization ready	●	●	●
Residential durable Armstrong linoleum	●	●	●
12 volt DVD/CD/AM/FM stereo, AUX input, bluetooth and quality sound speakers	●	●	●
LED flat screen HD TV standard	●	●	●
Residential light fixtures in slide room	●	●	●
Upgraded residential window treatments and valences	●	●	●
Residential style entertainment center with integrated pocket doors	●	●	●
Residential interior doors	●	●	●
Upgraded leather furniture w/tri-fold sofa	●	●	●
LED interior lights	●	●	●
Vaulted ceiling	●	●	●
USB charging ports	●	●	●
KITCHEN			
6 cu. ft. double door RV refrigerator	●	●	●
Oversized 60/40 residential sink with sink covers	●	●	●
Metal high-rise faucet	●	●	●
Microwave with carousel	●	●	●
3-burner high output range	●	●	●
Range hood	●	●	●
Residential raised panel hardwood cabinet doors	●	●	●
Gas Oven (N/A 153ML, 175BH)	●	●	●
Solid surface countertop	●	●	●
Stainless steel sink w/pull-down faucet	●	●	●

	EXPRESS	GT	ELITE
BEDROOM (MAIN)			
60"x80" Queen size bed with quilted bedspread	●	●	●
60"x74" Queen size bed	●	●	●
Oversized wardrobes	●	●	●
Nighttime reading lights	●	●	●
Under bed storage	●	●	●
Power outlet at bed side	●	●	●
BATHROOM			
Solid wood custom built medicine cabinet with mirror	●	●	●
Tub surround with built-in shelves	●	●	●
Radius shower curtain	●	●	●
Pedestal foot flush toilet	●	●	●
12 volt power exhaust fan	●	●	●
SAFETY PACKAGE			
4 wheel electric brakes	●	●	●
Break-away switch	●	●	●
Heavy duty safety chains with clasp	●	●	●
Tinted safety glass windows	●	●	●
Multiple emergency egress windows	●	●	●
GFI receptacles	●	●	●
Carbon monoxide detector	●	●	●
Smoke alarm	●	●	●
Fire extinguisher	●	●	●
Propane gas leak detector	●	●	●
Dead-bolt lock on entrance doors	●	●	●
Manual override on slide system	●	●	●
Spare tire kit	●	●	●
OPTIONS			
15,000 BTU A/C	●	●	●
Aluminum Wheels	●	●	●
Free-standing dinette and chairs (N/A 23RB)	●	●	●
50 AMP 2nd A/C Prep (Models that are 35' & longer only)	●	●	●



STANDARDS AND OPTIONS



GRANITE DECOR

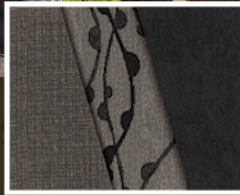

DRIFTWOOD DECOR



RATTAN DECOR

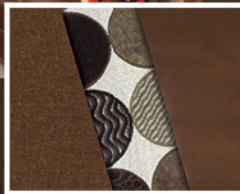

STAY IN TOUCH



Passport is always just a touch away. You'll find 360 virtual tours, location of your nearest dealer, photos, videos and all of the latest information about Passport on our easy to navigate website. Everything you need can be accessed anytime, day or night, from home or on the road. You can also find us on the Keystone RV facebook.

www.keystonerv.com/Passport
www.keystonerv.com/Passport-Elite



KEYSTONE RV RECOMMENDS BUYING LOCALLY

It's up to you where you purchase your new Passport, but may we suggest your local dealer? Not only does it help your local economy and provide jobs, but it will also give you an opportunity to develop a service relationship with someone that will come to know you and your coach. Congratulations on finding the best built, best equipped, best value in the industry, and happy travels!

YOUR LOCAL DEALER:

FEBRUARY 2017

Product information is as accurate as possible at the date of publication of this brochure. Features, floor plans, and specifications are subject to change without notice. Please also consult Keystone's web site at keystonerv.com for more current product information and specifications. Tow Vehicle Disclaimer. CAUTION: Owners of Keystone recreational vehicles are solely responsible for the selection and proper use of tow vehicles. All customers should consult with a motor vehicle manufacturer or their dealer concerning the purchase and use of suitable tow vehicles for Keystone products. Keystone disclaims any liability or damages suffered as a result of the selection, operation, use or misuse of a tow vehicle. KEYSTONE'S LIMITED WARRANTY DOES NOT COVER DAMAGE TO THE RECREATIONAL VEHICLE OR THE TOW VEHICLE AS A RESULT OF THE SELECTION, OPERATION, USE OR MISUSE OF THE TOW VEHICLE. *Length is defined as the distance from the centerline to the hitch pin/coupler to rear bumper of the trailer.

Go RVing
Life's A Trip!



2642 Hackberry Drive | PO Box 2000
Goshen, IN 46527-2000
(574) 535-2100



Passport

ULTRA LITE

